

C1302

Základna šikmého vyhazovače

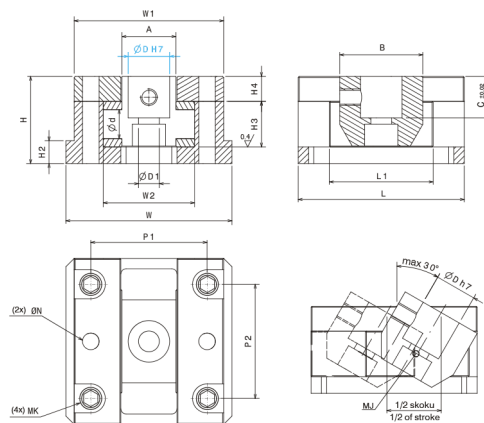

kód	D	d	D1	A	B	C	MJ	H	H2	H3	L	L1	W	W1	W2	P1	P2	MK
C1302/8	8	7	4,5	11	20	8	M4	22	5	11	32	20	33	30	19	24	20	M3
C1302/10	10	7	5,5	15	25	10	M5	27	5	15	45	25	45	40	25	32	30	M4
C1302/12	12	10	7	17	25	12	M6	32	7	16	50	30	57	51	31	39	35	M5
C1302/16	16	12	9	22	30	16	M6	36	8	20	65	40	65	58	38	46	40	M6
C1302/20	20	14	11	26	40	20	M10	42	11	22	80	50	80	72	44	56	55	M8
C1302/25	25	16	14	32	45	25	M12	50	15	26	90	55	93	85	52	66	65	M10
C1302/30	30	18	14	38	50	30	M12	55	15	30	100	60	101	93	60	74	70	M10
C1302/35	35	20	14	45	60	35	M12	62	15	34	120	75	120	110	70	85	80	M12
C1302/40	40	25	18	55	70	40	M16	70	15	44	135	85	130	120	80	95	90	M12
C1302/45	45	30	18	60	80	45	M16	80	15	50	150	95	140	130	90	105	110	M12