

# C1010

## Vyhazovač osazený kalený

**Materiál:** WS (~1.2210), 60±2 HRC

**Povrchová úprava:** Kaleno

**Norma:** DIN 1530, tvar CH

Další velikosti vyhazovačů nebo výrobu z různých materiálů nabízíme na poptání.

Na přání zajistíme také povlakování (DLC, TiN, TiCN, TiAlN, CrN, AlCrN a mnoho dalších).

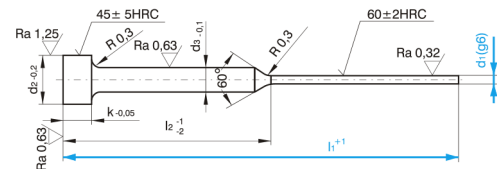

| kód              | d1  | l1  | l2 | d2 | d3 | k |
|------------------|-----|-----|----|----|----|---|
| C1010/0,8x80-35  | 0,8 | 80  | 35 | 4  | 2  | 2 |
| C1010/0,8x100-50 | 0,8 | 100 | 50 | 4  | 2  | 2 |
| C1010/0,8x125-50 | 0,8 | 125 | 50 | 4  | 2  | 2 |
| C1010/0,8x160-75 | 0,8 | 160 | 75 | 4  | 2  | 2 |
| C1010/0,9x80-35  | 0,9 | 80  | 35 | 4  | 2  | 2 |
| C1010/0,9x100-50 | 0,9 | 100 | 50 | 4  | 2  | 2 |
| C1010/0,9x125-50 | 0,9 | 125 | 50 | 4  | 2  | 2 |
| C1010/0,9x160-75 | 0,9 | 160 | 75 | 4  | 2  | 2 |
| C1010/1x80-35    | 1   | 80  | 35 | 4  | 2  | 2 |
| C1010/1x100-50   | 1   | 100 | 50 | 4  | 2  | 2 |
| C1010/1x125-50   | 1   | 125 | 50 | 4  | 2  | 2 |
| C1010/1x160-75   | 1   | 160 | 75 | 4  | 2  | 2 |
| C1010/1,1x80-35  | 1,1 | 80  | 35 | 4  | 2  | 2 |
| C1010/1,1x100-50 | 1,1 | 100 | 50 | 4  | 2  | 2 |
| C1010/1,1x125-50 | 1,1 | 125 | 50 | 4  | 2  | 2 |
| C1010/1,1x160-75 | 1,1 | 160 | 75 | 4  | 2  | 2 |
| C1010/1,2x80-35  | 1,2 | 80  | 35 | 4  | 2  | 2 |
| C1010/1,2x100-50 | 1,2 | 100 | 50 | 4  | 2  | 2 |
| C1010/1,2x125-50 | 1,2 | 125 | 50 | 4  | 2  | 2 |
| C1010/1,2x160-75 | 1,2 | 160 | 75 | 4  | 2  | 2 |
| C1010/1,3x80-35  | 1,3 | 80  | 35 | 4  | 2  | 2 |
| C1010/1,3x100-50 | 1,3 | 100 | 50 | 4  | 2  | 2 |
| C1010/1,3x125-50 | 1,3 | 125 | 50 | 4  | 2  | 2 |
| C1010/1,3x160-75 | 1,3 | 160 | 75 | 4  | 2  | 2 |
| C1010/1,4x80-35  | 1,4 | 80  | 35 | 4  | 2  | 2 |
| C1010/1,4x100-50 | 1,4 | 100 | 50 | 4  | 2  | 2 |

| kód              | d1  | l1  | l2 | d2 | d3 | k |
|------------------|-----|-----|----|----|----|---|
| C1010/1,4x125-50 | 1,4 | 125 | 50 | 4  | 2  | 2 |
| C1010/1,4x160-75 | 1,4 | 160 | 75 | 4  | 2  | 2 |
| C1010/1,5x80-35  | 1,5 | 80  | 35 | 6  | 3  | 3 |
| C1010/1,5x100-50 | 1,5 | 100 | 50 | 6  | 3  | 3 |
| C1010/1,5x125-50 | 1,5 | 125 | 50 | 6  | 3  | 3 |
| C1010/1,5x160-75 | 1,5 | 160 | 75 | 6  | 3  | 3 |
| C1010/1,5x200-75 | 1,5 | 200 | 75 | 6  | 3  | 3 |
| C1010/1,6x80-35  | 1,6 | 80  | 35 | 6  | 3  | 3 |
| C1010/1,6x100-50 | 1,6 | 100 | 50 | 6  | 3  | 3 |
| C1010/1,6x125-50 | 1,6 | 125 | 50 | 6  | 3  | 3 |
| C1010/1,6x160-75 | 1,6 | 160 | 75 | 6  | 3  | 3 |
| C1010/1,6x200-75 | 1,6 | 200 | 75 | 6  | 3  | 3 |
| C1010/1,7x80-35  | 1,7 | 80  | 35 | 6  | 3  | 3 |
| C1010/1,7x100-50 | 1,7 | 100 | 50 | 6  | 3  | 3 |
| C1010/1,7x125-50 | 1,7 | 125 | 50 | 6  | 3  | 3 |
| C1010/1,7x160-75 | 1,7 | 160 | 75 | 6  | 3  | 3 |
| C1010/1,7x200-75 | 1,7 | 200 | 75 | 6  | 3  | 3 |
| C1010/1,8x80-35  | 1,8 | 80  | 35 | 6  | 3  | 3 |
| C1010/1,8x100-50 | 1,8 | 100 | 50 | 6  | 3  | 3 |
| C1010/1,8x125-50 | 1,8 | 125 | 50 | 6  | 3  | 3 |
| C1010/1,8x160-75 | 1,8 | 160 | 75 | 6  | 3  | 3 |
| C1010/1,8x200-75 | 1,8 | 200 | 75 | 6  | 3  | 3 |
| C1010/1,9x80-35  | 1,9 | 80  | 35 | 6  | 3  | 3 |
| C1010/1,9x100-50 | 1,9 | 100 | 50 | 6  | 3  | 3 |
| C1010/1,9x125-50 | 1,9 | 125 | 50 | 6  | 3  | 3 |
| C1010/1,9x160-75 | 1,9 | 160 | 75 | 6  | 3  | 3 |
| C1010/1,9x200-75 | 1,9 | 200 | 75 | 6  | 3  | 3 |
| C1010/2x80-35    | 2   | 80  | 35 | 6  | 3  | 3 |
| C1010/2x100-50   | 2   | 100 | 50 | 6  | 3  | 3 |
| C1010/2x125-50   | 2   | 125 | 50 | 6  | 3  | 3 |
| C1010/2x160-75   | 2   | 160 | 75 | 6  | 3  | 3 |
| C1010/2x200-75   | 2   | 200 | 75 | 6  | 3  | 3 |
| C1010/2,1x80-35  | 2,1 | 80  | 35 | 6  | 3  | 3 |
| C1010/2,1x100-50 | 2,1 | 100 | 50 | 6  | 3  | 3 |
| C1010/2,1x125-50 | 2,1 | 125 | 50 | 6  | 3  | 3 |
| C1010/2,1x160-75 | 2,1 | 160 | 75 | 6  | 3  | 3 |
| C1010/2,1x200-75 | 2,1 | 200 | 75 | 6  | 3  | 3 |
| C1010/2,2x80-35  | 2,2 | 80  | 35 | 6  | 3  | 3 |
| C1010/2,2x100-50 | 2,2 | 100 | 50 | 6  | 3  | 3 |
| C1010/2,2x125-50 | 2,2 | 125 | 50 | 6  | 3  | 3 |
| C1010/2,2x160-75 | 2,2 | 160 | 75 | 6  | 3  | 3 |

| kód              | d1  | l1  | l2 | d2 | d3 | k |
|------------------|-----|-----|----|----|----|---|
| C1010/2,2x200-75 | 2,2 | 200 | 75 | 6  | 3  | 3 |
| C1010/2,3x80-35  | 2,3 | 80  | 35 | 6  | 3  | 3 |
| C1010/2,3x100-50 | 2,3 | 100 | 50 | 6  | 3  | 3 |
| C1010/2,3x125-50 | 2,3 | 125 | 50 | 6  | 3  | 3 |
| C1010/2,3x160-75 | 2,3 | 160 | 75 | 6  | 3  | 3 |
| C1010/2,3x200-75 | 2,3 | 200 | 75 | 6  | 3  | 3 |
| C1010/2,4x80-35  | 2,4 | 80  | 35 | 6  | 3  | 3 |
| C1010/2,4x100-50 | 2,4 | 100 | 50 | 6  | 3  | 3 |
| C1010/2,4x125-50 | 2,4 | 125 | 50 | 6  | 3  | 3 |
| C1010/2,4x160-75 | 2,4 | 160 | 75 | 6  | 3  | 3 |
| C1010/2,4x200-75 | 2,4 | 200 | 75 | 6  | 3  | 3 |
| C1010/2,5x100-50 | 2,5 | 100 | 50 | 6  | 3  | 3 |
| C1010/2,5x125-50 | 2,5 | 125 | 50 | 6  | 3  | 3 |
| C1010/2,5x160-75 | 2,5 | 160 | 75 | 6  | 3  | 3 |
| C1010/2,5x200-75 | 2,5 | 200 | 75 | 6  | 3  | 3 |
| C1010/2,6x100-50 | 2,6 | 100 | 50 | 6  | 3  | 3 |
| C1010/2,6x125-50 | 2,6 | 125 | 50 | 6  | 3  | 3 |
| C1010/2,6x160-75 | 2,6 | 160 | 75 | 6  | 3  | 3 |
| C1010/2,6x200-75 | 2,6 | 200 | 75 | 6  | 3  | 3 |
| C1010/2,7x100-50 | 2,7 | 100 | 50 | 6  | 3  | 3 |
| C1010/2,7x125-50 | 2,7 | 125 | 50 | 6  | 3  | 3 |
| C1010/2,7x160-75 | 2,7 | 160 | 75 | 6  | 3  | 3 |
| C1010/2,7x200-75 | 2,7 | 200 | 75 | 6  | 3  | 3 |
| C1010/2,8x100-50 | 2,8 | 100 | 50 | 6  | 3  | 3 |
| C1010/2,8x125-50 | 2,8 | 125 | 50 | 6  | 3  | 3 |
| C1010/2,8x160-75 | 2,8 | 160 | 75 | 6  | 3  | 3 |
| C1010/2,8x200-75 | 2,8 | 200 | 75 | 6  | 3  | 3 |
| C1010/2,9x100-50 | 2,9 | 100 | 50 | 6  | 3  | 3 |
| C1010/2,9x125-50 | 2,9 | 125 | 50 | 6  | 3  | 3 |
| C1010/2,9x160-75 | 2,9 | 160 | 75 | 6  | 3  | 3 |
| C1010/2,9x200-75 | 2,9 | 200 | 75 | 6  | 3  | 3 |