

C1203

Vodící pouzdro se středícím nákuřkem, samomazné

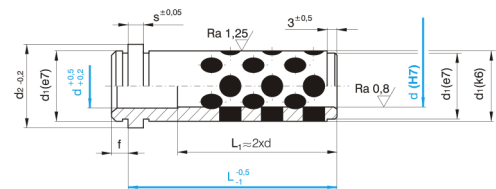

Materiál: ~2.0598 + grafit



kód	d	L	d1	d2	s	f
C1203/9x12	9	12	14	16	3	5
C1203/9x17	9	17	14	16	3	5
C1203/9x22	9	22	14	16	3	5
C1203/9x27	9	27	14	16	3	5
C1203/9x36	9	36	14	16	3	5
C1203/9x46	9	46	14	16	3	5
C1203/9x56	9	56	14	16	3	5
C1203/10x12	10	12	14	16	3	5
C1203/10x17	10	17	14	16	3	5
C1203/10x22	10	22	14	16	3	5
C1203/10x27	10	27	14	16	3	5
C1203/10x36	10	36	14	16	3	5
C1203/10x46	10	46	14	16	3	5
C1203/10x56	10	56	14	16	3	5
C1203/14x17	14	17	20	25	6	6
C1203/14x22	14	22	20	25	6	6
C1203/14x27	14	27	20	25	6	6
C1203/14x36	14	36	20	25	6	6
C1203/14x46	14	46	20	25	6	6
C1203/14x56	14	56	20	25	6	6
C1203/14x66	14	66	20	25	6	6
C1203/14x76	14	76	20	25	6	6
C1203/14x86	14	86	20	25	6	6
C1203/15x17	15	17	20	25	6	6
C1203/15x22	15	22	20	25	6	6
C1203/15x27	15	27	20	25	6	6

kód	d	L	d1	d2	s	f
C1203/15x36	15	36	20	25	6	6
C1203/15x46	15	46	20	25	6	6
C1203/15x56	15	56	20	25	6	6
C1203/15x66	15	66	20	25	6	6
C1203/15x76	15	76	20	25	6	6
C1203/15x86	15	86	20	25	6	6
C1203/18x17	18	17	26	31	6	8
C1203/18x22	18	22	26	31	6	8
C1203/18x27	18	27	26	31	6	8
C1203/18x36	18	36	26	31	6	8
C1203/18x46	18	46	26	31	6	8
C1203/18x56	18	56	26	31	6	8
C1203/18x66	18	66	26	31	6	8
C1203/18x76	18	76	26	31	6	8
C1203/18x86	18	86	26	31	6	8
C1203/18x96	18	96	26	31	6	8
C1203/20x17	20	17	26	31	6	8
C1203/20x22	20	22	26	31	6	8
C1203/20x27	20	27	26	31	6	8
C1203/20x36	20	36	26	31	6	8
C1203/20x46	20	46	26	31	6	8
C1203/20x56	20	56	26	31	6	8
C1203/20x66	20	66	26	31	6	8
C1203/20x76	20	76	26	31	6	8
C1203/20x86	20	86	26	31	6	8
C1203/20x96	20	96	26	31	6	8
C1203/22x22	22	22	30	35	6	8
C1203/22x27	22	27	30	35	6	8
C1203/22x36	22	36	30	35	6	8
C1203/22x46	22	46	30	35	6	8
C1203/22x56	22	56	30	35	6	8
C1203/22x66	22	66	30	35	6	8
C1203/22x76	22	76	30	35	6	8
C1203/22x86	22	86	30	35	6	8
C1203/22x96	22	96	30	35	6	8
C1203/22x116	22	116	30	35	6	8
C1203/22x136	22	136	30	35	6	8
C1203/24x22	24	22	30	35	6	8
C1203/24x27	24	27	30	35	6	8
C1203/24x36	24	36	30	35	6	8
C1203/24x46	24	46	30	35	6	8

kód	d	L	d1	d2	s	f
C1203/24x56	24	56	30	35	6	8
C1203/24x66	24	66	30	35	6	8
C1203/24x76	24	76	30	35	6	8
C1203/24x86	24	86	30	35	6	8
C1203/24x96	24	96	30	35	6	8
C1203/24x116	24	116	30	35	6	8
C1203/24x136	24	136	30	35	6	8
C1203/30x27	30	27	42	47	6	8
C1203/30x36	30	36	42	47	6	8
C1203/30x46	30	46	42	47	6	8
C1203/30x56	30	56	42	47	6	8
C1203/30x66	30	66	42	47	6	8
C1203/30x76	30	76	42	47	6	8
C1203/30x86	30	86	42	47	6	8
C1203/30x96	30	96	42	47	6	8
C1203/30x116	30	116	42	47	6	8
C1203/30x136	30	136	42	47	6	8
C1203/32x27	32	27	42	47	6	8
C1203/32x36	32	36	42	47	6	8
C1203/32x46	32	46	42	47	6	8
C1203/32x56	32	56	42	47	6	8
C1203/32x66	32	66	42	47	6	8
C1203/32x76	32	76	42	47	6	8
C1203/32x86	32	86	42	47	6	8
C1203/32x96	32	96	42	47	6	8
C1203/32x116	32	116	42	47	6	8
C1203/32x136	32	136	42	47	6	8
C1203/40x46	40	46	54	60	10	10
C1203/40x56	40	56	54	60	10	10
C1203/40x66	40	66	54	60	10	10
C1203/40x76	40	76	54	60	10	10
C1203/40x86	40	86	54	60	10	10
C1203/40x96	40	96	54	60	10	10
C1203/40x116	40	116	54	60	10	10
C1203/40x136	40	136	54	60	10	10
C1203/40x156	40	156	54	60	10	10
C1203/40x196	40	196	54	60	10	10
C1203/42x46	42	46	54	60	10	10
C1203/42x56	42	56	54	60	10	10
C1203/42x66	42	66	54	60	10	10
C1203/42x76	42	76	54	60	10	10

kód	d	L	d1	d2	s	f
C1203/42x86	42	86	54	60	10	10
C1203/42x96	42	96	54	60	10	10
C1203/42x116	42	116	54	60	10	10
C1203/42x136	42	136	54	60	10	10
C1203/42x156	42	156	54	60	10	10
C1203/42x196	42	196	54	60	10	10