

C4301_90

Rychlospojka s trnem pro nástrčnou hadici, 90°

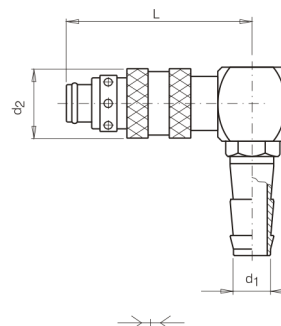
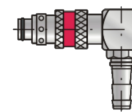

kód	velikost	d1	d2	L	uzavírací ventil
C4301-V/8-10-90	8	10	20	64	ano
C4301-V/8-13-90	8	13	20	64	ano
C4301-V/12-13-90	12	13	28	70	ano
C4301-V/12-16-90	12	16	28	70	ano
C4301/8-10-90	8	10	20	45,5	ne
C4301/8-13-90	8	13	20	45,5	ne
C4301/12-13-90	12	13	28	54	ne
C4301/12-16-90	12	16	28	54	ne