

C4100_90

Rychlospojka s trnem pro hadici, 90°

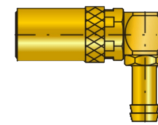

Materiál: Mosaz

O-kroužek: Viton

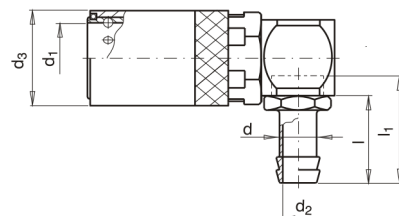

With valve



Without valve



kód	d1	d	d2	d3	l	l1	uzavírací ventil
C4100-V/9-6-90	9,4	6	4	17	27	34	ano
C4100/9-6-90	9,4	6	4	17	27	34	ne
C4100-V/9-8-90	9,4	8	6	17	27	34	ano
C4100/9-8-90	9,4	8	6	17	27	34	ne
C4100-V/9-9-90	9,4	9	7	17	27	34	ano
C4100/9-9-90	9,4	9	7	17	27	34	ne
C4100-V/9-10-90	9,4	10	8	17	27	34	ano
C4100/9-10-90	9,4	10	8	17	27	34	ne
C4100-V/13-10-90	13,5	10	8	23	29	39	ano
C4100/13-10-90	13,5	10	8	23	29	39	ne
C4100-V/13-11-90	13,5	11	9	23	29	39	ano
C4100/13-11-90	13,5	11	9	23	29	39	ne
C4100-V/13-13-90	13,5	13	10	23	29	39	ano
C4100/13-13-90	13,5	13	10	23	29	39	ne
C4100-V/20-13-90	19,9	13	10	32	36	51	ano
C4100/20-13-90	19,9	13	10	32	36	51	ne
C4100-V/20-19-90	19,9	19	16	32	36	51	ano
C4100/20-19-90	19,9	19	16	32	36	51	ne