

C1260

Centrovací pouzdro

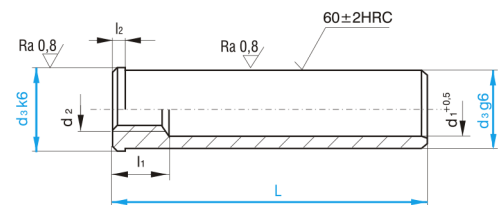

Materiál: 1.7131, 60±2 HRC
Povrchová úprava: Cementováno, kaleno



kód	d3	L	d1	l1	l2	d2
C1260/14x20	14	20	11	8	2	M6
C1260/14x30	14	30	11	8	2	M6
C1260/14x40	14	40	11	8	2	M6
C1260/14x50	14	50	11	8	2	M6
C1260/14x60	14	60	11	8	2	M6
C1260/14x70	14	70	11	8	2	M6
C1260/14x80	14	80	11	8	2	M6
C1260/14x100	14	100	11	8	2	M6
C1260/20x30	20	30	16	13	2	M8
C1260/20x40	20	40	16	13	2	M8
C1260/20x60	20	60	16	13	2	M8
C1260/20x80	20	80	16	13	2	M8
C1260/20x100	20	100	16	13	2	M8
C1260/20x120	20	120	16	13	2	M8
C1260/20x140	20	140	16	13	2	M8
C1260/20x160	20	160	16	13	2	M8
C1260/26x30	26	30	21	13	2,5	M10
C1260/26x40	26	40	21	13	2,5	M10
C1260/26x60	26	60	21	13	2,5	M10
C1260/26x80	26	80	21	13	2,5	M10
C1260/26x100	26	100	21	13	2,5	M10
C1260/26x120	26	120	21	13	2,5	M10
C1260/26x140	26	140	21	13	2,5	M10
C1260/26x160	26	160	21	13	2,5	M10
C1260/26x180	26	180	21	13	2,5	M10
C1260/30x40	30	40	25	13	2,5	M12

kód	d3	L	d1	l1	l2	d2
C1260/30x60	30	60	25	13	2,5	M12
C1260/30x80	30	80	25	13	2,5	M12
C1260/30x100	30	100	25	13	2,5	M12
C1260/30x120	30	120	25	13	2,5	M12
C1260/30x140	30	140	25	13	2,5	M12
C1260/30x160	30	160	25	13	2,5	M12
C1260/30x180	30	180	25	13	2,5	M12
C1260/30x200	30	200	25	13	2,5	M12
C1260/30x240	30	240	25	13	2,5	M12
C1260/42x40	42	40	33	13	4,5	M16
C1260/42x60	42	60	33	13	4,5	M16
C1260/42x80	42	80	33	13	4,5	M16
C1260/42x100	42	100	33	13	4,5	M16
C1260/42x120	42	120	33	13	4,5	M16
C1260/42x140	42	140	33	13	4,5	M16
C1260/42x160	42	160	33	13	4,5	M16
C1260/42x180	42	180	33	13	4,5	M16
C1260/42x200	42	200	33	13	4,5	M16
C1260/42x220	42	220	33	13	4,5	M16
C1260/42x260	42	260	33	13	4,5	M16
C1260/42x300	42	300	33	13	4,5	M16
C1260/54x60	54	60	43	13	4,5	M20
C1260/54x80	54	80	43	13	4,5	M20
C1260/54x120	54	120	43	13	4,5	M20
C1260/54x160	54	160	43	13	4,5	M20
C1260/54x200	54	200	43	13	4,5	M20
C1260/54x240	54	240	43	13	4,5	M20
C1260/54x280	54	280	43	13	4,5	M20
C1260/66x80	66	80	54	26	4,5	M12
C1260/66x120	66	120	54	26	4,5	M12
C1260/66x160	66	160	54	26	4,5	M12
C1260/66x180	66	180	54	26	4,5	M12
C1260/66x200	66	200	54	26	4,5	M12
C1260/66x220	66	220	54	26	4,5	M12
C1260/66x240	66	240	54	26	4,5	M12
C1260/66x260	66	260	54	26	4,5	M12
C1260/66x280	66	280	54	26	4,5	M12
C1260/66x300	66	300	54	26	4,5	M12
C1260/66x320	66	320	54	26	4,5	M12
C1260/66x340	66	340	54	26	4,5	M12
C1260/66x360	66	360	54	26	4,5	M12

kód	d3	L	d1	l1	l2	d2
C1260/66x380	66	380	54	26	4,5	M12