

Dimensions and tolerances  
Wymiary i tolerancje  
Abmessungen und Toleranzen  
Размеры и допуски



|            | A   | B   | C   |
|------------|-----|-----|-----|
| <b>PK</b>  | 792 | 674 | 492 |
| <b>PKA</b> | 808 | 690 | 508 |

**PK 01**  
**PKA 01**



**PK 11**  
**PKA 11**

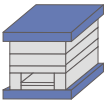

|        | W   |
|--------|-----|
| PK 11  | 696 |
| PKA 11 | 646 |

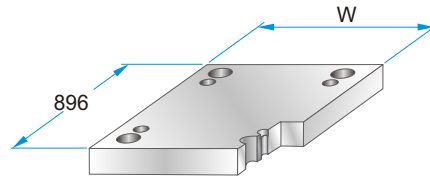

| PK 11 - 596 x 896 x h / | material |
|-------------------------|----------|
| PKA 11-596 x 896 x h /  |          |
| 46                      | 1730     |
| 56                      | 2312     |
|                         | 2085     |

**PK 02**  
**PKA 02**



**PK 12**  
**PKA 12**

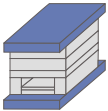

**PK 21**  
**PKA 21**



**PK 22**  
**PKA 22**

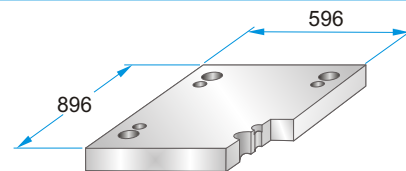

| PK 22 - 596 x 896 x h / | material |
|-------------------------|----------|
| PKA 22-596 x 896 x h /  |          |
| 46                      | 1730     |
| 56                      | 2312     |
|                         | 2085     |

**PK 03**  
**PKA 03**

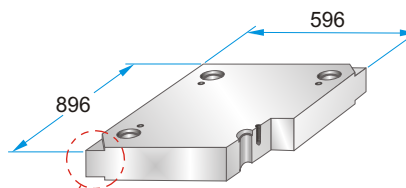
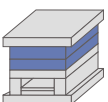

| PK 03 - 596 x 896 x h / | material |
|-------------------------|----------|
| PKA 03-596 x 896 x h /  |          |

|     |          |
|-----|----------|
| 27  | 1730     |
| 36  | 2083     |
| 46  | 2085     |
| 56  | 2162     |
| 66  | 2311     |
| 76  | 2312     |
| 86  | 2738     |
| 96  | Toolox33 |
| 116 | Toolox44 |
| 136 | 2738HH   |
| 156 | 2714HH   |
| 176 |          |
| 196 |          |

Corner undercuts upon request.  
Podcięcia do demontażu na życzenie.  
Abhebeecken erhältlich.  
Доступно высвобождение на углах плит.



Material info



## PK 31

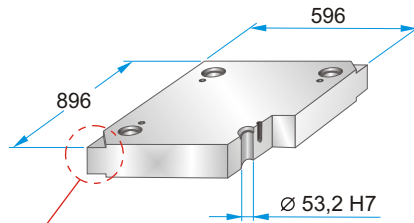
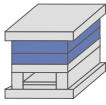

Corner undercuts upon request.  
Podcięcia do demontażu na życzenie.  
Abhebecken erhältlich.  
Доступно высвобождение на углах плит.



### PK 31 - 596 x 896 x h / material

|     |          |
|-----|----------|
| 46  | 1730     |
| 56  | 2083     |
| 66  | 2085     |
| 76  | 2162     |
| 86  | 2311     |
| 96  | 2312     |
| 116 | 2343     |
| 136 | 2738     |
| 156 | 2767     |
| 176 | Toolox33 |
| 196 | Toolox44 |
|     | 2738HH   |
|     | 2714HH   |

Material info

## PK 04 PKA 04

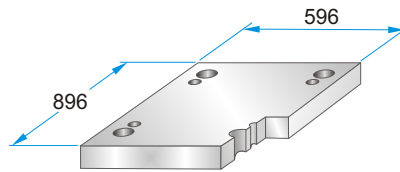
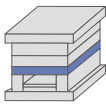

### PK 04 - 596 x 896 x h / PKA 04-596 x 896 x h / material

|    |      |
|----|------|
| 46 | 1730 |
| 56 | 2312 |
| 76 | 2085 |

## PK 05 PKA 05

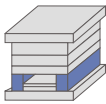

|        | A  | B   | M    |
|--------|----|-----|------|
| PK 05  | 84 | 428 | ---- |
| PKA 05 | 76 | 444 | M12  |

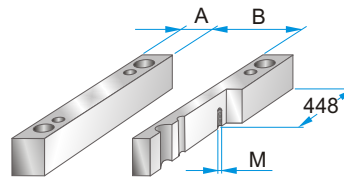

### PK 05 - 596 x 896 x h / PKA 05-596 x 896 x h / material

|     |      |
|-----|------|
| 86  | 1730 |
| 96  | 2085 |
| 116 |      |
| 136 |      |
| 156 |      |
| 176 |      |

## PK 55 PKA 55

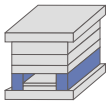

|        | A   | B   | M    |
|--------|-----|-----|------|
| PK 55  | 114 | 368 | ---- |
| PKA 55 | 106 | 384 | M12  |

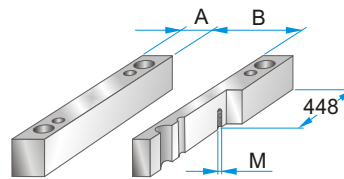

### PK 55 - 596 x 896 x h / PKA 55-596 x 896 x h / material

|     |      |
|-----|------|
| 86  | 1730 |
| 96  | 2085 |
| 116 |      |
| 136 |      |
| 156 |      |
| 176 |      |

## PK 06 PKA 06

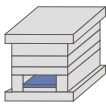

|        | A   | B   | C   |
|--------|-----|-----|-----|
| PK 06  | 810 | 388 | 424 |
| PKA 06 | 740 | 400 | 438 |

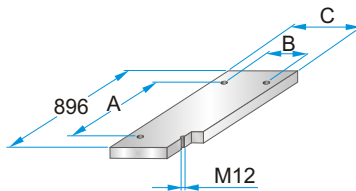

### PK 06 - 596 x 896 x h / PKA 06-596 x 896 x h / material

|    |      |
|----|------|
| 27 | 1730 |
|    | 2085 |

## PK 65 PKA 65

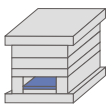

|        | A   | B   | C   |
|--------|-----|-----|-----|
| PK 65  | 810 | 328 | 364 |
| PKA 65 | 740 | 330 | 368 |

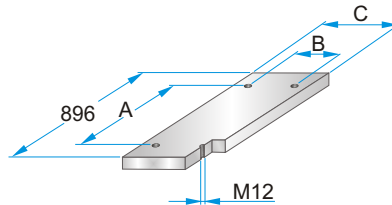

### PK 65 - 596 x 896 x h / PKA 65-596 x 896 x h / material

|    |      |
|----|------|
| 27 | 1730 |
|    | 2085 |

## PK 07 PKA 07

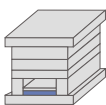

|        | A   | B   | C   | D    | M   |
|--------|-----|-----|-----|------|-----|
| PK 07  | 810 | 388 | 424 | ---- | --- |
| PKA 07 | 740 | 400 | 438 | 858  | M5  |

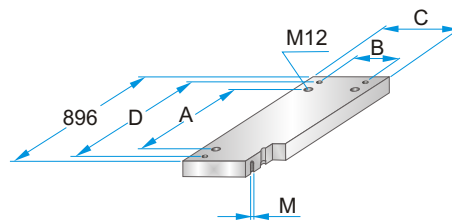

### PK 07 - 596 x 896 x h / PKA 07-596 x 896 x h / material

|    |      |
|----|------|
| 36 | 1730 |
|    | 2312 |
|    | 2085 |

## PK 75 PKA 75

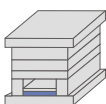

|        | A   | B   | C   | D    | M    |
|--------|-----|-----|-----|------|------|
| PK 75  | 810 | 328 | 364 | ---- | ---- |
| PKA 75 | 740 | 330 | 368 | 858  | M5   |

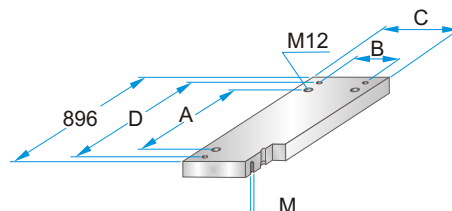

### PK 75 - 596 x 896 x h / PKA 75-596 x 896 x h / material

|    |      |
|----|------|
| 36 | 1730 |
|    | 2312 |
|    | 2085 |