

Dimensions and tolerances
Wymiary i tolerancje
Abmessungen und Toleranzen
Размеры и допуски

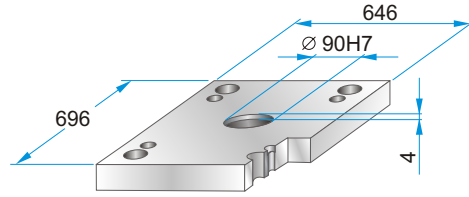

	A	B	C
PK	592	474	492
PKA	608	490	508

PKA 01

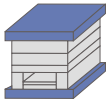

PKA 01-596 x 696 x h / material

46	1730
	2312
	2085

PK 11 PKA 11

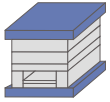

	W
PK 11	696
PKA 11	646

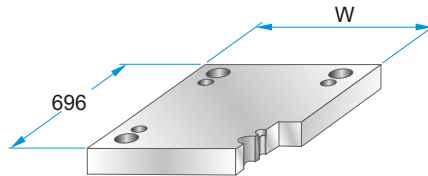

PK 11 - 596 x 696 x h /
PKA 11-596 x 696 x h / material

46	1730
56	2312
	2085

PK 02 PKA 02



PK 12 PKA 12

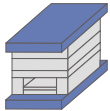

PKA 21

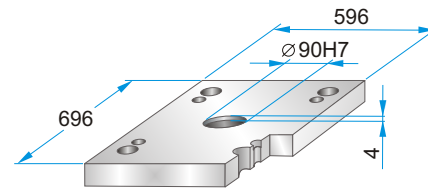
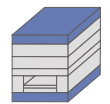

PKA 21-596 x 696 x h / material

46	1730
	2312
	2085

PK 22 PKA 22

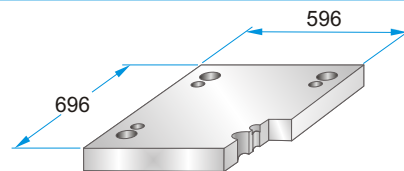

PK 22 - 596 x 696 x h /
PKA 22-596 x 696 x h / material

46	1730
56	2312
	2085

PK 03 PKA 03

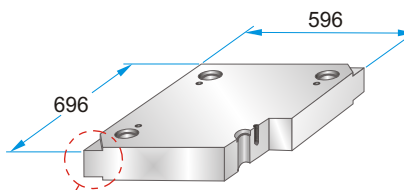
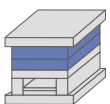

PK 03 - 596 x 696 x h /
PKA 03-596 x 696 x h / material

27	1730
36	2083
46	2085
56	2162
66	2311
76	2312
86	2738
96	Toolox33
116	Toolox44
136	2738HH
156	2714HH
176	
196	

Corner undercuts upon request.
Podcięcia do demontażu na życzenie.
Abhebeecken erhältlich.
Доступно высвобождение на углах плит.



Material info



PK 31

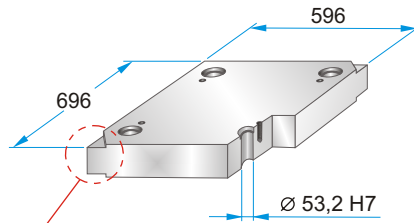
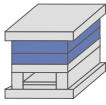

Corner undercuts upon request.
Podcięcia do demontażu na życzenie.
Abhebecken erhältlich.
Доступно высвобождение на углах плит.



PK 31 - 596 x 696 x h / material

46	1730
56	2083
66	2085
76	2162
86	2311
96	2312
116	2343
136	2738
156	2767
176	Toolox33
196	Toolox44
	2738HH
	2714HH

Material info

PK 04 PKA 04

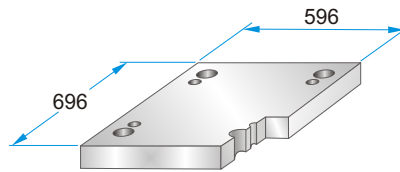
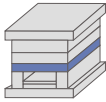

PK 04 - 596 x 696 x h /
PKA 04-596 x 696 x h / material

46	1730
56	2312
76	2085

PK 05 PKA 05

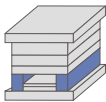

	A	B	M
PK 05	84	428	----
PKA 05	76	444	M12

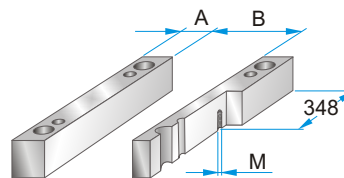

PK 05 - 596 x 696 x h /
PKA 05-596 x 696 x h / material

86	1730
96	2085
116	
136	
156	
176	

PK 55 PKA 55

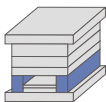

	A	B	M
PK 55	114	368	----
PKA 55	106	384	M12

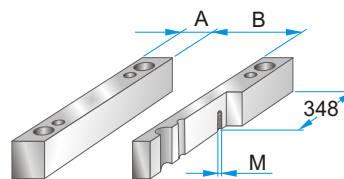

PK 55 - 596 x 696 x h /
PKA 55-596 x 696 x h / material

86	1730
96	2085
116	
136	
156	
176	

PK 06 PKA 06

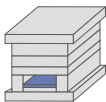

	A	B	C
PK 06	610	388	424
PKA 06	540	400	438

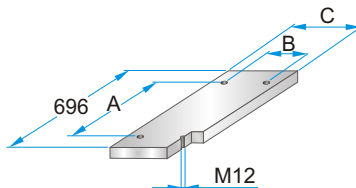

PK 06 - 596 x 696 x h /
PKA 06-596 x 696 x h / material

27	1730
	2085

PK 65 PKA 65

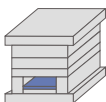

	A	B	C
PK 65	610	328	364
PKA 65	540	330	368

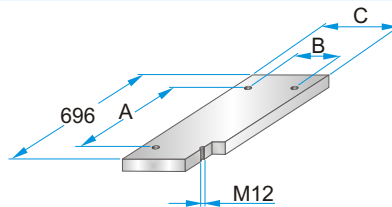

PK 65 - 596 x 696 x h /
PKA 65-596 x 696 x h / material

27	1730
	2085

PK 07 PKA 07

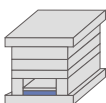

	A	B	C	D	M
PK 07	610	388	424	----	---
PKA 07	540	400	438	658	M5

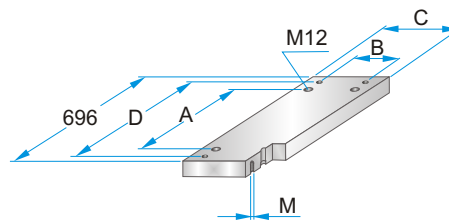

PK 07 - 596 x 696 x h /
PKA 07-596 x 696 x h / material

36	1730
	2312
	2085

PK 75 PKA 75

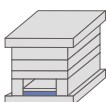

	A	B	C	D	M
PK 75	610	328	364	----	----
PKA 75	540	330	368	658	M5

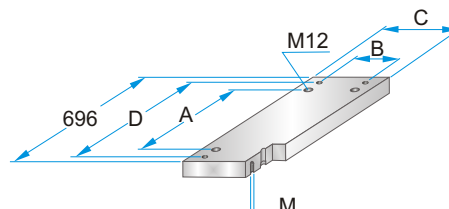

PK 75 - 596 x 696 x h /
PKA 75-596 x 696 x h / material

36	1730
	2312
	2085