

Dimensions and tolerances  
Wymiary i tolerancje  
Abmessungen und Toleranzen  
Размеры и допуски

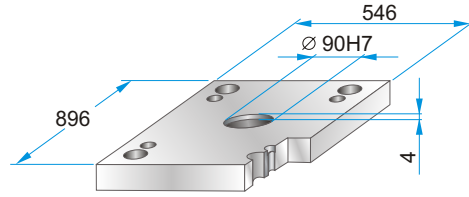

	A	B	C
<b>PK</b>	792	674	392
<b>PKA</b>	808	690	408

## PKA 01



PKA 01-496 x 896 x h / material

46	1730
	2312
	2085

## PK 11 PKA 11

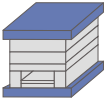

	W
PK 11	596
PKA 11	546

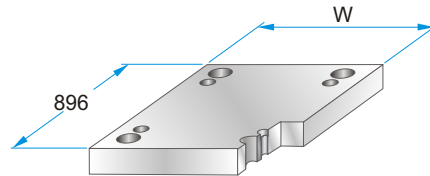

PK 11 - 496 x 896 x h /  
PKA 11-496 x 896 x h / material

46	1730
56	2312
	2085

## PK 02 PKA 02

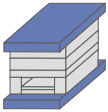

## PK 12 PKA 12

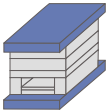

## PKA 21

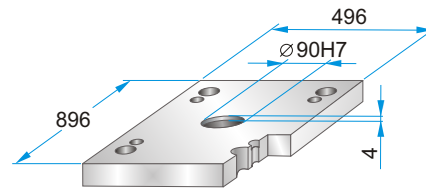
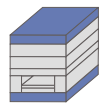

PKA 21-496 x 896 x h / material

46	1730
	2312
	2085

## PK 22 PKA 22

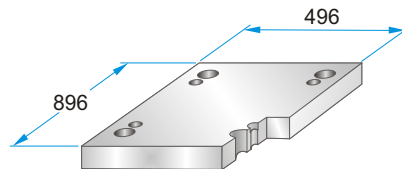
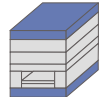

PK 22 - 496 x 896 x h /  
PKA 22-496 x 896 x h / material

46	1730
	2312
	2085

## PK 03 PKA 03

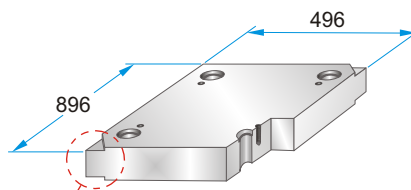
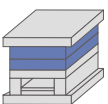

PK 03 - 496 x 896 x h /  
PKA 03-496 x 896 x h / material

27	1730
36	2083
46	2085
56	2162
66	2311
76	2312
86	2738
96	Toolox33
116	Toolox44
136	2738HH
156	2714HH
176	
196	

Corner undercuts upon request.  
Podcięcia do demontażu na życzenie.  
Abhebeecken erhältlich.  
Доступно высвобождение на углах плит.



Material info



## PK 31

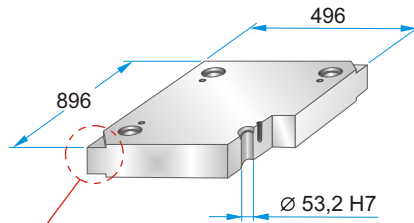
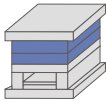

Corner undercuts upon request.  
Podcięcia do demontażu na życzenie.  
Abhebecken erhältlich.  
Доступно высвобождение на углах плит.



PK 31 - 496 x 896 x h / material

46	1730
56	2083
66	2085
76	2162
86	2311
96	2312
116	2343
136	2738
156	2767
176	Toolox33
196	Toolox44
	2738HH
	2714HH

Material info

## PK 04 PKA 04

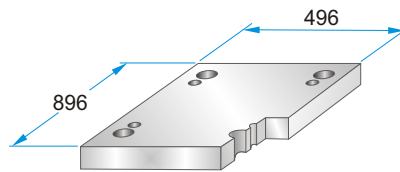
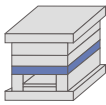

PK 04 - 496 x 896 x h /  
PKA 04-496 x 896 x h / material

46	1730
56	2312
76	2085

## PK 05 PKA 05

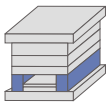

	A	B	M
PK 05	84	328	----
PKA 05	76	344	M12

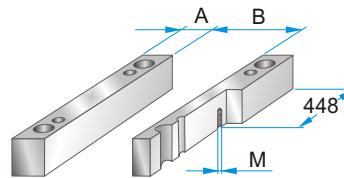

PK 05 - 496 x 896 x h /  
PKA 05-496 x 896 x h / material

86	1730
96	2085
116	
136	
156	
176	

## PK 55

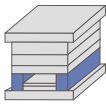

	A	B
PK 55	114	268

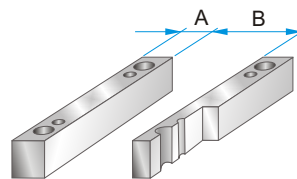

PK 55 - 496 x 896 x h / material

96	1730
116	2085
136	
156	

## PK 06 PKA 06

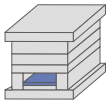

	A	B	C
PK 06	810	288	324
PKA 06	740	300	338

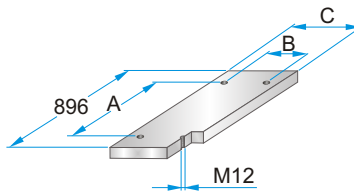

PK 06 - 496 x 896 x h /  
PKA 06-496 x 896 x h / material

27	1730
	2085

## PK 65

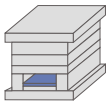

	A	B	C
PK 65	810	228	264

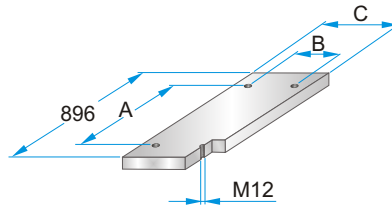

PK 65 - 496 x 896 x h / material

27	1730
	2085

## PK 07 PKA 07

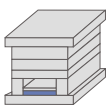

	A	B	C	D	M
PK 07	810	288	324	----	----
PKA 07	740	300	338	858	M5

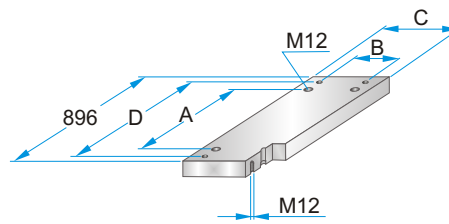

PK 07 - 496 x 896 x h /  
PKA 07-496 x 896 x h / material

36	1730
	2312
	2085

## PK 75

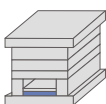

	A	B	C
PK 75	810	228	264

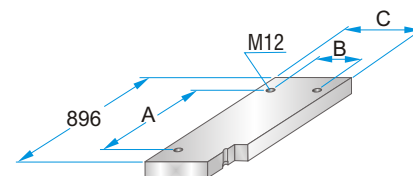

PK 75 - 496 x 896 x h / material

36	1730
	2312
	2085