

Dimensions and tolerances
Wymiary i tolerancje
Abmessungen und Toleranzen
Размеры и допуски



	A	B	C
PK	624	530	424
PKA	624	530	424

PK 01
PKA 01



	W
PK 01	596
PKA 01	546

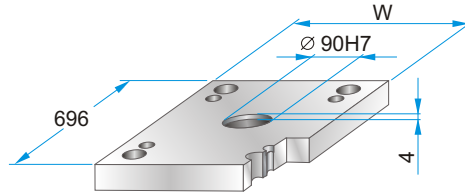

PK 01 - 496 x 696 x h / material

PKA 01-496 x 696 x h /	
46	1730
56	2312
	2085

PK 11
PKA 11



	W
PK 11	596
PKA 11	546

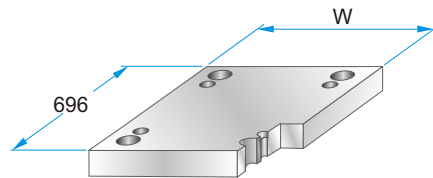

PK 11 - 496 x 696 x h / material

PKA 11-496 x 696 x h /	
46	1730
56	2312
	2085

PK 02
PKA 02



PK 12
PKA 12

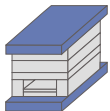

PK 21
PKA 21

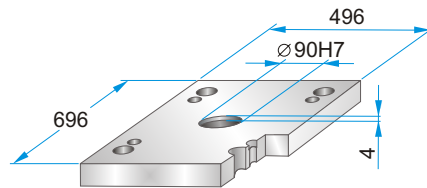

PK 21 - 496 x 696 x h / material

PKA 21-496 x 696 x h /	
36	1730
46	2312
	2085

PK 22
PKA 22

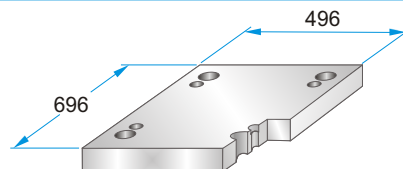
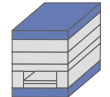

PK 22 - 496 x 696 x h / material

PKA 22-496 x 696 x h /	
36	1730
46	2312
	2085

PK 03
PKA 03

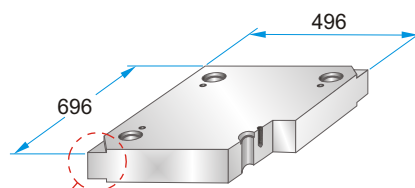
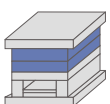

PK 03 - 496 x 696 x h / material

PKA 03-496 x 696 x h /	
27	1730
36	2083
46	2085
56	2162
66	2311
76	2312
86	2738
96	Toolox33
116	Toolox44
136	2738HH
156	2714HH
176	

Corner undercuts upon request.
Podcięcia do demontażu na życzenie.
Abhebeecken erhältlich.
Доступно высвобождение на углах плит.



Material info



PK 31

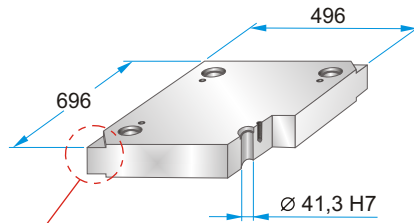
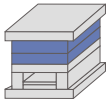

Corner undercuts upon request.
Podcięcia do demontażu na życzenie.
Abhebecken erhältlich.
Доступно высвобождение на углах плит.



PK 31 - 496 x 696 x h / material

36	1730
46	2083
56	2085
66	2162
76	2311
86	2312
96	2343
116	2738
136	2767
156	Toolox33
176	Toolox44
	2738HH
	2714HH

Material info

PK 04 PKA 04

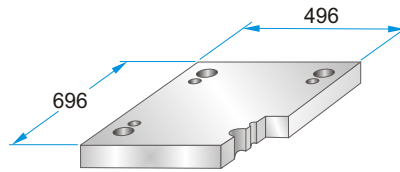
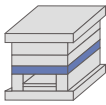

PK 04 - 496 x 696 x h /
PKA 04-496 x 696 x h / material

46	1730
56	2312
	2085

PK 05 PKA 05

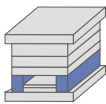

	A	B	M
PK 05	62	372	----
PKA 05	62	372	M10

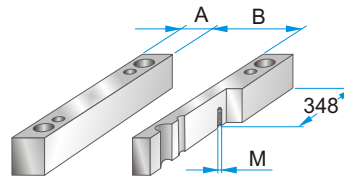

PK 05 - 496 x 696 x h /
PKA 05-496 x 696 x h / material

76	1730
86	2085
96	
116	
136	
156	

PK 55 PKA 55

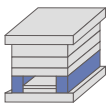

	A	B	M
PK 55	86	324	----
PKA 55	86	324	M10

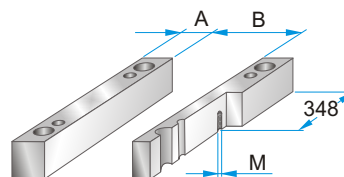

PK 55 - 496 x 696 x h /
PKA 55-496 x 696 x h / material

76	1730
86	2085
96	
116	
136	
156	

PK 06 PKA 06

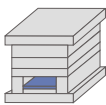

	A	B	C
PK 06	614	336	368
PKA 06	560	330	368

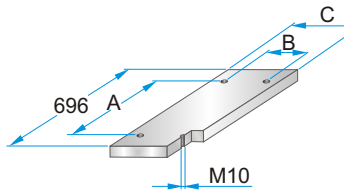

PK 06 - 496 x 696 x h /
PKA 06-496 x 696 x h / material

27	1730
	2085

PK 65 PKA 65

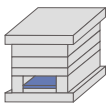

	A	B	C
PK 65	614	288	320
PKA 65	560	280	318

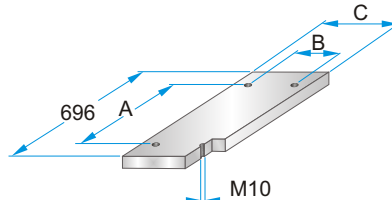

PK 65 - 496 x 696 x h /
PKA 65-496 x 696 x h / material

27	1730
	2085

PK 07 PKA 07

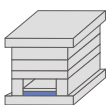

	A	B	C	D	M
PK 07	614	336	368	664	M4
PKA 07	560	330	368	658	M5

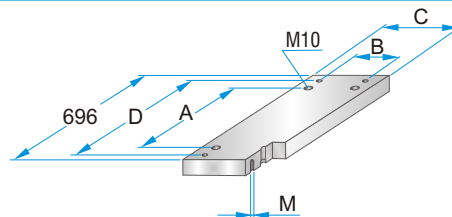

PK 07 - 496 x 696 x h /
PKA 07-496 x 696 x h / material

36	1730
	2312
	2085

PK 75 PKA 75

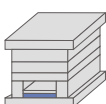

	A	B	C	D	M
PK 75	614	288	320	664	M4
PKA 75	560	280	318	658	M5

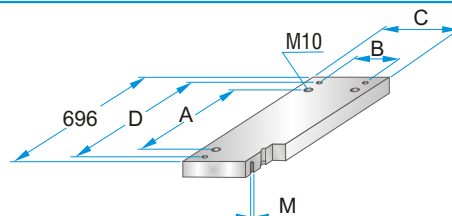

PK 75 - 496 x 696 x h /
PKA 75-496 x 696 x h / material

36	1730
	2312
	2085