

Dimensions and tolerances
Wymiary i tolerancje
Abmessungen und Toleranzen
Размеры и допуски



	A	B	C
PK	374	280	374
PKA	374	280	374

PK 01
PKA 01



	W
PK 01	546
PKA 01	496

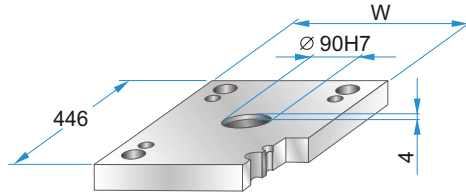

PK 01 - 446 x 446 x h / material
PKA 01-446 x 446 x h /

36	1730
46	2312
	2085

PK 11
PKA 11



	W
PK 11	546
PKA 11	496

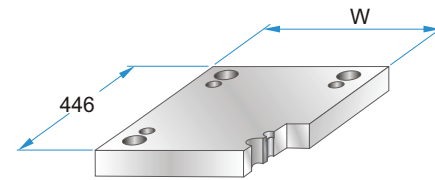

PK 11 - 446 x 446 x h / material
PKA 11-446 x 446 x h /

36	1730
46	2312
	2085

PK 02
PKA 02

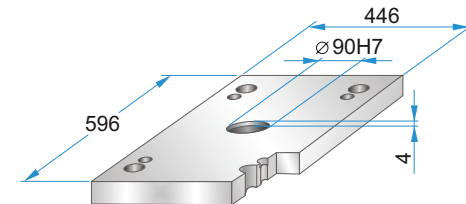
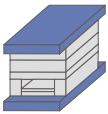

PK 02 - 446 x 446 x h / material
PKA 02-446 x 446 x h /

36	1730
46	2312
	2085

PK 12
PKA 12

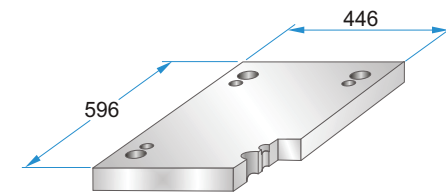
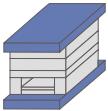

PK 12 - 446 x 446 x h / material
PKA 12-446 x 446 x h /

36	1730
46	2312
	2085

PK 21
PKA 21

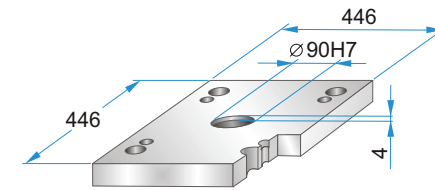

PK 21 - 446 x 446 x h / material
PKA 21-446 x 446 x h /

27	1730
36	2312
46	2085

PK 22
PKA 22

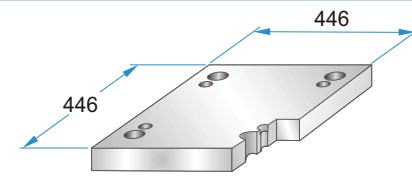

PK 22 - 446 x 446 x h / material
PKA 22-446 x 446 x h /

27	1730
36	2312
46	2085

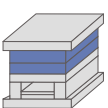

PK 03
PKA 03

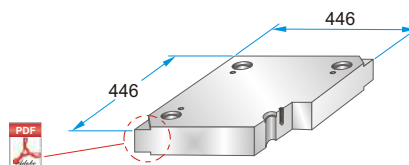

PK 35
PKA 35

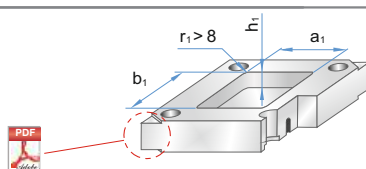

PK 03 - 446 x 446 x h / material
PKA 03-446 x 446 x h /

PK 35 - 446 x 446 x h / material
PKA 35-446 x 446 x h / (a1/b1/h1/r1)

27	1730
36	2083
46	2085
56	2162
66	2311
76	2312
86	2378
96	Toolox33
116	Toolox44
136	2738HH
156	2714HH
176	

Corner undercuts upon request.
Podcięcia do demontażu na życzenie.
Abhebeecken erhältlich.
Доступно высвобождение на углах плит.

Material info



PK 31
PKA 31

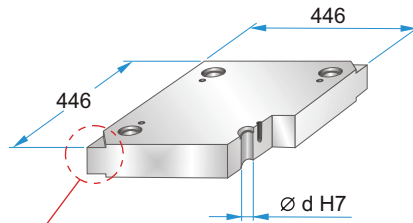
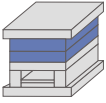

Corner undercuts upon request.
Podcięcia do demontażu na życzenie.
Abhebecken erhältlich.
Доступно высвобождение на углах плит.



	d
PK 31	41,3
PKA 31	41,4

PK 31 - 446 x 446 x h /
PKA 31-446 x 446 x h / material

22	1730
27	2083
36	2085
46	2162
56	2311
66	2312
76	2343
86	2738
96	2767
116	Toolox33
136	Toolox44
156	2738HH
176	2714HH

Material info

PK 04
PKA 04

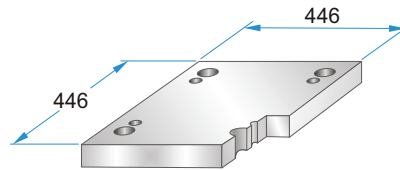
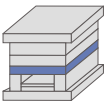

PK 04 - 446 x 446 x h /
PKA 04-446 x 446 x h / material

36	1730
46	2312
56	2085
66	
76	
86	

PK 05
PKA 05

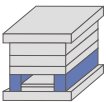

	A	B	M
PK 05	62	322	----
PKA 05	62	322	M10

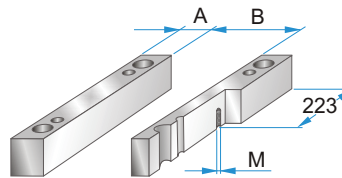

PK 05 - 446 x 446 x h /
PKA 05-446 x 446 x h / material

56	1730
66	2085
76	
86	
96	
116	
136	
156	

PK 55
PKA 55

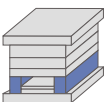

	A	B	M
PK 55	86	274	----
PKA 55	86	274	M10

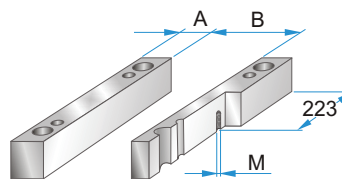

PK 55 - 446 x 446 x h /
PKA 55-446 x 446 x h / material

56	1730
66	2085
76	
86	
96	
116	
136	
156	

PK 06
PKA 06

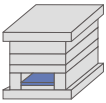

	A	B	C
PK 06	364	286	318
PKA 06	310	280	318

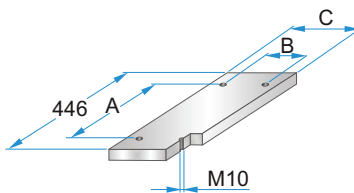

PK 06 - 446 x 446 x h /
PKA 06-446 x 446 x h / material

17	1730
22	2085

PK 65
PKA 65

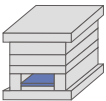

	A	B	C
PK 65	364	238	270
PKA 65	310	230	268

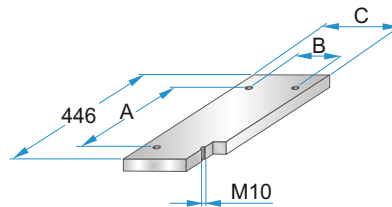

PK 65 - 446 x 446 x h /
PKA 65-446 x 446 x h / material

17	1730
22	2085

PK 07
PKA 07

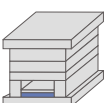

	A	B	C	D	M
PK 07	364	286	318	414	M4
PKA 07	310	280	318	408	M5

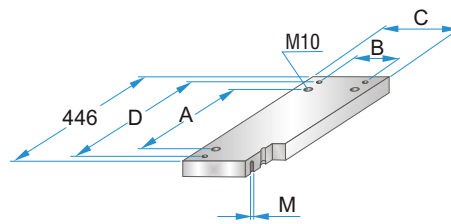

PK 07 - 446 x 446 x h /
PKA 07-446 x 446 x h / material

27	1730
	2312
	2085

PK 75
PKA 75

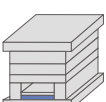

	A	B	C	D	M
PK 75	364	238	270	414	M4
PKA 75	310	230	268	408	M5

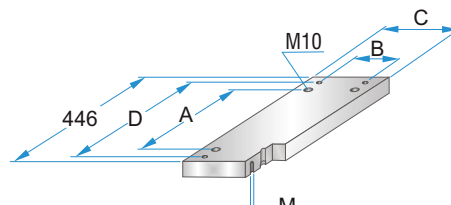

PK 75 - 446 x 446 x h /
PKA 75-446 x 446 x h / material

27	1730
	2312
	2085