

Korpus formy

Mold base

296x446

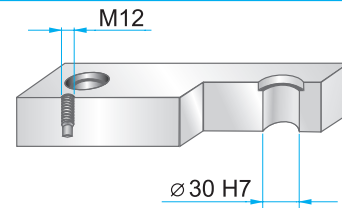
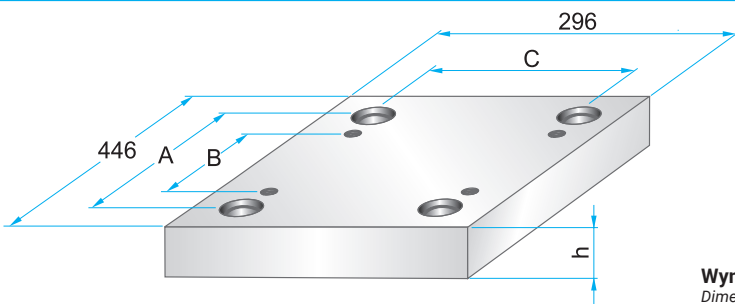

Wymiary i tolerancje
Dimensions and tolerances



	A	B	C
PK	394	324	244
PKA	398	320	248

**PK 01
PKA 01**

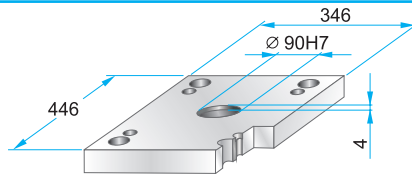

PK 01	- 296 x 446 x	h /	material
PKA 01	- 296 x 446 x	h /	material
		27	1730
		36	2312
		46	2085

**PK 11
PKA 11**

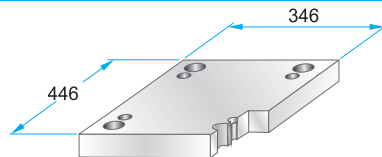

PK 11	- 296 x 446 x	h /	material
PKA 11	- 296 x 446 x	h /	material
		27	1730
		36	2312
		46	2085

PKA 02

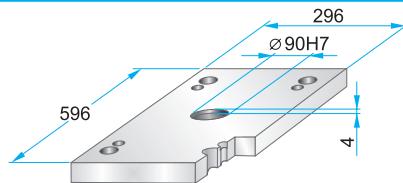
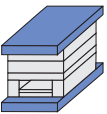

PKA 02	- 296 x 446 x	h /	material
		27	1730
		36	2312
			2085

PKA 12

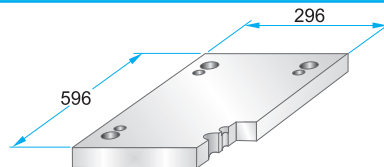
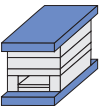

PKA 12	- 296 x 446 x	h /	material
		27	1730
		36	2312
			2085

**PK 21
PKA 21**

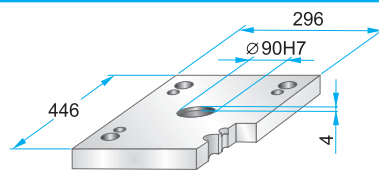
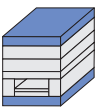

PK 21	- 296 x 446 x	h /	material
PKA 21	- 296 x 446 x	h /	material
		27	1730
		36	2312
			2085

**PK 22
PKA 22**

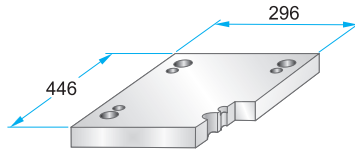
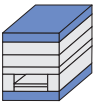

PK 22	- 296 x 446 x	h /	material
PKA 22	- 296 x 446 x	h /	material
		27	1730
		36	2312
			2085

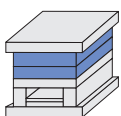

**PK 03
PKA 03**

**PK 35
PKA 35**

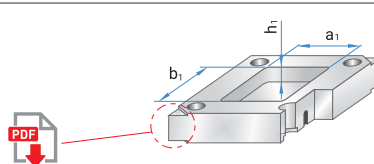
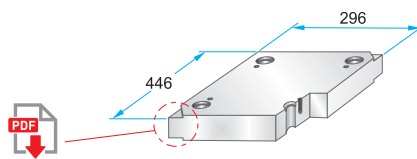

PK 03	- 296 x 446 x	h /	material
PKA 03	- 296 x 446 x	h /	material
PK 35	- 296 x 446 x	h /	material
PKA 35	- 296 x 446 x	h /	(a ₁ /b ₁ /h ₁)

17	1730
22	2083
27	2085
36	2162
46	2311
56	2312
66	2738
76	Toolox33
86	Toolox44
96	2738HH
116	2714HH
136	
156	

Podcęcia do demontażu na życzenie.
Corner undercuts upon request.



Material info



Korpus formy

Mold base

296x446

**PK 31
PKA 31**

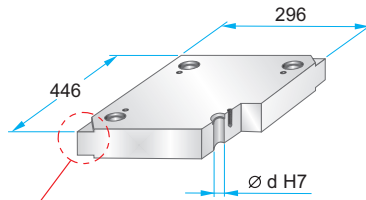
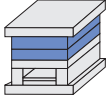

PK 31 – 296 x 446 x h / material
PKA 31 – 296 x 446 x h /

27	1730
36	2083
46	2085
56	2162
66	2311
76	2312
86	2343
96	2738
116	2767
136	Toolox33 Toolox44 2738HH 2714HH

Podcięcia do demontażu na życzenie.
Corner undercuts upon request.



	d
PK 31	29,4
PKA 31	29,5

Material info

**PK 04
PKA 04**

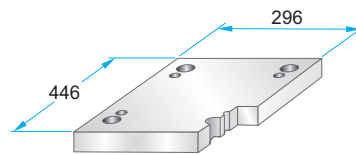
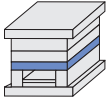

PK 04 – 296 x 446 x h / material
PKA 04 – 296 x 446 x h /

36	1730
46	2312
56	2085
66	
76	
86	

**PK 05
PKA 05**

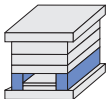

	A	B	M
PK 05	43	210	–
PKA 05	44	208	M10

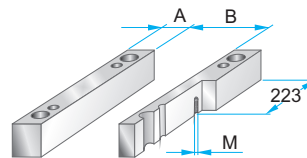

PK 05 – 296 x 446 x h / material
PKA 05 – 296 x 446 x h /

56	1730
66	2085
76	
86	
96	
116	

**PK 55
PKA 55**

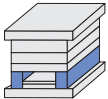

	A	B	M
PK 55	58	180	–
PKA 55	60	176	M10

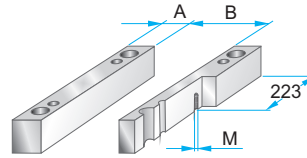

PK 55 – 296 x 446 x h / material
PKA 55 – 296 x 446 x h /

56	1730
66	2085
76	
86	
96	
116	

**PK 06
PKA 06**

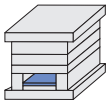

	A	B	C
PK 06	380	184	208
PKA 06	350	180	206

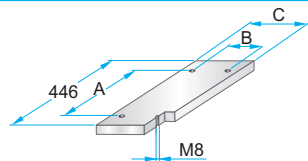

PK 06 – 296 x 446 x h / material
PKA 06 – 296 x 446 x h /

17	1730
	2085

**PK 65
PKA 65**

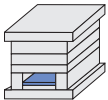

	A	B	C
PK 65	380	152	176
PKA 65	350	146	172

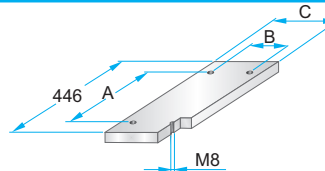

PK 65 – 296 x 446 x h / material
PKA 65 – 296 x 446 x h /

17	1730
	2085

**PK 07
PKA 07**

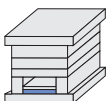

	A	B	C	D	M
PK 07	380	184	208	414	M4
PKA 07	350	180	206	420	M5

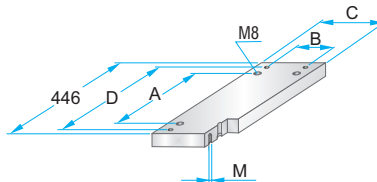

PK 07 – 296 x 446 x h / material
PKA 07 – 296 x 446 x h /

22	1730
	2312
	2085

**PK 75
PKA 75**

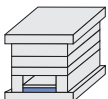

	A	B	C	D	M
PK 75	380	152	176	414	M4
PKA 75	350	146	172	420	M5

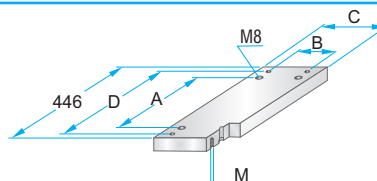

PK 75 – 296 x 446 x h / material
PKA 75 – 296 x 446 x h /

22	1730
	2312
	2085