

Korpus formy

Mold base

296x396

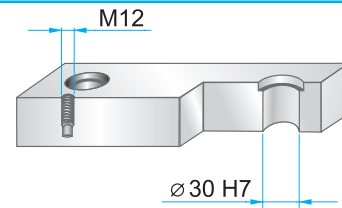
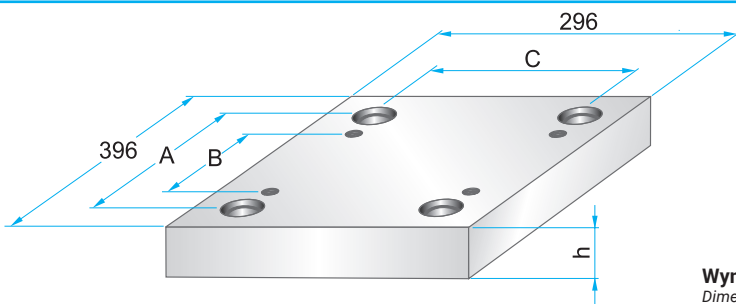

Wymiary i tolerancje
Dimensions and tolerances



	A	B	C
PK	340	284	248
PKA	348	270	248

**PK 01
PKA 01**

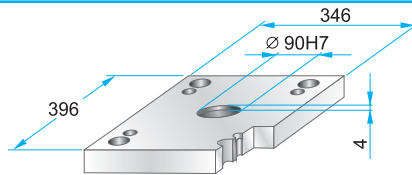

PK 01 - 296 x 396 x h / material
PKA 01 - 296 x 396 x h /

27	1730
36	2312
46	2085

**PK 11
PKA 11**

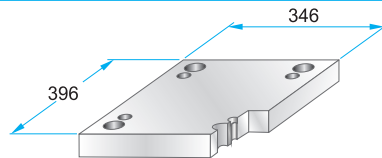
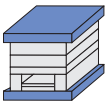

PK 11 - 296 x 396 x h / material
PKA 11 - 296 x 396 x h /

27	1730
36	2312
46	2085

**PK 02
PKA 02**

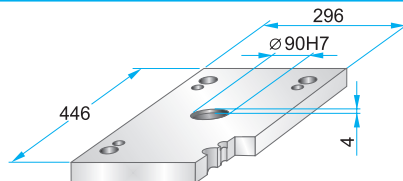
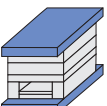

PK 02 - 296 x 396 x h / material
PKA 02 - 296 x 396 x h /

27	1730
36	2312
	2085

**PK 12
PKA 12**

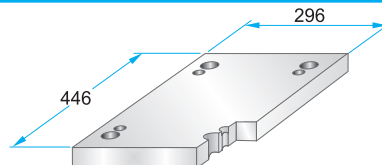
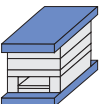

PK 12 - 296 x 396 x h / material
PKA 12 - 296 x 396 x h /

27	1730
36	2312
	2085

**PK 21
PKA 21**

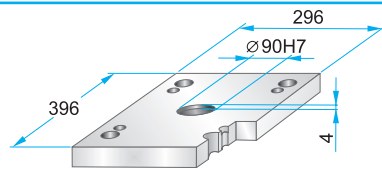
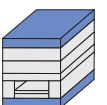

PK 21 - 296 x 396 x h / material
PKA 21 - 296 x 396 x h /

22	1730
27	2312
36	2085

**PK 22
PKA 22**

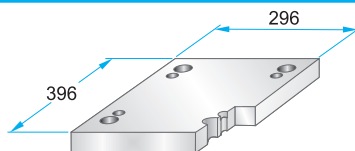

PK 22 - 296 x 396 x h / material
PKA 22 - 296 x 396 x h /

22	1730
27	2312
36	2085

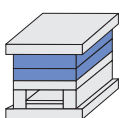

**PK 03
PKA 03**

**PK 35
PKA 35**

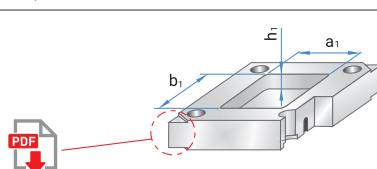
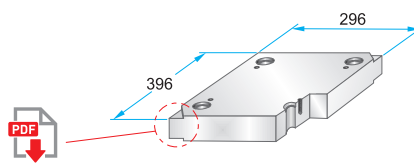

PK 03 - 296 x 396 x h / material
PKA 03 - 296 x 396 x h /

PK 35 - 296 x 396 x h / material
PKA 35 - 296 x 396 x h / (a1/b1/h1)

17	1730
22	2083
27	2085
36	2162
46	2311
56	2312
66	2738
76	Toolox33
86	Toolox44
96	2738HH
116	2714HH
136	
156	

Podcięcia do demontażu na życzenie.
Corner undercuts upon request.



Material info



Korpus formy

Mold base

296x396

**PK 31
PKA 31**

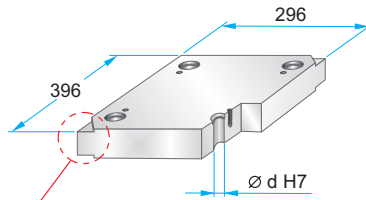
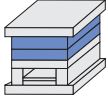

PK 31 – 296 x 396 x h / material
PKA 31 – 296 x 396 x h /

Podcięcia do demontażu na życzenie.
Corner undercuts upon request.



	d
PK 31	29,4
PKA 31	29,5

Material info



22	1730
27	2083
36	2085
46	2162
56	2311
66	2312
76	2343
86	2738
96	2767
116	Toolox33
136	Toolox44
	2738HH
	2714HH

**PK 04
PKA 04**

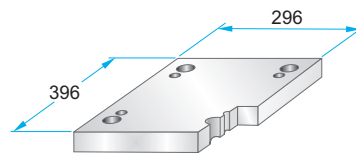
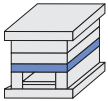

PK 04 – 296 x 396 x h / material
PKA 04 – 296 x 396 x h /

27	1730
36	2312
46	2085
56	
66	
76	
86	

**PK 05
PKA 05**

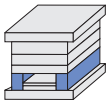

	A	B	M
PK 05	47	202	–
PKA 05	44	208	M10

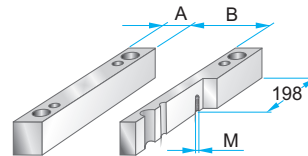

PK 05 – 296 x 396 x h / material
PKA 05 – 296 x 396 x h /

56	1730
66	2085
76	
86	
96	
116	

**PK 55
PKA 55**

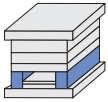

	A	B	M
PK 55	62	172	–
PKA 55	60	176	M10

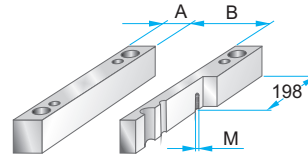

PK 55 – 296 x 396 x h / material
PKA 55 – 296 x 396 x h /

56	1730
66	2085
76	
86	
96	
116	

**PK 06
PKA 06**

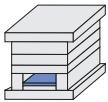

	A	B	C
PK 06	330	176	200
PKA 06	300	180	206

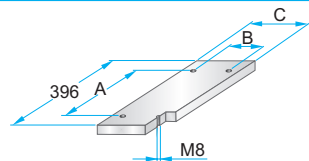

PK 06 – 296 x 396 x h / material
PKA 06 – 296 x 396 x h /

17	1730
	2085

**PK 65
PKA 65**

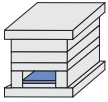

	A	B	C
PK 65	330	144	168
PKA 65	300	146	172

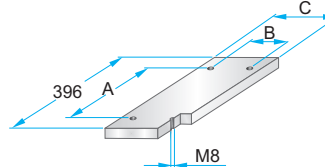

PK 65 – 296 x 396 x h / material
PKA 65 – 296 x 396 x h /

17	1730
	2085

**PK 07
PKA 07**

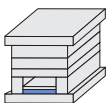

	A	B	C	D	M
PK 07	330	176	200	364	M4
PKA 07	300	180	206	370	M5

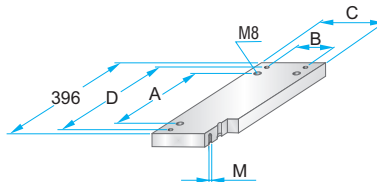

PK 07 – 296 x 396 x h / material
PKA 07 – 296 x 396 x h /

22	1730
	2312
	2085

**PK 75
PKA 75**

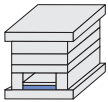

	A	B	C	D	M
PK 75	330	144	168	364	M4
PKA 75	300	146	172	370	M5

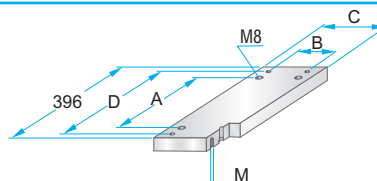

PK 75 – 296 x 396 x h / material
PKA 75 – 296 x 396 x h /

22	1730
	2312
	2085