

Dimensions and tolerances  
Wymiary i tolerancje  
Abmessungen und Toleranzen  
Размеры и допуски

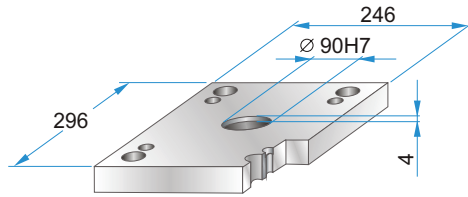

	A	B	C	d	d2
<b>PK</b>	244	186	150	30	M12
<b>PKA</b>	256	186	156	26	M10

**PK 01**  
**PKA 01**



PK 01 - 196 x 296 x h / material  
PKA 01-196 x 296 x h / material

22	1730
27	2312
36	2085
46	

**PK 11**  
**PKA 11**

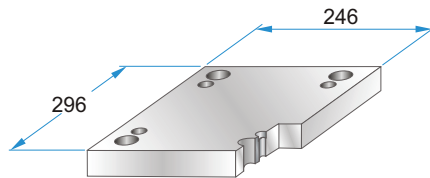

PK 11 - 196 x 296 x h / material  
PKA 11-196 x 296 x h / material

22	1730
27	2312
36	2085
46	

**PK 02**  
**PKA 02**

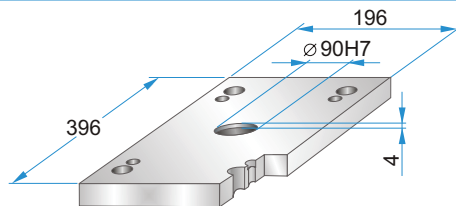
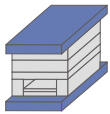

PK 02 - 196 x 296 x h / material  
PKA 02-196 x 296 x h / material

22	1730
27	2312
36	2085

**PK 12**  
**PKA 12**

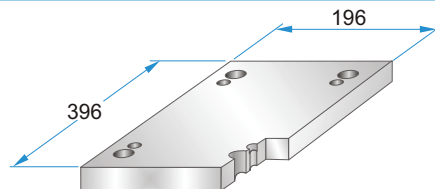
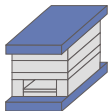

PK 12 - 196 x 296 x h / material  
PKA 12-196 x 296 x h / material

22	1730
27	2312
36	2085

**PK 21**  
**PKA 21**

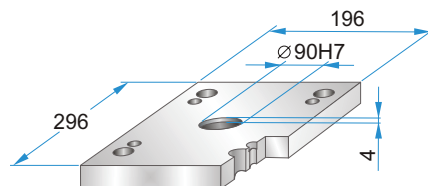
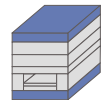

PK 21 - 196 x 296 x h / material  
PKA 21-196 x 296 x h / material

22	1730
27	2312
	2085

**PK 22**  
**PKA 22**

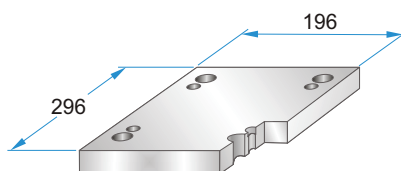
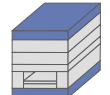

PK 22 - 196 x 296 x h / material  
PKA 22-196 x 296 x h / material

17	1730
22	2312
27	2085

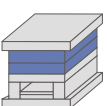

**PK 03**  
**PKA 03**

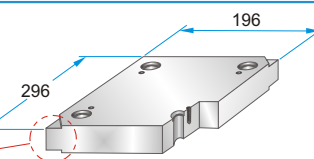

**PK 35**  
**PKA 35**

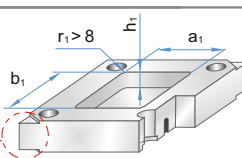

PK 03 - 196 x 296 x h / material  
PKA 03-196 x 296 x h / material

PK 35 - 196 x 296 x h / material  
PKA 35-196 x 296 x h / (a<sub>1</sub>/b<sub>1</sub>/h<sub>1</sub>/r<sub>1</sub>)

17	1730
22	2083
27	2085
36	2162
46	2311
56	2312
66	2738
76	Toolox33
86	Toolox44
96	2738HH
116	2714HH

Corner undercuts upon request.  
Podcięcia do demontażu na życzenie.  
Abhebeecken erhältlich.  
Доступно высвобождение на углах плит.

Material info



**PK 31**  
**PKA 31**

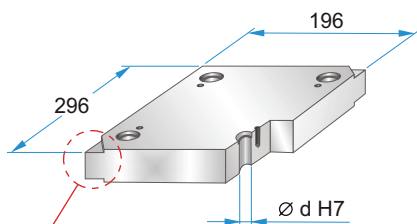
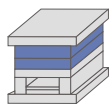

Corner undercuts upon request.  
Podcięcia do demontażu na życzenie.  
Abhebeecken erhältlich.  
Доступно высвобождение на углах плит.



	d
PK 31	29,4
PKA 31	25,6

PK 31 - 196 x 296 x h /  
PKA 31-196 x 296 x h / material

17	1730
22	2083
27	2085
36	2162
46	2311
56	2312
66	2343
76	2738
86	2767
96	Toolox33
	Toolox44
	2738HH
	2714HH

Material info

**PK 04**  
**PKA 04**

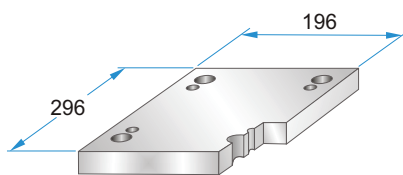
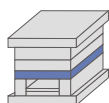

PK 04 - 196 x 296 x h /  
PKA 04-196 x 296 x h / material

22	1730
27	2312
36	2085
46	
56	
66	

**PK 05**  
**PKA 05**

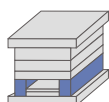

	A	B
PK 05	43	110
PKA 05	36	124

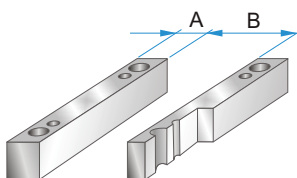

PK 05 - 196 x 296 x h /  
PKA 05-196 x 296 x h / material

46	1730
56	2085
66	
76	
86	
96	

**PK 55**  
**PKA 55**

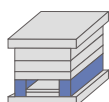

	A	B
PK 55	58	80
PKA 55	50	96

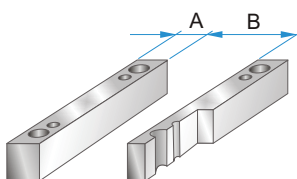

PK 55 - 196 x 296 x h /  
PKA 55-196 x 296 x h / material

46	1730
56	2085
66	
76	
86	
96	

**PK 06**  
**PKA 06**

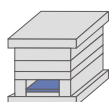

	A	B	C
PK 06	230	90	108
PKA 06	220	96	122

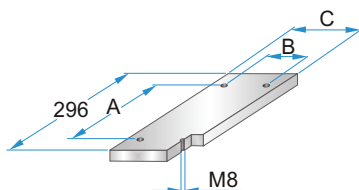

PK 06 - 196 x 296 x h /  
PKA 06-196 x 296 x h / material

12	1730
	2085

**PK 65**  
**PKA 65**

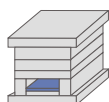

	A	B	C
PK 65	230	58	76
PKA 65	220	68	94

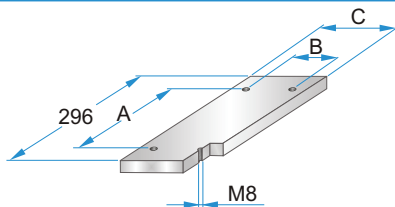

PK 65 - 196 x 296 x h /  
PKA 65-196 x 296 x h / material

12	1730
	2085

**PK 07**  
**PKA 07**

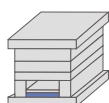

	A	B	C	D	M
PK 07	230	90	108	266	M4
PKA 07	220	96	122	270	M5

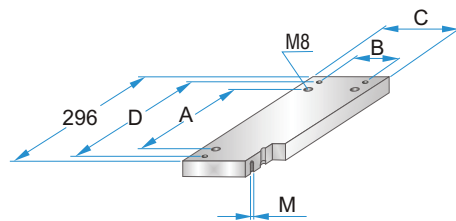

PK 07 - 196 x 296 x h /  
PKA 07-196 x 296 x h / material

17	1730
	2312
	2085

**PK 75**  
**PKA 75**

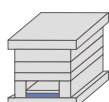

	A	B	C	D	M
PK 75	230	58	76	266	M4
PKA 75	220	68	94	270	M5

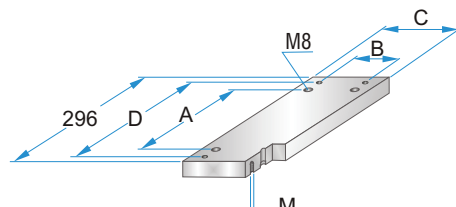

PK 75 - 196 x 296 x h /  
PKA 75-196 x 296 x h / material

17	1730
	2312
	2085