

Dimensions and tolerances
Wymiary i tolerancje
Abmessungen und Toleranzen
Размеры и допуски

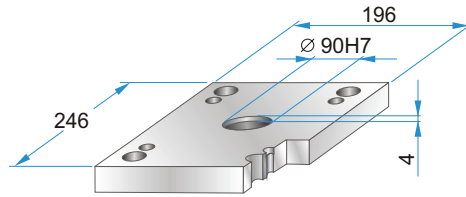

| | A | B | C |
|------------|-----|-----|-----|
| PK | 212 | 162 | 122 |
| PKA | 214 | 150 | 124 |

PK 01
PKA 01



PK 01 - 156 x 246 x h / material
PKA 01-156 x 246 x h / material

| | |
|----|------|
| 22 | 1730 |
| 27 | 2312 |
| | 2085 |

PK 11
PKA 11

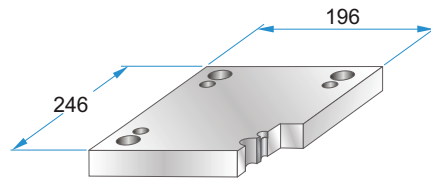

PK 11 - 156 x 246 x h / material
PKA 11-156 x 246 x h / material

| | |
|----|------|
| 22 | 1730 |
| 27 | 2312 |
| | 2085 |

PK 02
PKA 02

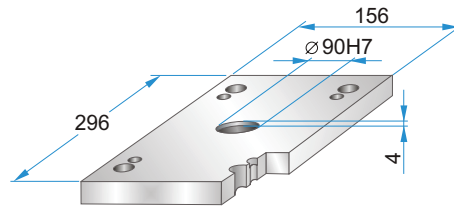
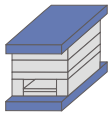

PK 02 - 156 x 246 x h / material
PKA 02-156 x 246 x h / material

| | |
|----|------|
| 22 | 1730 |
| 27 | 2312 |
| | 2085 |

PK 12
PKA 12

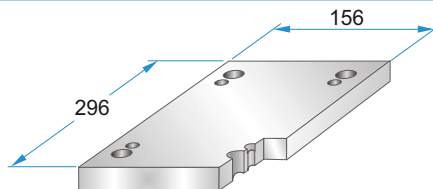

PK 12 - 156 x 246 x h / material
PKA 12-156 x 246 x h / material

| | |
|----|------|
| 22 | 1730 |
| 27 | 2312 |
| | 2085 |

PK 21
PKA 21

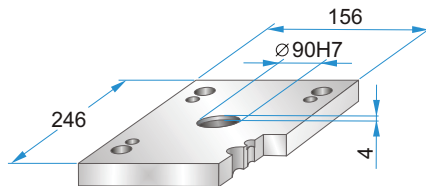

PK 21 - 156 x 246 x h / material
PKA 21-156 x 246 x h / material

| | |
|----|------|
| 17 | 1730 |
| 22 | 2312 |
| 27 | 2085 |

PK 22
PKA 22

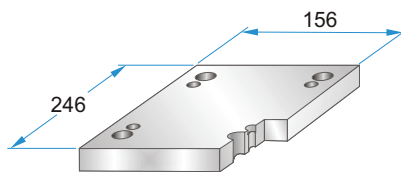
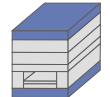

PK 22 - 156 x 246 x h / material
PKA 22-156 x 246 x h / material

| | |
|----|------|
| 17 | 1730 |
| 22 | 2312 |
| 27 | 2085 |

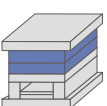

PK 03
PKA 03

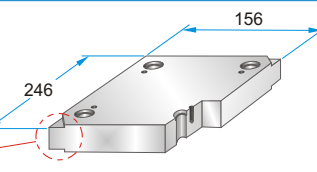

PK 35
PKA 35

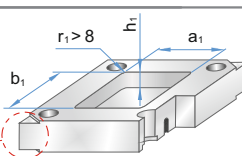

PK 03 - 156 x 246 x h / material
PKA 03-156 x 246 x h / material

PK 35 - 156 x 246 x h / material
PKA 35-156 x 246 x h / ($a_1/b_1/h_1/r_1$)

| | |
|----|----------|
| 17 | 1730 |
| 22 | 2083 |
| 27 | 2085 |
| 36 | 2162 |
| 46 | 2311 |
| 56 | 2312 |
| 66 | 2738 |
| 76 | Toolox33 |
| 86 | Toolox44 |
| 96 | 2738HH |
| | 2714HH |

Material info



Corner undercuts upon request.
Podcięcia do demontażu na życzenie.
Abhebeecken erhältlich.
Доступно высвобождение на углах плит.

PK 31
PKA 31

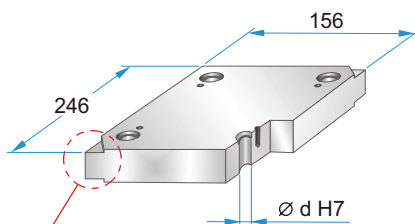
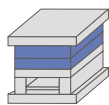

Corner undercuts upon request.
Podcięcia do demontażu na życzenie.
Abhebeecken erhältlich.
Доступно высвобождение на углах плит.



| | d |
|--------|------|
| PK 31 | 19,6 |
| PKA 31 | 19,7 |

PK 31 - 156 x 246 x h /
PKA 31-156 x 246 x h / material

| | |
|----|----------|
| 17 | 1730 |
| 22 | 2083 |
| 27 | 2085 |
| 36 | 2162 |
| 46 | 2311 |
| 56 | 2312 |
| 66 | 2343 |
| 76 | 2738 |
| 86 | 2767 |
| | Toolox33 |
| | Toolox44 |
| | 2738HH |
| | 2714HH |

Material info

PK 04
PKA 04

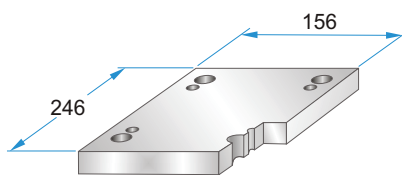
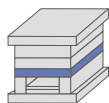

PK 04 - 156 x 246 x h /
PKA 04-156 x 246 x h / material

| | |
|----|------|
| 22 | 1730 |
| 27 | 2312 |
| 36 | 2085 |
| 46 | |
| 56 | |

PK 05
PKA 05

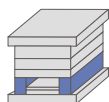

| | A | B |
|--------|----|----|
| PK 05 | 32 | 92 |
| PKA 05 | 29 | 98 |

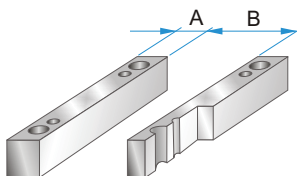

PK 05 - 156 x 246 x h /
PKA 05-156 x 246 x h / material

| | |
|----|------|
| 46 | 1730 |
| 56 | 2085 |
| 66 | |
| 76 | |
| 86 | |
| 96 | |

PK 55
PKA 55

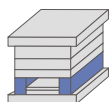

PK 06
PKA 06

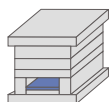

| | A | B | C |
|--------|-----|----|----|
| PK 06 | 186 | 68 | 90 |
| PKA 06 | 170 | 70 | 96 |

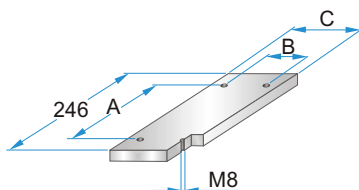

PK 06 - 156 x 246 x h /
PKA 06-156 x 246 x h / material

| | |
|---|------|
| 9 | 1730 |
| | 2085 |

PK 65
PKA 65

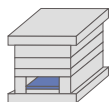

PK 07
PKA 07

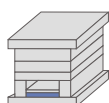

| | A | B | C | D | M |
|--------|-----|----|----|-----|----|
| PK 07 | 186 | 68 | 90 | 224 | M4 |
| PKA 07 | 170 | 70 | 96 | 220 | M5 |

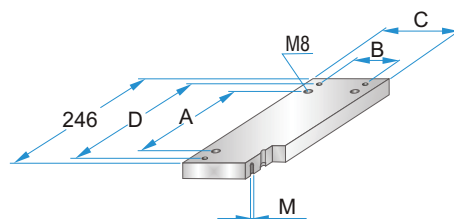

PK 07 - 156 x 246 x h /
PKA 07-156 x 246 x h / material

| | |
|----|------|
| 17 | 1730 |
| | 2312 |
| | 2085 |

PK 75
PKA 75

