

Dimensions and tolerances
Wymiary i tolerancje
Abmessungen und Toleranzen
Размеры и допуски

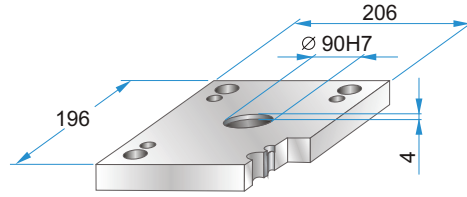

	A	B	C	D
PK	156	114	120	126
PKA	164	100	124	124

PK 01
PKA 01



PK 01 - 156 x 196 x h / material
PKA 01-156 x 196 x h / material

17	1730
22	2312
27	2085

PK 11
PKA 11

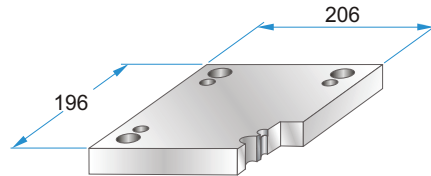
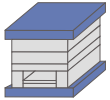

PK 11 - 156 x 196 x h / material
PKA 11-156 x 196 x h / material

17	1730
22	2312
27	2085

PK 02
PKA 02

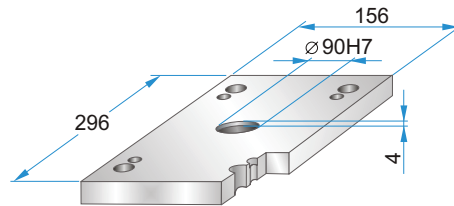

PK 02 - 156 x 196 x h / material
PKA 02-156 x 196 x h / material

22	1730
27	2312
	2085

PK 12
PKA 12

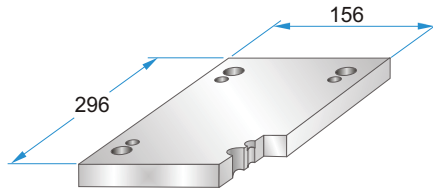

PK 12 - 156 x 196 x h / material
PKA 12-156 x 196 x h / material

22	1730
27	2312
	2085

PK 21
PKA 21

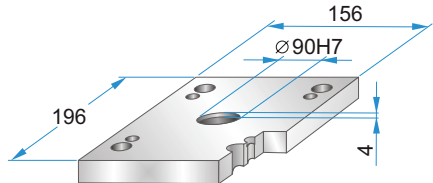

PK 21 - 156 x 196 x h / material
PKA 21-156 x 196 x h / material

17	1730
22	2312
27	2085

PK 22
PKA 22

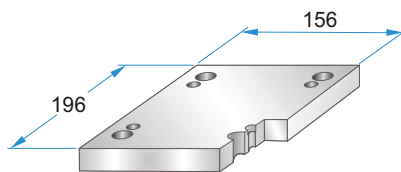
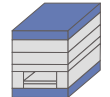

PK 22 - 156 x 196 x h / material
PKA 22-156 x 196 x h / material

17	1730
22	2312
27	2085

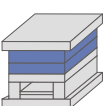

PK 03
PKA 03

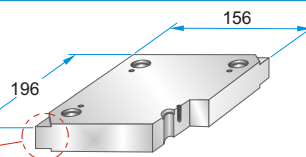

PK 35
PKA 35

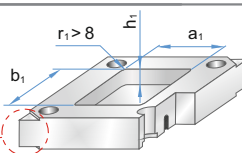

PK 03 - 156 x 196 x h / material
PKA 03-156 x 196 x h / material

PK 35 - 156 x 196 x h / material
PKA 35-156 x 196 x h / ($a_1/b_1/h_1/r_1$)

17	1730
22	2083
27	2085

36	2162
46	2311
56	2312
66	2738
76	Toolox33
86	Toolox44
96	2738HH
	2714HH

Material info



Corner undercuts upon request.
Podcięcia do demontażu na życzenie.
Abhebeecken erhältlich.
Доступно высвобождение на углах плит.

PK 31
PKA 31

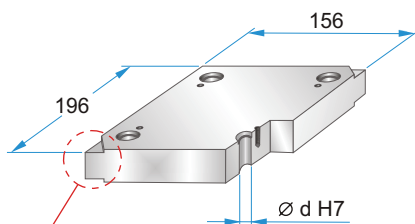
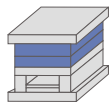

Corner undercuts upon request.
Podcięcia do demontażu na życzenie.
Abhebeecken erhältlich.
Доступно высвобождение на углах плит.



	d
PK 31	19,6
PKA 31	19,7

PK 31 - 156 x 196 x h /
PKA 31-156 x 196 x h / material

17	1730
22	2083
27	2085
36	2162
46	2311
56	2312
66	2343
76	2738
86	2767
	Toolox33
	Toolox44
	2738HH
	2714HH

Material info

PK 04
PKA 04

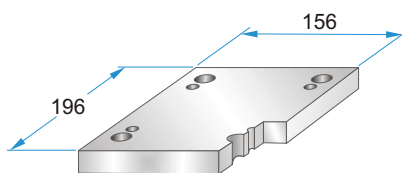
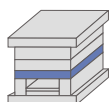

PK 04 - 156 x 196 x h /
PKA 04-156 x 196 x h / material

17	1730
22	2312
27	2085
36	
46	
56	
66	

PK 05
PKA 05

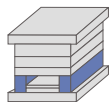

	A	B
PK 05	32	92
PKA 05	29	98

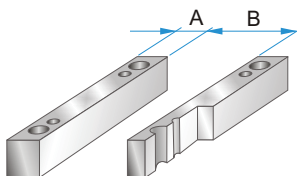

PK 05 - 156 x 196 x h /
PKA 05-156 x 196 x h / material

46	1730
56	2085
66	
76	
86	
96	

PK 55
PKA 55

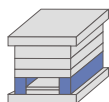

PK 06
PKA 06

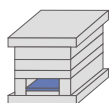

	A	B	C
PK 06	140	68	90
PKA 06	120	70	96

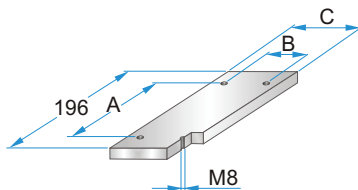

PK 06 - 156 x 196 x h /
PKA 06-156 x 196 x h / material

9	1730
	2085

PK 65
PKA 65

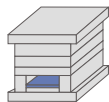

PK 07
PKA 07

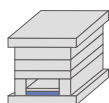

	A	B	C	D	M
PK 07	140	68	90	172	M4
PKA 07	120	70	96	170	M5

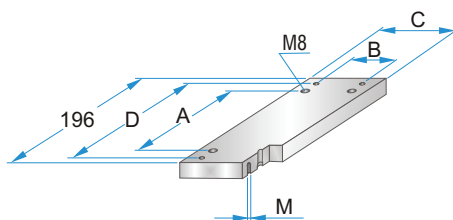

PK 07 - 156 x 196 x h /
PKA 07-156 x 196 x h / material

17	1730
	2312
	2085

PK 75
PKA 75

