

Dimensions and tolerances  
Wymiary i tolerancje  
Abmessungen und Toleranzen  
Размеры и допуски



	A	B	C
<b>PK</b>	692	574	642
<b>PKA</b>	708	590	658

**PK 01**  
**PKA 01**



**PK 11**  
**PKA 11**

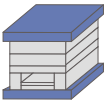

	W
PK 11	846
PKA 11	796

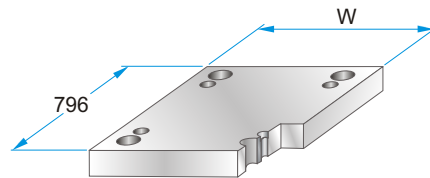

PK 11 - 746 x 796 x h /	material
PKA 11-746 x 796 x h /	
46	1730
76	2312
	2085

**PK 02**  
**PKA 02**

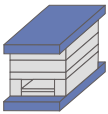

**PK 12**  
**PKA 12**

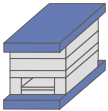

**PK 21**  
**PKA 21**

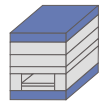

**PK 22**  
**PKA 22**

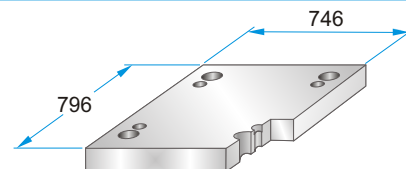
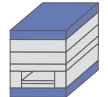

PK 22 - 746 x 796 x h /	material
PKA 22-746 x 796 x h /	
46	1730
56	2312
	2085

**PK 03**  
**PKA 03**

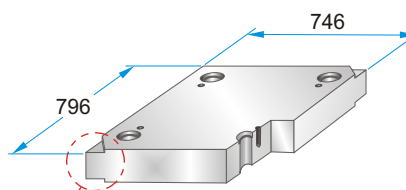
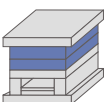

PK 03 - 746 x 796 x h /	material
PKA 03-746 x 796 x h /	
27	1730
36	2083
46	2085
56	2162
66	2311
76	2312
86	2738
96	Toolox33
116	Toolox44
136	2738HH
156	2714HH
176	
196	

Corner undercuts upon request.  
Podcięcia do demontażu na życzenie.  
Abhebeecken erhältlich.  
Доступно высвобождение на углах плит.



Material info



## PK 31

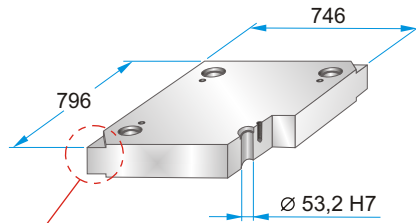
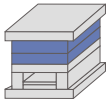

Corner undercuts upon request.  
Podcięcia do demontażu na życzenie.  
Abhebecken erhältlich.  
Доступно высвобождение на углах плит.



### PK 31 - 746 x 796 x h / material

46	1730
56	2083
66	2085
76	2162
86	2311
96	2312
116	2343
136	2738
156	2767
176	Toolox33
196	Toolox44
	2738HH
	2714HH

Material info

## PK 04 PKA 04

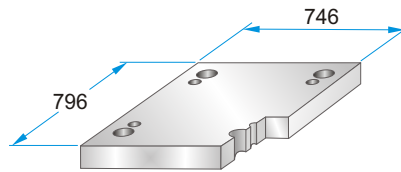
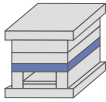

### PK 04 - 746 x 796 x h / PKA 04-746 x 796 x h / material

46	1730
56	2312
76	2085

## PK 05 PKA 05

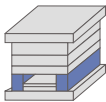

	A	B	M
PK 05	84	578	----
PKA 05	76	594	M12

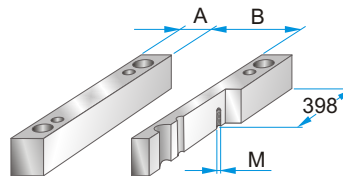

### PK 05 - 746 x 796 x h / PKA 05-746 x 796 x h / material

86	1730
96	2085
116	
136	
156	
176	

## PK 55 PKA 55

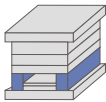

	A	B	M
PK 55	114	518	----
PKA 55	106	534	M12

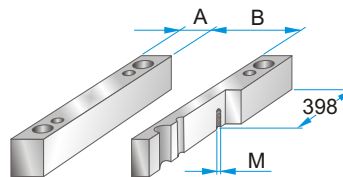

### PK 55 - 746 x 796 x h / PKA 55-746 x 796 x h / material

86	1730
96	2085
116	
136	
156	
176	

## PK 06 PKA 06

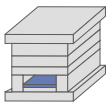

	A	B	C
PK 06	710	538	574
PKA 06	640	550	588

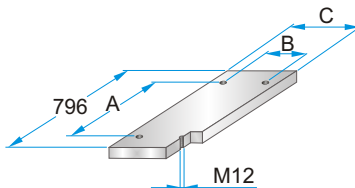

### PK 06 - 746 x 796 x h / PKA 06-746 x 796 x h / material

27	1730
	2085

## PK 65 PKA 65

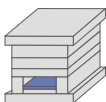

	A	B	C
PK 65	710	478	514
PKA 65	640	480	518

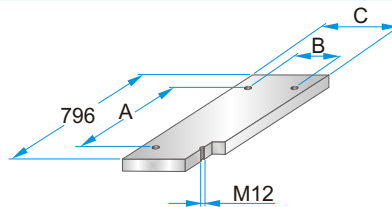

### PK 65 - 746 x 796 x h / PKA 65-746 x 796 x h / material

27	1730
	2085

## PK 07 PKA 07

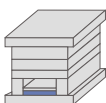

	A	B	C	D	M
PK 07	710	538	574	----	---
PKA 07	640	550	588	758	M5

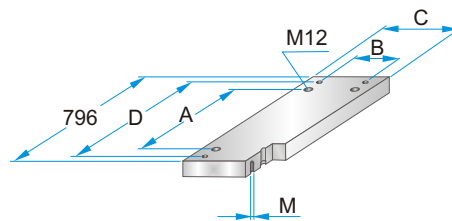

### PK 07 - 746 x 796 x h / PKA 07-746 x 796 x h / material

36	1730
46	2312
	2085

## PK 75 PKA 75

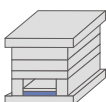

	A	B	C	D	M
PK 75	710	478	514	----	----
PKA 75	640	480	518	758	M5

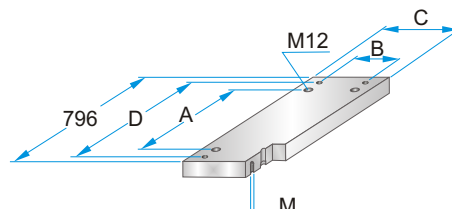

### PK 75 - 746 x 796 x h / PKA 75-746 x 796 x h / material

36	1730
46	2312
	2085