

Dimensions and tolerances  
Wymiary i tolerancje  
Abmessungen und Toleranzen  
Размеры и допуски



	A	B	C
<b>PK</b>	792	674	542
<b>PKA</b>	808	690	558

**PK 01**  
**PKA 01**



**PK 11**  
**PKA 11**

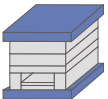

	W
PK 11	746
PKA 11	696

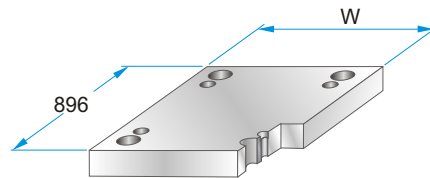

PK 11 - 646 x 896 x h /	material
PKA 11-646 x 896 x h /	
46	1730
56	2312
	2085

**PK 02**  
**PKA 02**

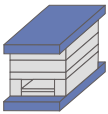

**PK 12**  
**PKA 12**

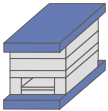

**PK 21**  
**PKA 21**

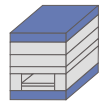

**PK 22**  
**PKA 22**

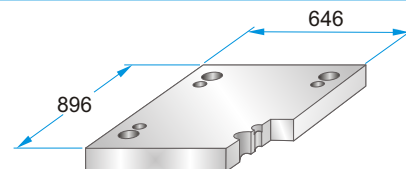
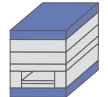

PK 22 - 646 x 896 x h /	material
PKA 22-646 x 896 x h /	
46	1730
56	2312
	2085

**PK 03**  
**PKA 03**

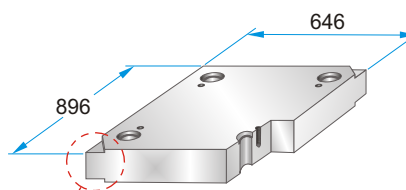
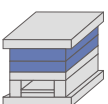

PK 03 - 646 x 896 x h /	material
PKA 03-646 x 896 x h /	

27	1730
36	2083
46	2085
56	2162
66	2311
76	2312
86	2738
96	Toolox33
116	Toolox44
136	2738HH
156	2714HH
176	
196	

Corner undercuts upon request.  
Podcięcia do demontażu na życzenie.  
Abhebeecken erhältlich.  
Доступно высвобождение на углах плит.



Material info



## PK 31

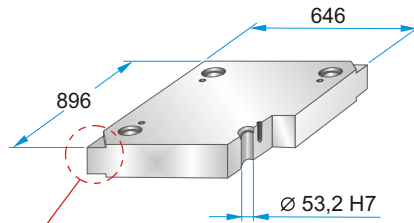
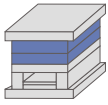

Corner undercuts upon request.  
Podcięcia do demontażu na życzenie.  
Abhebecken erhältlich.  
Доступно высвобождение на углах плит.



PK 31 - 646 x 896 x h / material

46	1730
56	2083
66	2085
76	2162
86	2311
96	2312
116	2343
136	2738
156	2767
176	Toolox33
196	Toolox44
	2738HH
	2714HH

Material info

## PK 04 PKA 04

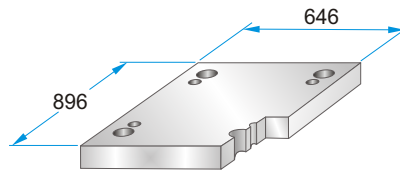
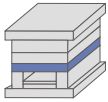

PK 04 - 646 x 896 x h /  
PKA 04-646 x 896 x h / material

46	1730
56	2312
76	2085

## PK 05 PKA 05

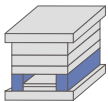

	A	B	M
PK 05	84	478	----
PKA 05	76	494	M12

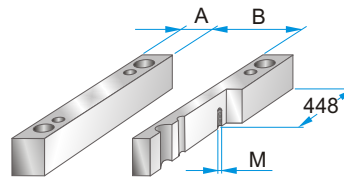

PK 05 - 646 x 896 x h /  
PKA 05-646 x 896 x h / material

86	1730
96	2085
116	
136	
156	
176	

## PK 55 PKA 55

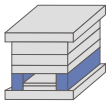

	A	B	M
PK 55	114	418	----
PKA 55	106	434	M12

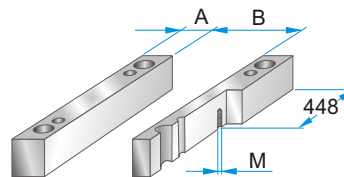

PK 55 - 646 x 896 x h /  
PKA 55-646 x 896 x h / material

86	1730
96	2085
116	
136	
156	
176	

## PK 06 PKA 06

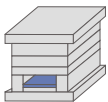

	A	B	C
PK 06	810	438	474
PKA 06	740	450	488

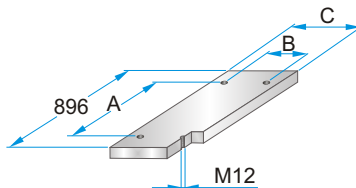

PK 06 - 646 x 896 x h /  
PKA 06-646 x 896 x h / material

27	1730
	2085

## PK 65 PKA 65

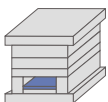

	A	B	C
PK 65	810	378	414
PKA 65	740	380	418

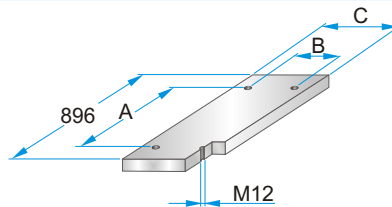

PK 65 - 646 x 896 x h /  
PKA 65-646 x 896 x h / material

27	1730
	2085

## PK 07 PKA 07

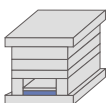

	A	B	C	D	M
PK 07	810	438	474	----	---
PKA 07	740	450	488	858	M5

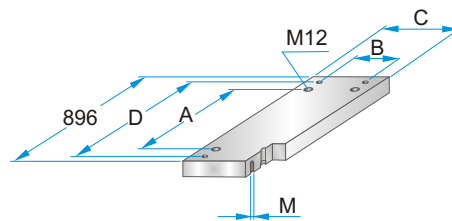

PK 07 - 646 x 896 x h /  
PKA 07-646 x 896 x h / material

36	1730
	2312
	2085

## PK 75 PKA 75

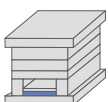

	A	B	C	D	M
PK 75	810	378	414	----	----
PKA 75	740	380	418	858	M5

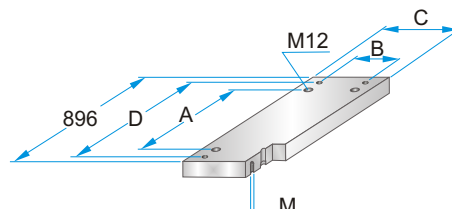

PK 75 - 646 x 896 x h /  
PKA 75-646 x 896 x h / material

36	1730
	2312
	2085