

Dimensions and tolerances
Wymiary i tolerancje
Abmessungen und Toleranzen
Размеры и допуски



	A	B	C	d	d2
PK	524	430	524	42	M16
PKA	508	390	508	54	M20

PK 01
PKA 01



	W
PK 01	696
PKA 01	646

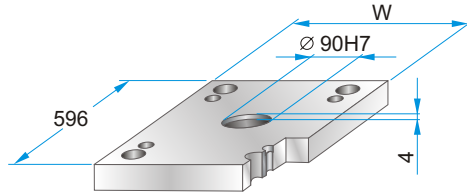

PK 01 - 596 x 596 x h /	PKA 01-596 x 596 x h /	material
	46	1730
	56	2312
		2085

PK 11
PKA 11

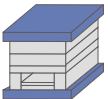

	W
PK 11	696
PKA 11	646

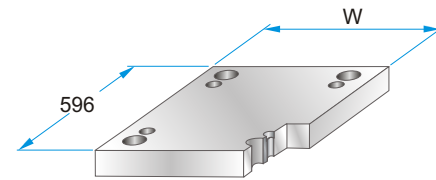

PK 11 - 596 x 596 x h /	PKA 11-596 x 596 x h /	material
	46	1730
	56	2312
		2085

PK 02
PKA 02

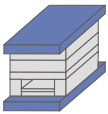

PK 12
PKA 12

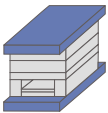

PK 21
PKA 21

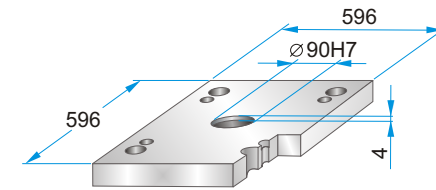

PK 21 - 596 x 596 x h /	PKA 21-596 x 596 x h /	material
	36	1730
	46	2312
		2085

PK 22
PKA 22

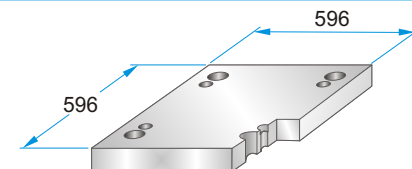
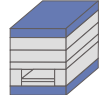

PK 22 - 596 x 596 x h /	PKA 22-596 x 596 x h /	material
	36	1730
	46	2312
		2085

PK 03
PKA 03

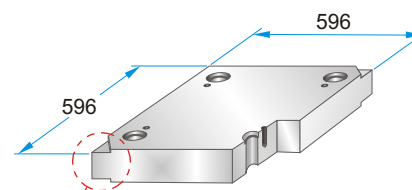
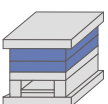

PK 03 - 596 x 596 x h /	PKA 03-596 x 596 x h /	material
	27	1730
	36	2083
	46	2085
	56	2162
	66	2311
	76	2312
	86	2738
	96	Toolox33
	116	Toolox44
	136	2738HH
	156	2714HH
	176	
	196	

Corner undercuts upon request.
Podcięcia do demontażu na życzenie.
Abhebeecken erhältlich.
Доступно высвобождение на углах плит.



Material info



PK 31

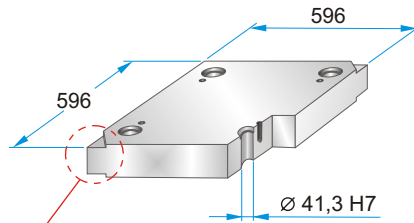
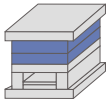

Corner undercuts upon request.
Podcięcia do demontażu na życzenie.
Abhebecken erhältlich.
Доступно высвобождение на углах плит.



PK 31 - 596 x 596 x h / material

36	1730
46	2083
56	2085
66	2162
76	2311
86	2312
96	2343
116	2738
136	2767
156	Toolox33
176	Toolox44
196	2738HH
	2714HH

Material info

PK 04 PKA 04

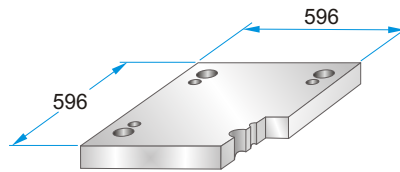
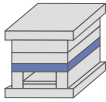

PK 04 - 596 x 596 x h /
PKA 04-596 x 596 x h / material

46	1730
56	2312
76	2085

PK 05 PKA 05

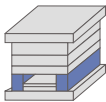

	A	B	M
PK 05	62	472	----
PKA 05	76	444	M12

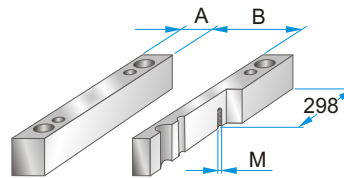

PK 05 - 596 x 596 x h /
PKA 05-596 x 596 x h / material

66	1730
76	2085
86	
96	
116	
136	
156	
176	

PK 55 PKA 55

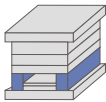

	A	B	M
PK 55	92	412	----
PKA 55	106	384	M12

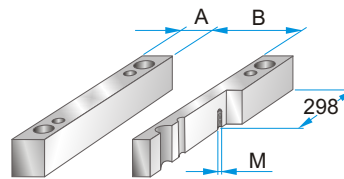

PK 55 - 596 x 596 x h /
PKA 55-596 x 596 x h / material

66	1730
76	2085
86	
96	
116	
136	
156	
176	

PK 06 PKA 06

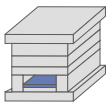

	A	B	C
PK 06	514	436	468
PKA 06	440	400	438

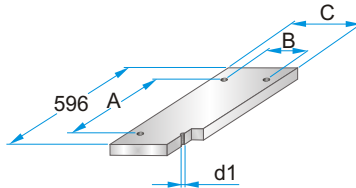

PK 06 - 596 x 596 x h /
PKA 06-596 x 596 x h / material

	d1
PK 06	M10
PKA 06	M12

27	1730
	2085

PK 65 PKA 65

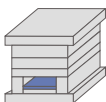

	A	B	C
PK 65	514	376	408
PKA 65	440	330	368

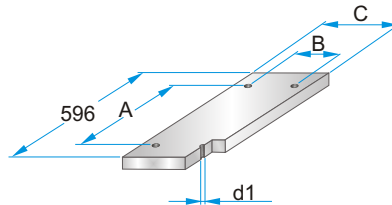

PK 65 - 596 x 596 x h /
PKA 65-596 x 596 x h / material

	d1
PK 65	M10
PKA 65	M12

27	1730
	2085

PK 07 PKA 07

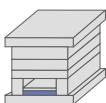

	A	B	C	D	M
PK 07	514	436	468	564	M4
PKA 07	440	400	438	558	M5

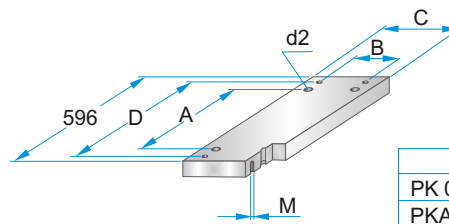

PK 07 - 596 x 596 x h /
PKA 07-596 x 596 x h / material

	d2
PK 07	M10
PKA 07	M12

36	1730
	2312
	2085

PK 75 PKA 75

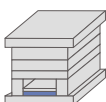

	A	B	C	D	M
PK 75	514	376	408	564	M4
PKA 75	440	330	368	558	M5

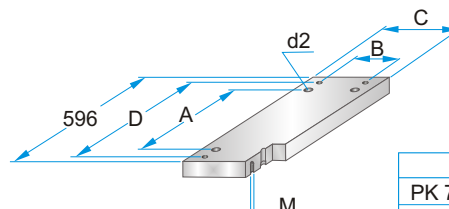

PK 75 - 596 x 596 x h /
PKA 75-596 x 596 x h / material

	d2
PK 75	M10
PKA 75	M12

36	1730
	2312
	2085