

Dimensions and tolerances
Wymiary i tolerancje
Abmessungen und Toleranzen
Размеры и допуски

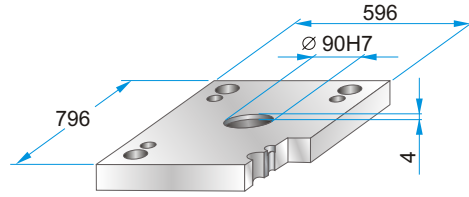

	A	B	C
PK	692	574	442
PKA	708	590	458

PKA 01



PKA 01-546 x 796 x h / material

46	1730
	2312
	2085

PK 11 PKA 11

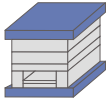

	W
PK 11	646
PKA 11	596

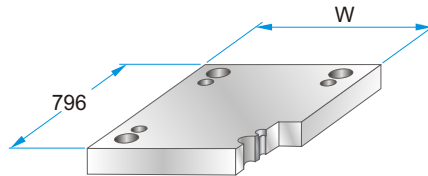

PK 11 - 546 x 796 x h /
PKA 11-546 x 796 x h / material

46	1730
56	2312
	2085

PK 02 PKA 02



PK 12 PKA 12



PKA 21

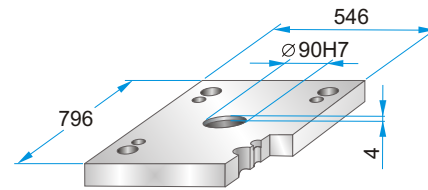

PKA 21-546 x 796 x h / material

46	1730
	2312
	2085

PK 22 PKA 22

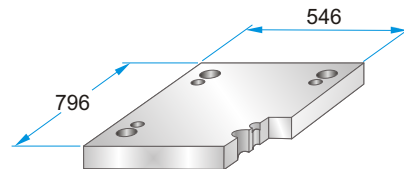
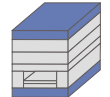

PK 22 - 546 x 796 x h /
PKA 22-546 x 796 x h / material

46	1730
56	2312
	2085

PK 03 PKA 03

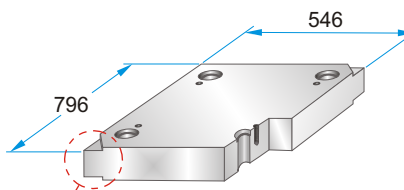
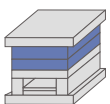

PK 03 - 546 x 796 x h /
PKA 03-546 x 796 x h / material

27	1730
36	2083
46	2085
56	2162
66	2311
76	2312
86	2738
96	Toolox33
116	Toolox44
136	2738HH
156	2714HH
176	
196	

Corner undercuts upon request.
Podcięcia do demontażu na życzenie.
Abhebeecken erhältlich.
Доступно высвобождение на углах плит.



Material info



PK 31

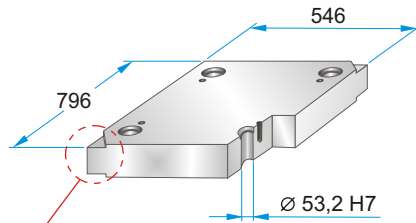
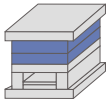

Corner undercuts upon request.
Podcięcia do demontażu na życzenie.
Abhebecken erhältlich.
Доступно высвобождение на углах плит.



PK 31 - 546 x 796 x h / material

46	1730
56	2083
66	2085
76	2162
86	2311
96	2312
116	2343
136	2738
156	2767
176	Toolox33
196	Toolox44
	2738HH
	2714HH

Material info

PK 04 PKA 04

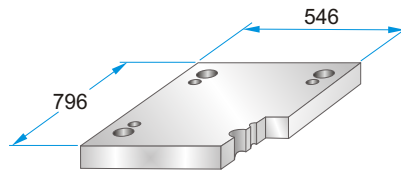
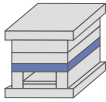

PK 04 - 546 x 796 x h / PKA 04-546 x 796 x h / material

46	1730
56	2312
76	2085

PK 05 PKA 05

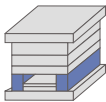

	A	B	M
PK 05	84	378	----
PKA 05	76	394	M12

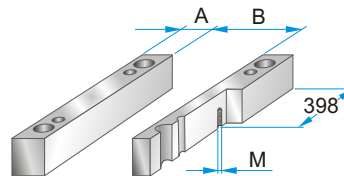

PK 05 - 546 x 796 x h / PKA 05-546 x 796 x h / material

86	1730
96	2085
116	
136	
156	
176	

PK 55 PKA 55

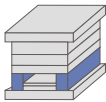

	A	B	M
PK 55	114	318	----
PKA 55	106	334	M12

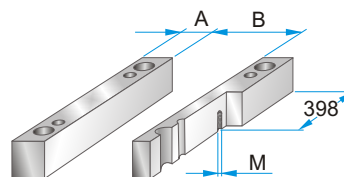

PK 55 - 546 x 796 x h / PKA 55-546 x 796 x h / material

86	1730
96	2085
116	
136	
156	
176	

PK 06 PKA 06

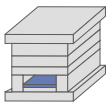

	A	B	C
PK 06	710	338	374
PKA 06	640	350	388

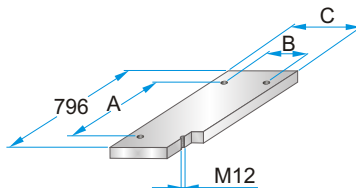

PK 06 - 546 x 796 x h / PKA 06-546 x 796 x h / material

27	1730
	2085

PK 65 PKA 65

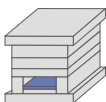

	A	B	C
PK 65	710	278	314
PKA 65	640	280	318

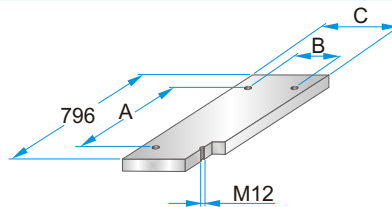

PK 65 - 546 x 796 x h / PKA 65-546 x 796 x h / material

27	1730
	2085

PK 07 PKA 07

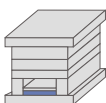

	A	B	C	D	M
PK 07	710	338	374	----	---
PKA 07	640	350	388	758	M5

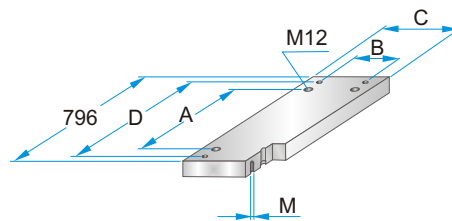

PK 07 - 546 x 796 x h / PKA 07-546 x 796 x h / material

36	1730
	2312
	2085

PK 75 PKA 75

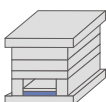

	A	B	C	D	M
PK 75	710	278	314	----	----
PKA 75	640	280	318	758	M5

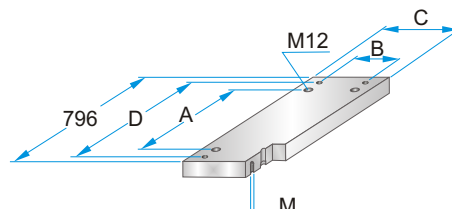

PK 75 - 546 x 796 x h / PKA 75-546 x 796 x h / material

36	1730
	2312
	2085