

Dimensions and tolerances
Wymiary i tolerancje
Abmessungen und Toleranzen
Размеры и допуски



	A	B	C	d	d2
PK	574	480	474	42	M16
PKA	558	440	458	54	M20

PK 01
PKA 01



	W
PK 01	646
PKA 01	596

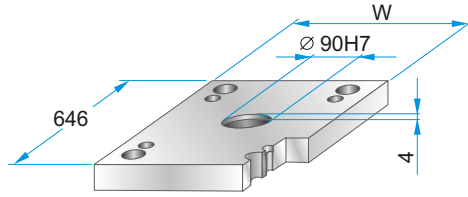

PK 01 - 546 x 646 x h / material

PKA 01-546 x 646 x h /	46	1730
	56	2312
		2085

PK 11
PKA 11



	W
PK 11	646
PKA 11	596

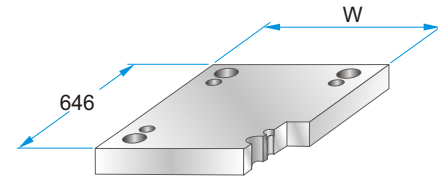

PK 11 - 546 x 646 x h / material

PKA 11-546 x 646 x h /	46	1730
	56	2312
		2085

PK 02
PKA 02



PK 12
PKA 12

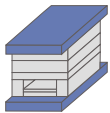

PK 21
PKA 21

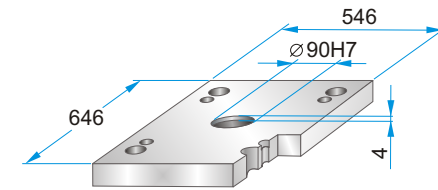

PK 21 - 546 x 646 x h / material

PKA 21-546 x 646 x h /	36	1730
	46	2312
		2085

PK 22
PKA 22

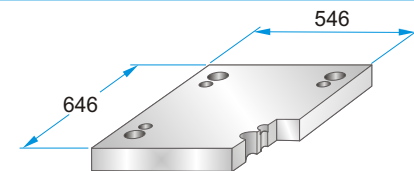
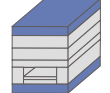

PK 22 - 546 x 646 x h / material

PKA 22-546 x 646 x h /	36	1730
	46	2312
		2085

PK 03
PKA 03

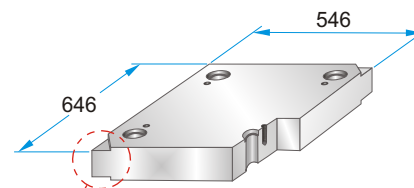
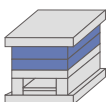

PK 03 - 546 x 646 x h / material

	27	1730
	36	2083
	46	2085
	56	2162
	66	2311
	76	2312
	86	2738
	96	Toolox33
	116	Toolox44
	136	2738HH
	156	2714HH
	176	
	196	

Corner undercuts upon request.
Podcięcia do demontażu na życzenie.
Abhebeecken erhältlich.
Доступно высвобождение на углах плит.



Material info



PK 31

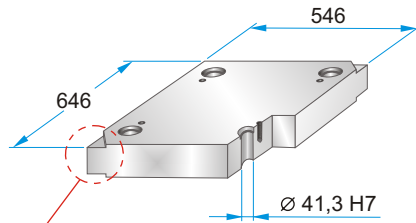
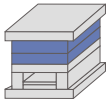

Corner undercuts upon request.
Podcięcia do demontażu na życzenie.
Abhebecken erhältlich.
Доступно высвобождение на углах плит.



PK 31 - 546 x 646 x h / material

36	1730
46	2083
56	2085
66	2162
76	2311
86	2312
96	2343
116	2738
136	2767
156	Toolox33
176	Toolox44
196	2738HH
	2714HH

Material info

PK 04 PKA 04

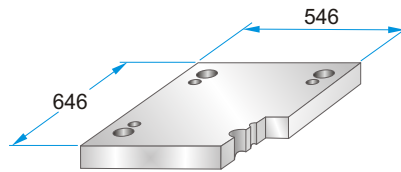
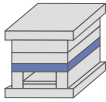

PK 04 - 546 x 646 x h /
PKA 04-546 x 646 x h / material

46	1730
56	2312
76	2085

PK 05 PKA 05

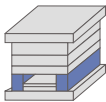

	A	B	M
PK 05	62	422	----
PKA 05	76	394	M12

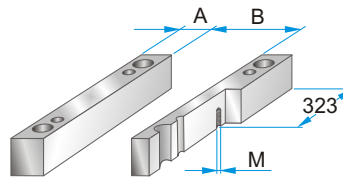

PK 05 - 546 x 646 x h /
PKA 05-546 x 646 x h / material

76	1730
86	2085
96	
116	
136	
156	
176	

PK 55 PKA 55

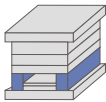

	A	B	M
PK 55	92	362	----
PKA 55	106	334	M12

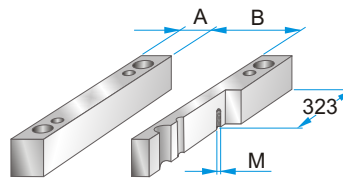

PK 55 - 546 x 646 x h /
PKA 55-546 x 646 x h / material

76	1730
86	2085
96	
116	
136	
156	
176	

PK 06 PKA 06

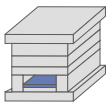

	A	B	C
PK 06	564	386	418
PKA 06	490	350	388

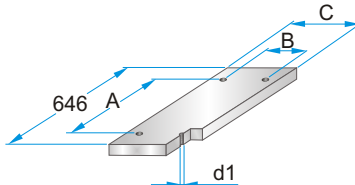

PK 06 - 546 x 646 x h /
PKA 06-546 x 646 x h / material

27	1730
	2085

	d1
PK 06	M10
PKA 06	M12

PK 65 PKA 65

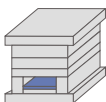

	A	B	C
PK 65	564	326	358
PKA 65	490	280	318

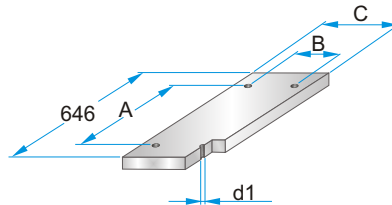

PK 65 - 546 x 646 x h /
PKA 65-546 x 646 x h / material

27	1730
	2085

	d1
PK 65	M10
PKA 65	M12

PK 07 PKA 07

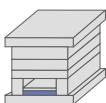

	A	B	C	D	M
PK 07	564	386	418	614	M4
PKA 07	490	350	388	608	M5

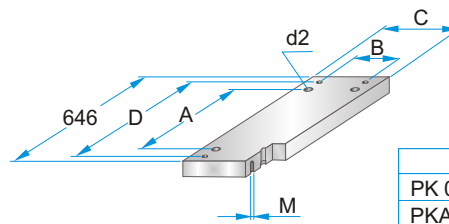

PK 07 - 546 x 646 x h /
PKA 07-546 x 646 x h / material

36	1730
	2312
	2085

	d2
PK 07	M10
PKA 07	M12

PK 75 PKA 75

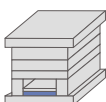

	A	B	C	D	M
PK 75	564	326	358	614	M4
PKA 75	490	280	318	608	M5

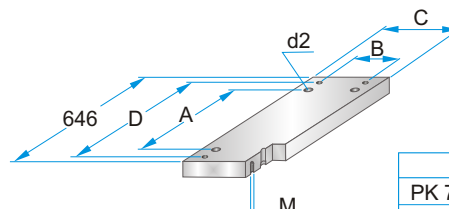

PK 75 - 546 x 646 x h /
PKA 75-546 x 646 x h / material

36	1730
	2312
	2085

	d2
PK 75	M10
PKA 75	M12