

Dimensions and tolerances  
Wymiary i tolerancje  
Abmessungen und Toleranzen  
Размеры и допуски

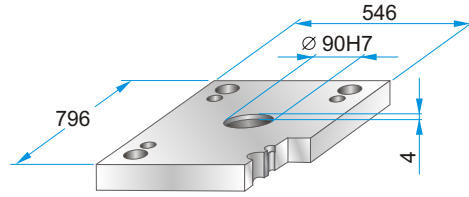

|            | A   | B   | C   |
|------------|-----|-----|-----|
| <b>PK</b>  | 692 | 574 | 392 |
| <b>PKA</b> | 708 | 590 | 408 |

## PKA 01

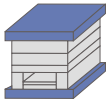

PKA 01-496 x 796 x h / material

|    |      |
|----|------|
| 46 | 1730 |
|    | 2312 |
|    | 2085 |

## PK 11 PKA 11

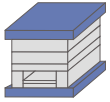

|        | W   |
|--------|-----|
| PK 11  | 596 |
| PKA 11 | 546 |

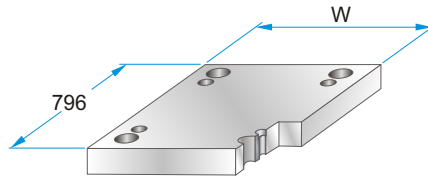

PK 11 - 496 x 796 x h /  
PKA 11-496 x 796 x h / material

|    |      |
|----|------|
| 46 | 1730 |
| 56 | 2312 |
|    | 2085 |

## PK 02 PKA 02



## PK 12 PKA 12

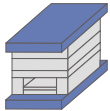

## PKA 21

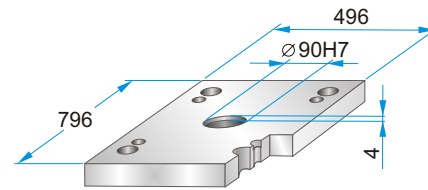
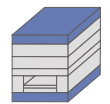

PKA 21-496 x 796 x h / material

|    |      |
|----|------|
| 46 | 1730 |
|    | 2312 |
|    | 2085 |

## PK 22 PKA 22

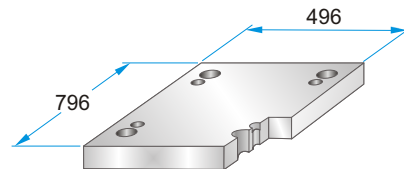

PK 22 - 496 x 796 x h /  
PKA 22-496 x 796 x h / material

|    |      |
|----|------|
| 46 | 1730 |
|    | 2312 |
|    | 2085 |

## PK 03 PKA 03

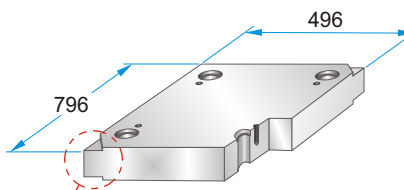
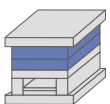

PK 03 - 496 x 796 x h /  
PKA 03-496 x 796 x h / material

|     |          |
|-----|----------|
| 27  | 1730     |
| 36  | 2083     |
| 46  | 2085     |
| 56  | 2162     |
| 66  | 2311     |
| 76  | 2312     |
| 86  | 2738     |
| 96  | Toolox33 |
| 116 | Toolox44 |
| 136 | 2738HH   |
| 156 | 2714HH   |
| 176 |          |
| 196 |          |

Corner undercuts upon request.  
Podcięcia do demontażu na życzenie.  
Abhebeecken erhältlich.  
Доступно высвобождение на углах плит.



Material info



## PK 31

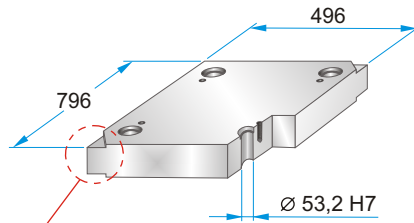
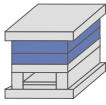

Corner undercuts upon request.  
Podcięcia do demontażu na życzenie.  
Abhebeecken erhältlich.  
Доступно высвобождение на углах плит.



PK 31 - 496 x 796 x h / material

|     |          |
|-----|----------|
| 36  | 1730     |
| 46  | 2083     |
| 56  | 2085     |
| 66  | 2162     |
| 76  | 2311     |
| 86  | 2312     |
| 96  | 2343     |
| 116 | 2738     |
| 136 | 2767     |
| 156 | Toolox33 |
| 176 | Toolox44 |
| 196 | 2738HH   |
|     | 2714HH   |

Material info

## PK 04 PKA 04

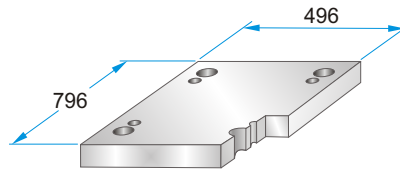
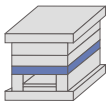

PK 04 - 496 x 796 x h /  
PKA 04-496 x 796 x h / material

|    |      |
|----|------|
| 46 | 1730 |
| 56 | 2312 |
| 76 | 2085 |

## PK 05 PKA 05

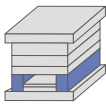

|        | A  | B   | M    |
|--------|----|-----|------|
| PK 05  | 84 | 328 | ---- |
| PKA 05 | 76 | 344 | M12  |

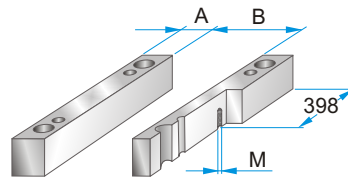

PK 05 - 496 x 796 x h /  
PKA 05-496 x 796 x h / material

|     |      |
|-----|------|
| 86  | 1730 |
| 96  | 2085 |
| 116 |      |
| 136 |      |
| 156 |      |
| 176 |      |

## PK 55

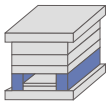

|       | A   | B   |
|-------|-----|-----|
| PK 55 | 114 | 268 |

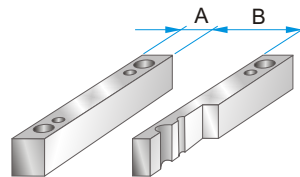

PK 55 - 496 x 796 x h / material

|     |      |
|-----|------|
| 96  | 1730 |
| 116 | 2085 |
| 136 |      |
| 156 |      |

## PK 06 PKA 06

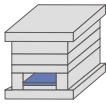

|        | A   | B   | C   |
|--------|-----|-----|-----|
| PK 06  | 710 | 288 | 324 |
| PKA 06 | 640 | 300 | 338 |

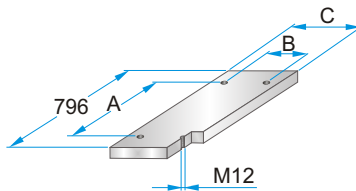

PK 06 - 496 x 796 x h /  
PKA 06-496 x 796 x h / material

|    |      |
|----|------|
| 27 | 1730 |
|    | 2085 |

## PK 65

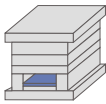

|       | A   | B   | C   |
|-------|-----|-----|-----|
| PK 65 | 710 | 228 | 264 |

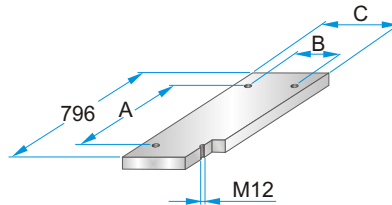

PK 65 - 496 x 796 x h / material

|    |      |
|----|------|
| 27 | 1730 |
|    | 2085 |

## PK 07 PKA 07

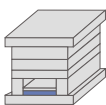

|        | A   | B   | C   | D    | M    |
|--------|-----|-----|-----|------|------|
| PK 07  | 710 | 288 | 324 | ---- | ---- |
| PKA 07 | 640 | 300 | 338 | 758  | M5   |

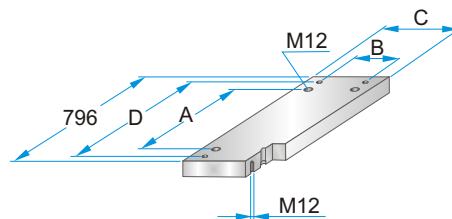

PK 07 - 496 x 796 x h /  
PKA 07-496 x 796 x h / material

|    |      |
|----|------|
| 36 | 1730 |
|    | 2312 |
|    | 2085 |

## PK 75

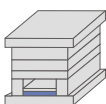

|       | A   | B   | C   |
|-------|-----|-----|-----|
| PK 75 | 710 | 228 | 264 |

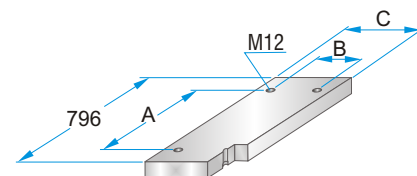

PK 75 - 496 x 796 x h / material

|    |      |
|----|------|
| 36 | 1730 |
|    | 2312 |
|    | 2085 |