

Dimensions and tolerances  
Wymiary i tolerancje  
Abmessungen und Toleranzen  
Размеры и допуски

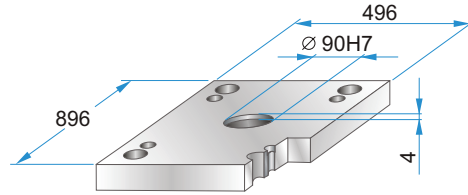

	A	B	C
<b>PK</b>	824	730	374
<b>PKA</b>	824	730	374

## PKA 01



PKA 01-446 x 896 x h / material

46	1730
	2312
	2085

## PK 11 PKA 11



	W
PK 11	546
PKA 11	496

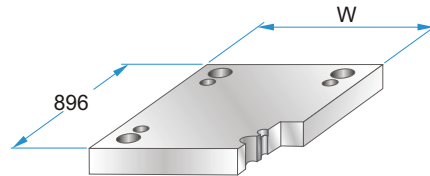

PK 11 - 446 x 896 x h / material  
PKA 11-446 x 896 x h / material

46	1730
56	2312
	2085

## PK 02 PKA 02

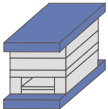

## PK 12 PKA 12

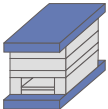

## PKA 21

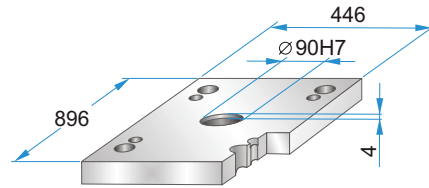
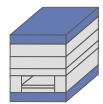

PKA 21-446 x 896 x h / material

46	1730
	2312
	2085

## PK 22 PKA 22

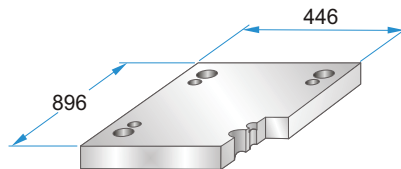

PK 22 - 446 x 896 x h / material  
PKA 22-446 x 896 x h / material

36	1730
46	2312
	2085

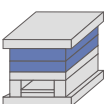

## PK 03 PKA 03

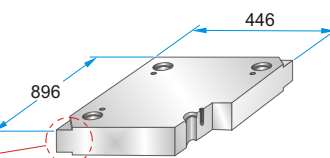

## PK 35 PKA 35

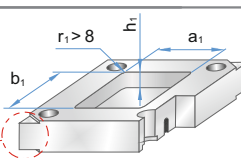

PK 03 - 446 x 896 x h / material  
PKA 03-446 x 896 x h / material

PK 35 - 446 x 896 x h / material  
PKA 35-446 x 896 x h / (a1/b1/h1/r1)

27	1730
36	2083
46	2085
56	2162
66	2311
76	2312
86	2738
96	Toolox33
116	Toolox44
136	2738HH
156	2714HH
176	

Material info



Corner undercuts upon request.  
Podcięcia do demontażu na życzenie.  
Abhebeecken erhältlich.  
Доступно высвобождение на углах плит.

## PK 31

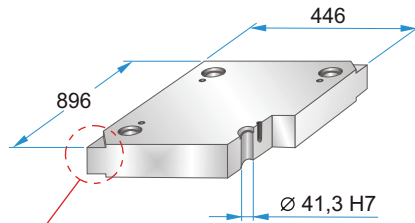
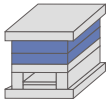

Corner undercuts upon request.  
Podcięcia do demontażu na życzenie.  
Abhebecken erhältlich.  
Доступно высвобождение на углах плит.



PK 31 - 446 x 896 x h / material

36	1730
46	2083
56	2085
66	2162
76	2311
86	2312
96	2343
116	2738
136	2767
156	Toolox33
	Toolox44
	2738HH
	2714HH

Material info

## PK 04 PKA 04

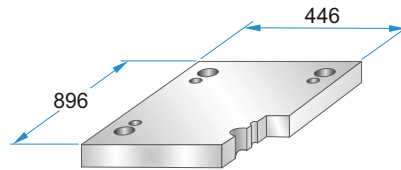
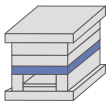

PK 04 - 446 x 896 x h /  
PKA 04-446 x 896 x h / material

46	1730
56	2312
	2085

## PK 05 PKA 05

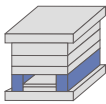

	A	B	M
PK 05	62	322	----
PKA 05	62	322	M10

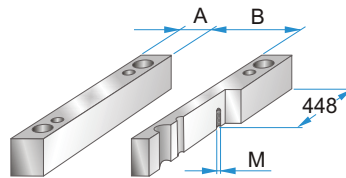

PK 05 - 446 x 896 x h /  
PKA 05-446 x 896 x h / material

76	1730
86	2085
96	
116	
136	
156	

## PK 55 PKA 55

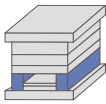

	A	B	M
PK 55	86	274	----
PKA 55	86	274	M10

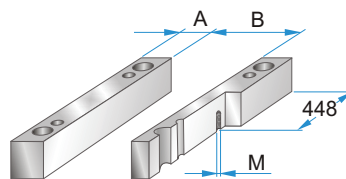

PK 55 - 446 x 896 x h /  
PKA 55-446 x 896 x h / material

76	1730
86	2085
96	
116	
136	
156	

## PK 06 PKA 06

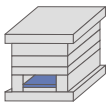

	A	B	C
PK 06	814	286	318
PKA 06	760	280	318

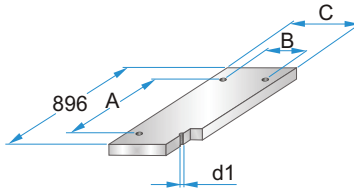

PK 06 - 446 x 896 x h /  
PKA 06-446 x 896 x h / material

27	1730
	2085

	d1
PK 06	M12
PKA 06	M10

## PK 65 PKA 65

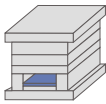

	A	B	C
PK 65	814	238	270
PKA 65	760	230	268

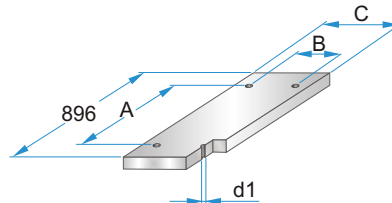

PK 65 - 446 x 896 x h /  
PKA 65-446 x 896 x h / material

27	1730
	2085

	d1
PK 65	M12
PKA 65	M10

## PK 07 PKA 07

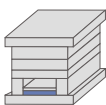

	A	B	C	D	M
PK 07	814	286	318	----	----
PKA 07	760	280	318	858	M5

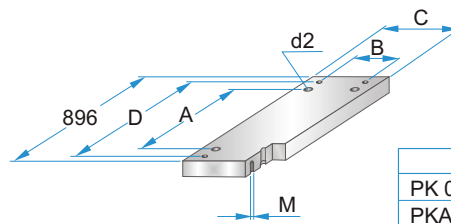

PK 07 - 446 x 896 x h /  
PKA 07-446 x 896 x h / material

36	1730
	2312
	2085

	d2
PK 07	M12
PKA 07	M10

## PK 75 PKA 75

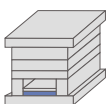

	A	B	C	D	M
PK 75	814	238	270	----	----
PKA 75	760	230	268	858	M5

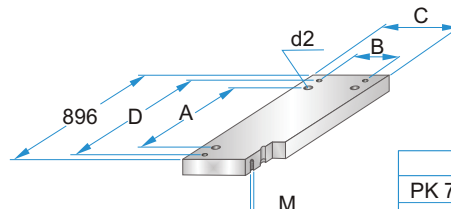

PK 75 - 446 x 896 x h /  
PKA 75-446 x 896 x h / material

36	1730
	2312
	2085

	d2
PK 75	M12
PKA 75	M10