

Dimensions and tolerances
Wymiary i tolerancje
Abmessungen und Toleranzen
Размеры и допуски



	A	B	C
PK	574	480	374
PKA	574	480	374

PK 01
PKA 01



	W
PK 01	546
PKA 01	496

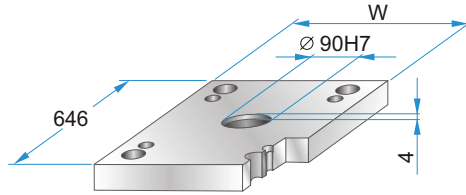

PK 01 - 446 x 646 x h /	PKA 01-446 x 646 x h /	material
36	1730	
46	2312	
56	2085	

PK 11
PKA 11



	W
PK 11	546
PKA 11	496

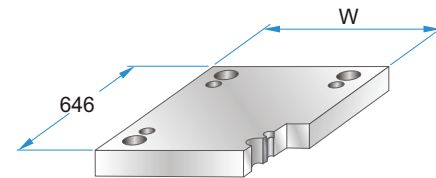

PK 11 - 446 x 646 x h /	PKA 11-446 x 646 x h /	material
36	1730	
46	2312	
56	2085	

PK 02
PKA 02

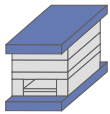

PK 12
PKA 12

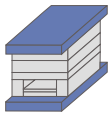

PK 21
PKA 21

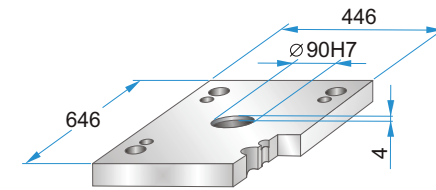

PK 21 - 446 x 646 x h /	PKA 21-446 x 646 x h /	material
36	1730	
46	2312	
56	2085	

PK 22
PKA 22

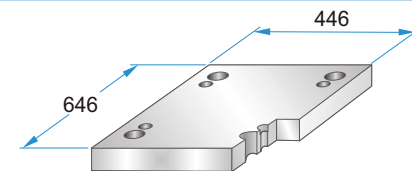

PK 22 - 446 x 646 x h /	PKA 22-446 x 646 x h /	material
36	1730	
46	2312	
56	2085	

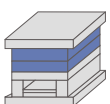

PK 03
PKA 03

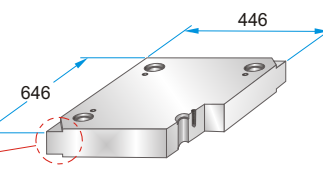

PK 35
PKA 35

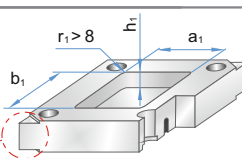

PK 03 - 446 x 646 x h /	PKA 03-446 x 646 x h /	material
27	1730	
36	2083	
46	2085	
56	2162	
66	2311	
76	2312	
86	2738	
96	Toolox33	
116	Toolox44	
136	2738HH	
156	2714HH	
176		

PK 35 - 446 x 646 x h /	PKA 35-446 x 646 x h /	material
		$(a_1/b_1/h_1/r_1)$

Corner undercuts upon request.
Podcięcia do demontażu na życzenie.
Abhebeecken erhältlich.
Доступно высвобождение на углах плит.

Material info



PK 31

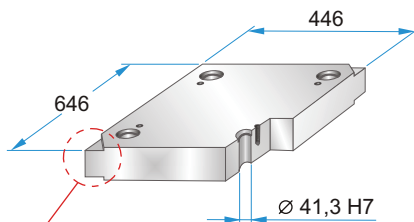
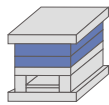

Corner undercuts upon request.
Podcięcia do demontażu na życzenie.
Abhebecken erhältlich.
Доступно высвобождение на углах плит.



PK 31 - 446 x 646 x h / material

36	1730
46	2083
56	2085
66	2162
76	2311
86	2312
96	2343
116	2738
136	2767
156	Toolox33
176	Toolox44
	2738HH
	2714HH

Material info

PK 04 PKA 04

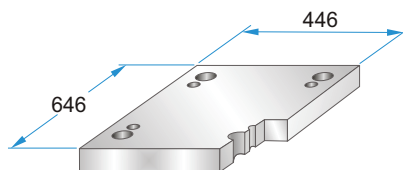
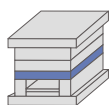

PK 04 - 446 x 646 x h /
PKA 04-446 x 646 x h / material

46	1730
56	2312
66	2085
76	

PK 05 PKA 05

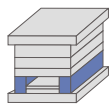

	A	B	M
PK 05	62	322	----
PKA 05	62	322	M10

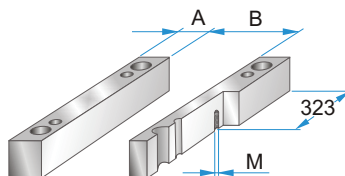

PK 05 - 446 x 646 x h /
PKA 05-446 x 646 x h / material

76	1730
86	2085
96	
116	
136	
156	

PK 55 PKA 55

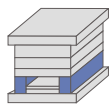

	A	B	M
PK 55	86	274	----
PKA 55	86	274	M10

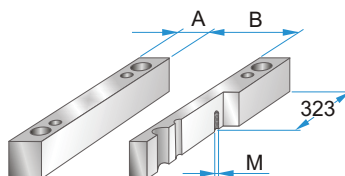

PK 55 - 446 x 646 x h /
PKA 55-446 x 646 x h / material

76	1730
86	2085
96	
116	
136	
156	

PK 06 PKA 06

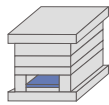

	A	B	C
PK 06	564	286	318
PKA 06	510	280	318

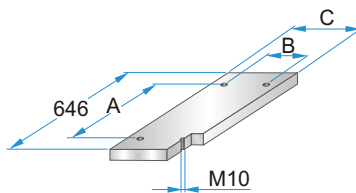

PK 06 - 446 x 646 x h /
PKA 06-446 x 646 x h / material

27	1730
	2085

PK 65 PKA 65

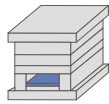

	A	B	C
PK 65	564	238	270
PKA 65	510	230	268

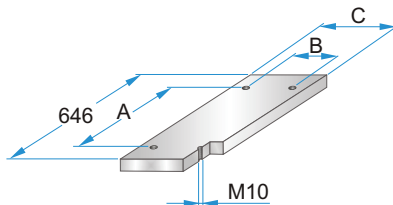

PK 65 - 446 x 646 x h /
PKA 65-446 x 646 x h / material

27	1730
	2085

PK 07 PKA 07

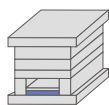

	A	B	C	D	M
PK 07	564	286	318	614	M4
PKA 07	510	280	318	608	M5

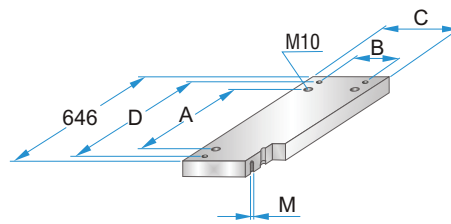

PK 07 - 446 x 646 x h /
PKA 07-446 x 646 x h / material

36	1730
	2312
	2085

PK 75 PKA 75

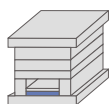

	A	B	C	D	M
PK 75	564	238	270	614	M4
PKA 75	510	230	268	608	M5

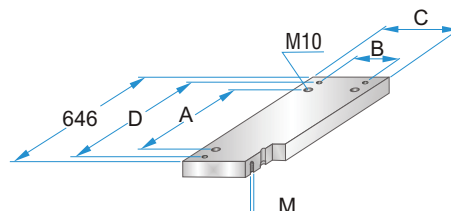

PK 75 - 446 x 646 x h /
PKA 75-446 x 646 x h / material

36	1730
	2312
	2085