

Dimensions and tolerances  
Wymiary i tolerancje  
Abmessungen und Toleranzen  
Размеры и допуски



	A	B	C
<b>PK</b>	524	430	374
<b>PKA</b>	524	430	374

**PK 01**  
**PKA 01**



	W
PK 01	546
PKA 01	496

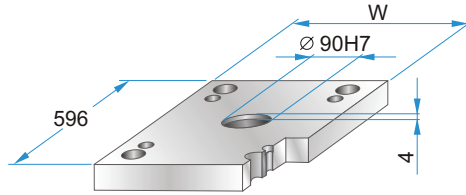

PK 01 - 446 x 596 x h /	PKA 01-446 x 596 x h /	material
36	1730	
46	2312	
	2085	

**PK 11**  
**PKA 11**



	W
PK 11	546
PKA 11	496

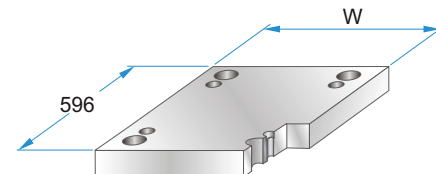

PK 11 - 446 x 596 x h /	PKA 11-446 x 596 x h /	material
36	1730	
46	2312	
	2085	

**PK 02**  
**PKA 02**

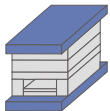

**PK 12**  
**PKA 12**

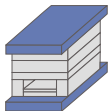

**PK 21**  
**PKA 21**

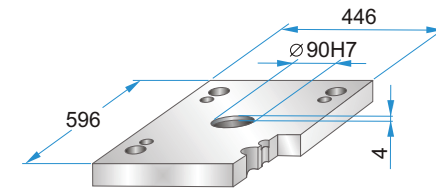

PK 21 - 446 x 596 x h /	PKA 21-446 x 596 x h /	material
27	1730	
36	2312	
46	2085	

**PK 22**  
**PKA 22**

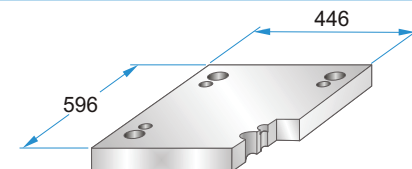

PK 22 - 446 x 596 x h /	PKA 22-446 x 596 x h /	material
27	1730	
36	2312	
46	2085	

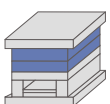

**PK 03**  
**PKA 03**

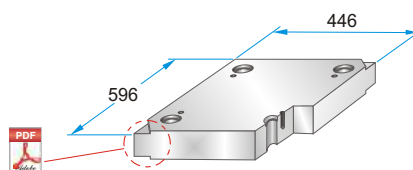

**PK 35**  
**PKA 35**

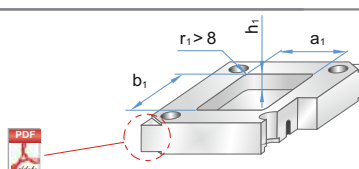

PK 03 - 446 x 596 x h /	PKA 03-446 x 596 x h /	material
27	1730	
36	2083	
46	2085	
56	2162	
66	2311	
76	2312	
86	2738	
96	Toolox33	
116	Toolox44	
136	2738HH	
156	2714HH	
176		

PK 35 - 446 x 596 x h /	PKA 35-446 x 596 x h /	material
	(a1/b1/h1/r1)	

Corner undercuts upon request.  
Podcięcia do demontażu na życzenie.  
Abhebeecken erhältlich.  
Доступно высвобождение на углах плит.

Material info



**PK 31**  
**PKA 31**

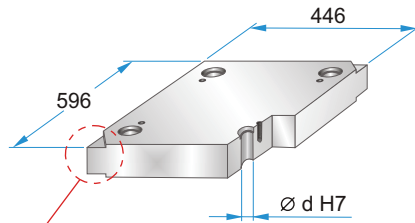
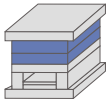

Corner undercuts upon request.  
Podcięcia do demontażu na życzenie.  
Abhebeecken erhältlich.  
Доступно высвобождение на углах плит.



	d
PK 31	41,3
PKA 31	41,4

PK 31 - 446 x 596 x h /  
PKA 31-446 x 596 x h / material

27	1730
36	2083
46	2085
56	2162
66	2311
76	2312
86	2343
96	2738
116	2767
136	Toolox33
156	Toolox44
176	2738HH
	2714HH

Material info

**PK 04**  
**PKA 04**

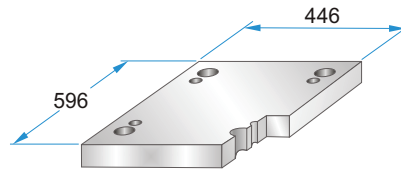
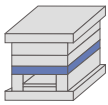

PK 04 - 446 x 596 x h /  
PKA 04-446 x 596 x h / material

36	1730
46	2312
56	2085
66	
76	
86	

**PK 05**  
**PKA 05**

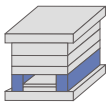

	A	B	M
PK 05	62	322	----
PKA 05	62	322	M10

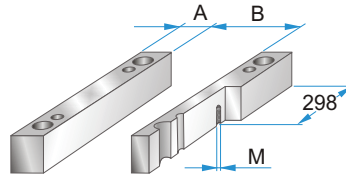

PK 05 - 446 x 596 x h /  
PKA 05-446 x 596 x h / material

66	1730
76	2085
86	
96	
116	
136	
156	

**PK 55**  
**PKA 55**

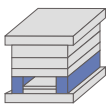

	A	B	M
PK 55	86	274	----
PKA 55	86	274	M10

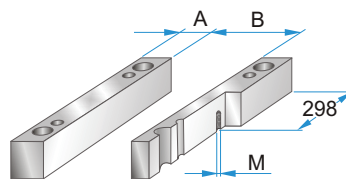

PK 55 - 446 x 596 x h /  
PKA 55-446 x 596 x h / material

66	1730
76	2085
86	
96	
116	
136	
156	

**PK 06**  
**PKA 06**

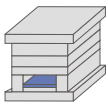

	A	B	C
PK 06	514	286	318
PKA 06	460	280	318

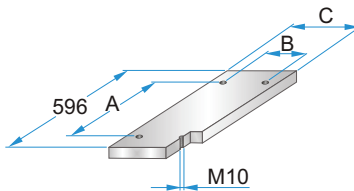

PK 06 - 446 x 596 x h /  
PKA 06-446 x 596 x h / material

22	1730
	2085

**PK 65**  
**PKA 65**

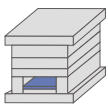

	A	B	C
PK 65	514	238	270
PKA 65	460	230	268

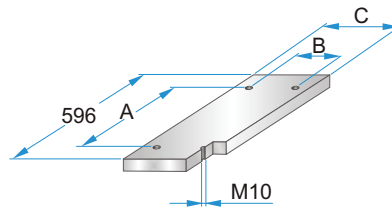

PK 65 - 446 x 596 x h /  
PKA 65-446 x 596 x h / material

22	1730
	2085

**PK 07**  
**PKA 07**

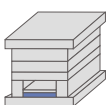

	A	B	C	D	M
PK 07	514	286	318	564	M4
PKA 07	460	280	318	558	M5

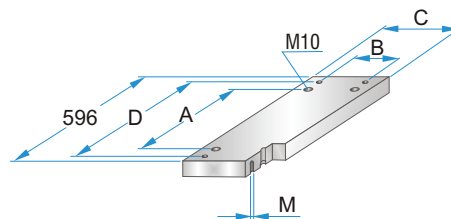

PK 07 - 446 x 596 x h /  
PKA 07-446 x 596 x h / material

27	1730
	2312
	2085

**PK 75**  
**PKA 75**

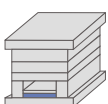

	A	B	C	D	M
PK 75	514	238	270	564	M4
PKA 75	460	230	268	558	M5

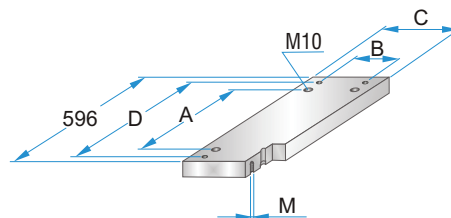

PK 75 - 446 x 596 x h /  
PKA 75-446 x 596 x h / material

27	1730
	2312
	2085