

Dimensions and tolerances
Wymiary i tolerancje
Abmessungen und Toleranzen
Размеры и допуски

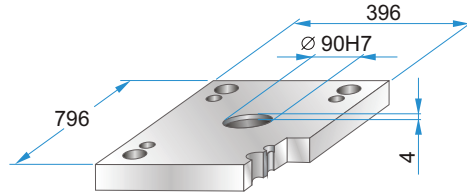

	A	B	C
PK	724	630	274
PKA	724	630	274

PKA 01



PKA 01-346 x 796 x h / material

36	1730
46	2312
	2085

PK 11 PKA 11



	W
PK 11	446
PKA 11	396

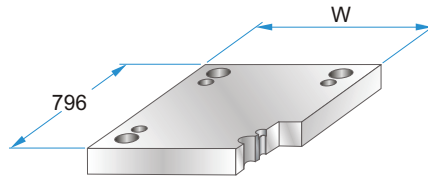

PK 11 - 346 x 796 x h /
PKA 11-346 x 796 x h / material

36	1730
46	2312
56	2085

PK 02 PKA 02

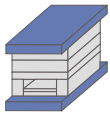

PK 12 PKA 12

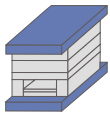

PKA 21

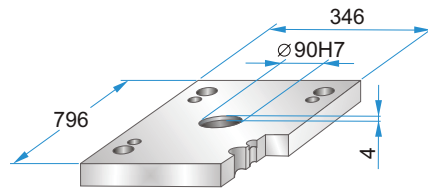
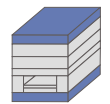

PKA 21-346 x 796 x h / material

46	1730
	2312
	2085

PK 22 PKA 22

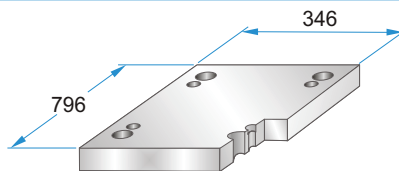
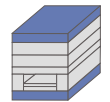

PK 22 - 346 x 796 x h /
PKA 22-346 x 796 x h / material

36	1730
46	2312
	2085

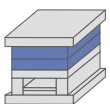

PK 03 PKA 03

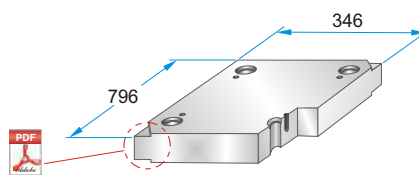

PK 35 PKA 35

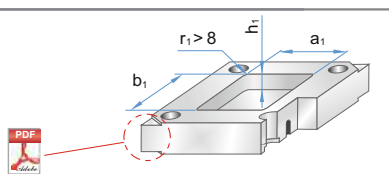

PK 03 - 346 x 796 x h /
PKA 03-346 x 796 x h / material

PK 35 - 346 x 796 x h /
PKA 35-346 x 796 x h / ($a_1/b_1/h_1/r_1$)

22	1730
27	2083
36	2085
46	2162
56	2311
66	2312
76	2738
86	Toolox33
96	Toolox44
116	2738HH
136	2714HH
156	
176	

Material info



Corner undercuts upon request.
Podcięcia do demontażu na życzenie.
Abhebeecken erhältlich.
Доступно высвобождение на углах плит.

PK 31

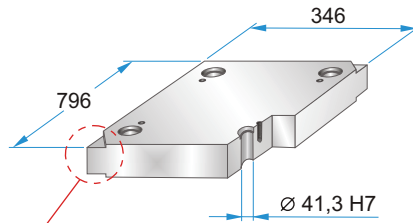
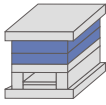

Corner undercuts upon request.
Podcięcia do demontażu na życzenie.
Abhebecken erhältlich.
Доступно высвобождение на углах плит.



PK 31 - 346 x 796 x h / material

27	1730
36	2083
46	2085
56	2162
66	2311
76	2312
86	2343
96	2738
116	2767
136	Toolox33
156	Toolox44
	2738HH
	2714HH

Material info

PK 04 PKA 04

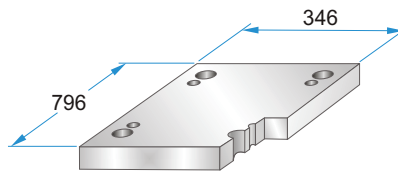
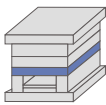

PK 04 - 346 x 796 x h / PKA 04-346 x 796 x h / material

36	1730
46	2312
56	2085
66	
76	

PK 05 PKA 05

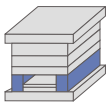

	A	B	M
PK 05	62	222	----
PKA 05	62	222	M10

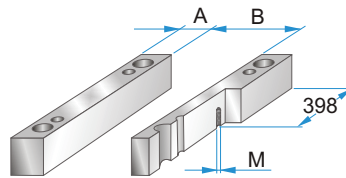

PK 05 - 346 x 796 x h / PKA 05-346 x 796 x h / material

56	1730
66	2085
76	
86	
96	
116	
136	
156	

PK 55

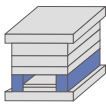

	A	B
PK 55	86	174

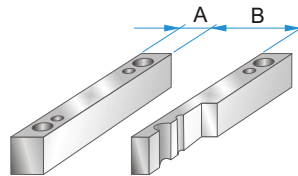

PK 55 - 346 x 796 x h / material

86	1730
96	2085
116	
136	
156	

PK 06 PKA 06

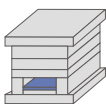

	A	B	C
PK 06	714	186	218
PKA 06	660	180	218

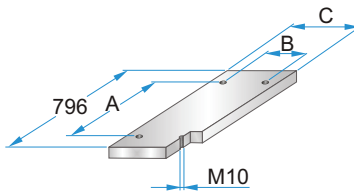

PK 06 - 346 x 796 x h / PKA 06-346 x 796 x h / material

22	1730
27	2085

PK 65

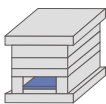

	A	B	C
PK 65	714	138	170

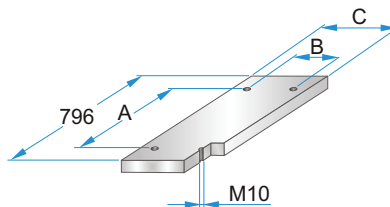

PK 65 - 346 x 796 x h / material

22	1730
	2085

PK 07 PKA 07

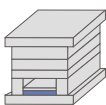

	A	B	C	D	M
PK 07	714	186	218	----	----
PKA 07	660	180	218	758	M5

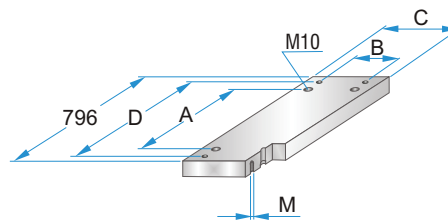

PK 07 - 346 x 796 x h / PKA 07-346 x 796 x h / material

27	1730
36	2312
	2085

PK 75

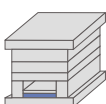

	A	B	C
PK 75	714	138	170

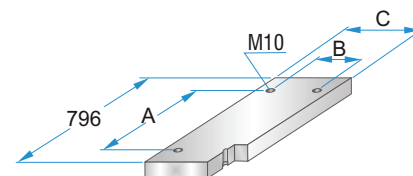

PK 75 - 346 x 796 x h / material

27	1730
	2312
	2085