

Dimensions and tolerances
Wymiary i tolerancje
Abmessungen und Toleranzen
Размеры и допуски

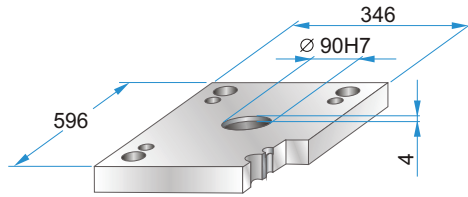

	A	B	C
PK	544	474	244
PKA	548	470	248

PK 01
PKA 01



PK 01 - 296 x 596 x h /	PKA 01-296 x 596 x h /	material
36		1730
46		2312
		2085

PK 11
PKA 11

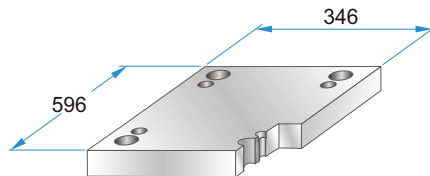

PK 11 - 296 x 596 x h /	PKA 11-296 x 596 x h /	material
36		1730
46		2312
		2085

PK 02
PKA 02

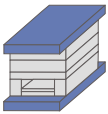

PK 12
PKA 12

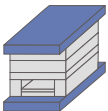

PK 21
PKA 21

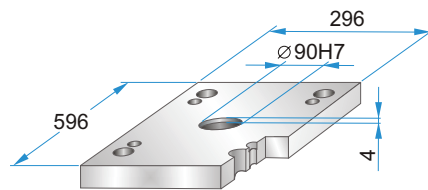
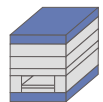

PK 21 - 296 x 596 x h /	PKA 21-296 x 596 x h /	material
27		1730
36		2312
		2085

PK 22
PKA 22

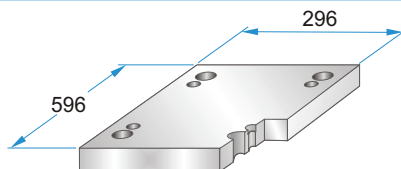
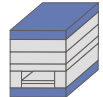

PK 22 - 296 x 596 x h /	PKA 22-296 x 596 x h /	material
27		1730
36		2312
		2085

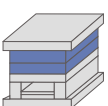

PK 03
PKA 03

PK 35
PKA 35

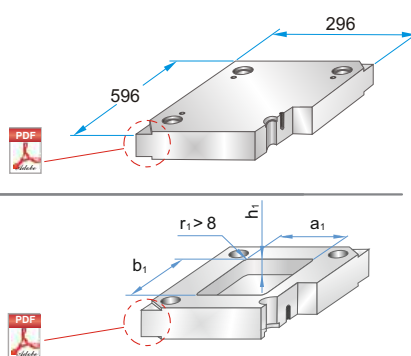

PK 03 - 296 x 596 x h /	PKA 03-296 x 596 x h /	material
22		1730
27		2083
36		2085
46		2162
56		2311
66		2312
76		2738
86		Toolox33
96		Toolox44
116		2738HH
136		2714HH
156		

Material info



Corner undercuts upon request.
Podcięcia do demontażu na życzenie.
Abhebeecken erhältlich.
Доступно высвобождение на углах плит.

PK 31
PKA 31

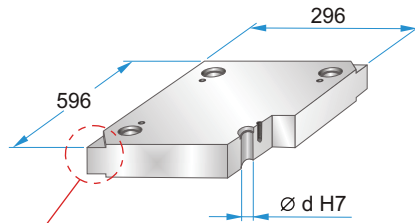
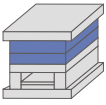

Corner undercuts upon request.
Podcięcia do demontażu na życzenie.
Abhebecken erhältlich.
Доступно высвобождение на углах плит.



	d
PK 31	29,4
PKA 31	29,5

PK 31 - 296 x 596 x h /
PKA 31-296 x 596 x h / material

27	1730
36	2083
46	2085
56	2162
66	2311
76	2312
86	2343
96	2738
116	2767
136	Toolox33
	Toolox44
	2738HH
	2714HH

Material info

PK 04
PKA 04

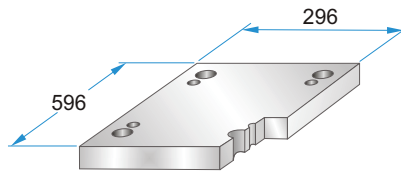
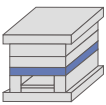

PK 04 - 296 x 596 x h /
PKA 04-296 x 596 x h / material

36	1730
46	2312
56	2085

PK 05
PKA 05



	A	B	M
PK 05	43	210	----
PKA 05	44	208	M10

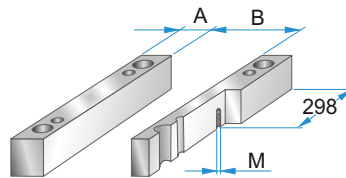

PK 05 - 296 x 596 x h /
PKA 05-296 x 596 x h / material

56	1730
66	2085
76	
86	
96	
116	
136	

PK 55
PKA 55

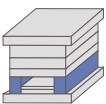

	A	B	M
PK 55	58	180	----
PKA 55	60	176	M10

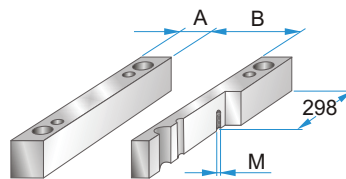

PK 55 - 296 x 596 x h /
PKA 55-296 x 596 x h / material

56	1730
66	2085
76	
86	
96	
116	
136	

PK 06
PKA 06



	A	B	C
PK 06	518	180	208
PKA 06	500	180	206

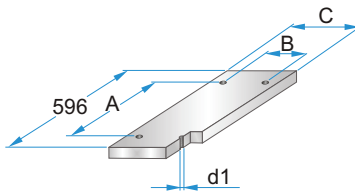

PK 06 - 296 x 596 x h /
PKA 06-296 x 596 x h / material

	d1
PK 06	M10
PKA 06	M8

22	1730
	2085

PK 65
PKA 65

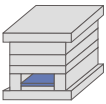

	A	B	C
PK 65	518	148	176
PKA 65	500	146	172

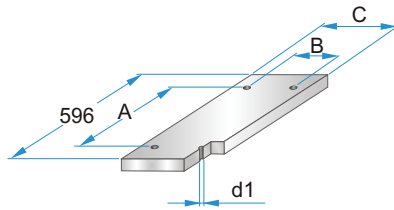

PK 65 - 296 x 596 x h /
PKA 65-296 x 596 x h / material

	d1
PK 65	M10
PKA 65	M8

22	1730
	2085

PK 07
PKA 07

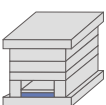

	A	B	C	D	M
PK 07	518	180	208	564	M4
PKA 07	500	180	206	570	M5

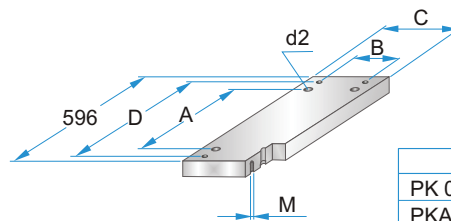

PK 07 - 296 x 596 x h /
PKA 07-296 x 596 x h / material

	d2
PK 07	M10
PKA 07	M8

27	1730
	2312
	2085

PK 75
PKA 75

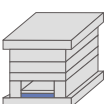

	A	B	C	D	M
PK 75	518	148	176	564	M4
PKA 75	500	146	172	570	M5

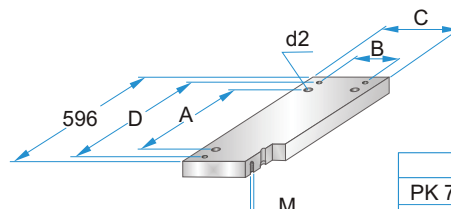

PK 75 - 296 x 596 x h /
PKA 75-296 x 596 x h / material

	d2
PK 75	M10
PKA 75	M8

27	1730
	2312
	2085