

Dimensions and tolerances  
Wymiary i tolerancje  
Abmessungen und Toleranzen  
Размеры и допуски

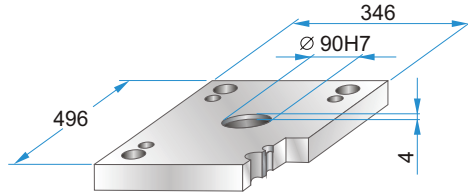

	A	B	C
<b>PK</b>	444	374	244
<b>PKA</b>	448	370	248

**PK 01**  
**PKA 01**



PK 01 - 296 x 496 x h /	material
PKA 01-296 x 496 x h /	
27	1730
36	2312
	2085

**PK 11**  
**PKA 11**

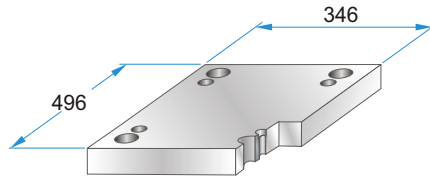
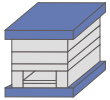

PK 11 - 296 x 496 x h /	material
PKA 11-296 x 496 x h /	
27	1730
36	2312
	2085

**PKA 02**

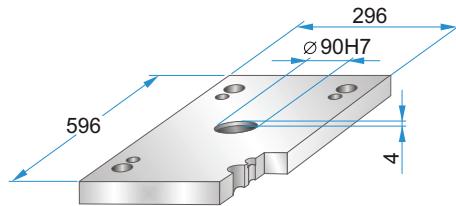
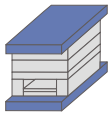

PKA 02-296 x 496 x h /	material
27	1730
	2312
	2085

**PKA 12**

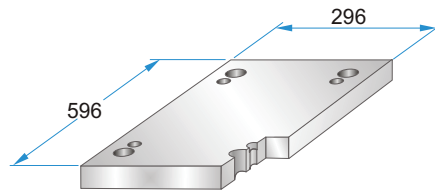
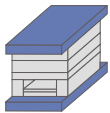

PKA 12-296 x 496 x h /	material
27	1730
	2312
	2085

**PK 21**  
**PKA 21**

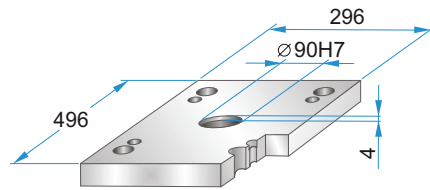

PK 21 - 296 x 496 x h /	material
PKA 21-296 x 496 x h /	
27	1730
36	2312
	2085

**PK 22**  
**PKA 22**

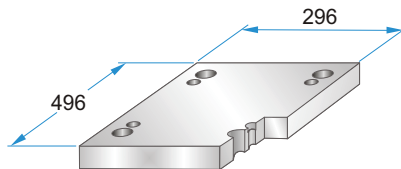
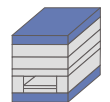

PK 22 - 296 x 496 x h /	material
PKA 22-296 x 496 x h /	
27	1730
36	2312
	2085

**PK 03**  
**PKA 03**

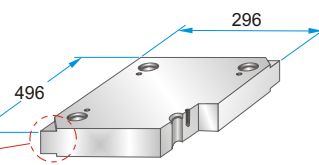
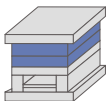

**PK 35**  
**PKA 35**

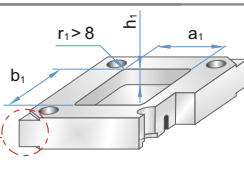

PK 03 - 296 x 496 x h /	material
PKA 03-296 x 496 x h /	
PK 35 - 296 x 496 x h /	material
PKA 35-296 x 496 x h /	(a1/b1/h1/r1)

22	1730
27	2083
36	2085
46	2162
56	2311
66	2312
76	2738
86	Toolox33
96	Toolox44
116	2738HH
136	2714HH
156	

Corner undercuts upon request.  
Podcięcia do demontażu na życzenie.  
Abhebeecken erhältlich.  
Доступно высвобождение на углах плит.

Material info



**PK 31**  
**PKA 31**

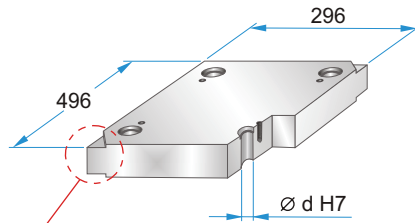
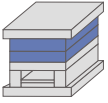

Corner undercuts upon request.  
Podcięcia do demontażu na życzenie.  
Abhebecken erhältlich.  
Доступно высвобождение на углах плит.



	d
PK 31	29,4
PKA 31	29,5

PK 31 - 296 x 496 x h /  
PKA 31-296 x 496 x h / material

27	1730
36	2083
46	2085
56	2162
66	2311
76	2312
86	2343
96	2738
116	2767
136	Toolox33
	Toolox44
	2738HH
	2714HH

Material info

**PK 04**  
**PKA 04**

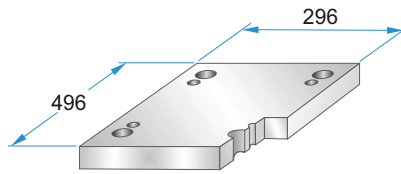
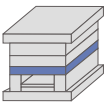

PK 04 - 296 x 496 x h /  
PKA 04-296 x 496 x h / material

36	1730
46	2312
56	2085
66	
76	

**PK 05**  
**PKA 05**

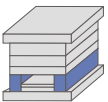

	A	B	M
PK 05	43	210	----
PKA 05	44	208	M10

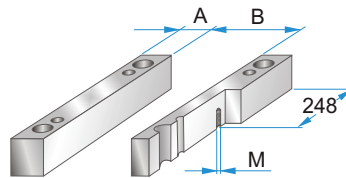

PK 05 - 296 x 496 x h /  
PKA 05-296 x 496 x h / material

56	1730
66	2085
76	
86	
96	
116	

**PK 55**  
**PKA 55**

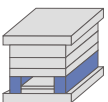

	A	B	M
PK 55	58	180	----
PKA 55	60	176	M10

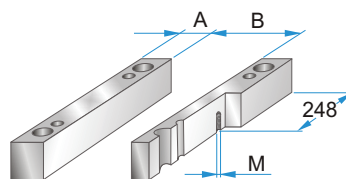

PK 55 - 296 x 496 x h /  
PKA 55-296 x 496 x h / material

56	1730
66	2085
76	
86	
96	
116	

**PK 06**  
**PKA 06**



	A	B	C
PK 06	418	180	208
PKA 06	400	180	206

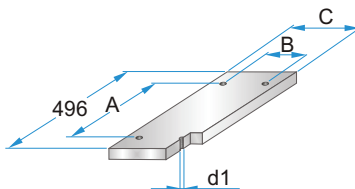

PK 06 - 296 x 496 x h /  
PKA 06-296 x 496 x h / material

	d1
PK 06	M10
PKA 06	M8

17	1730
	2085

**PK 65**  
**PKA 65**



	A	B	C
PK 65	418	148	176
PKA 65	400	146	172

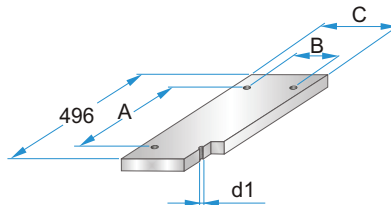

PK 65 - 296 x 496 x h /  
PKA 65-296 x 496 x h / material

	d1
PK 65	M10
PKA 65	M8

17	1730
	2085

**PK 07**  
**PKA 07**

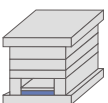

	A	B	C	D	M
PK 07	418	180	208	464	M4
PKA 07	400	180	206	470	M5

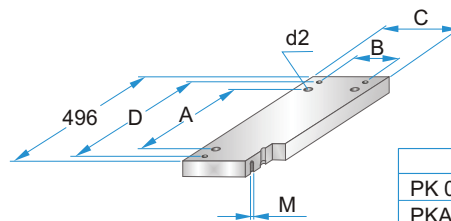

PK 07 - 296 x 496 x h /  
PKA 07-296 x 496 x h / material

	d2
PK 07	M10
PKA 07	M8

22	1730
	2312
	2085

**PK 75**  
**PKA 75**

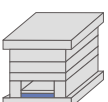

	A	B	C	D	M
PK 75	418	148	176	464	M4
PKA 75	400	146	172	470	M5

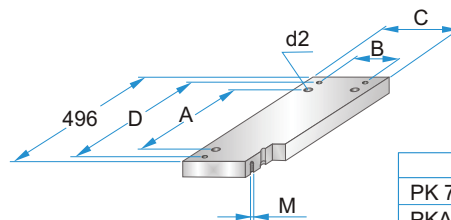

PK 75 - 296 x 496 x h /  
PKA 75-296 x 496 x h / material

	d2
PK 75	M10
PKA 75	M8

22	1730
	2312
	2085