

Dimensions and tolerances  
Wymiary i tolerancje  
Abmessungen und Toleranzen  
Размеры и допуски

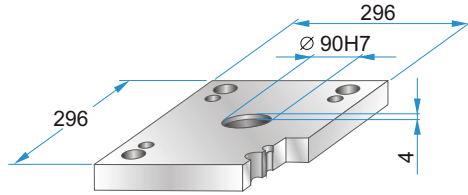

	A	B	C
<b>PK</b>	244	186	200
<b>PKA</b>	248	170	198

**PK 01**  
**PKA 01**



PK 01 - 246 x 296 x h /	material
PKA 01-246 x 296 x h /	
27	1730
36	2312
46	2085

**PK 11**  
**PKA 11**

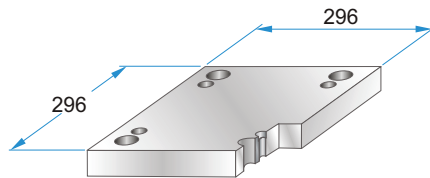

PK 11 - 246 x 296 x h /	material
PKA 11-246 x 296 x h /	
27	1730
36	2312
46	2085

**PK 02**  
**PKA 02**

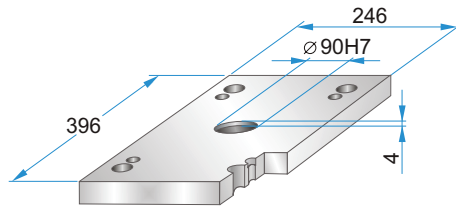
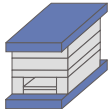

PK 02 - 246 x 296 x h /	material
PKA 02-246 x 296 x h /	
27	1730
36	2312
	2085

**PK 12**  
**PKA 12**

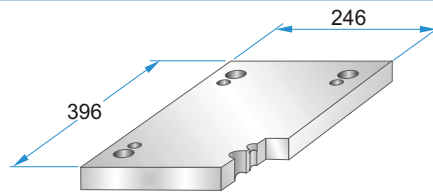
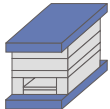

PK 12 - 246 x 296 x h /	material
PKA 12-246 x 296 x h /	
27	1730
36	2312
	2085

**PK 21**  
**PKA 21**

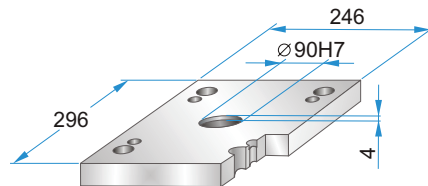

PK 21 - 246 x 296 x h /	material
PKA 21-246 x 296 x h /	
22	1730
27	2312
36	2085

**PK 22**  
**PKA 22**

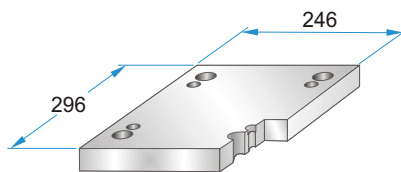
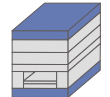

PK 22 - 246 x 296 x h /	material
PKA 22-246 x 296 x h /	
17	1730
22	2312
27	2085
36	

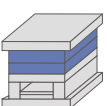

**PK 03**  
**PKA 03**

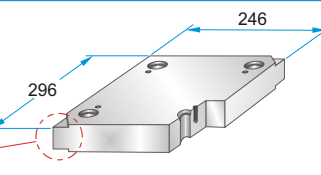

**PK 35**  
**PKA 35**

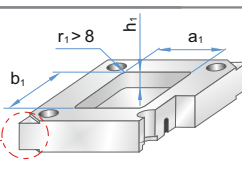

PK 03 - 246 x 296 x h /	material
PKA 03-246 x 296 x h /	
PK 35 - 246 x 296 x h /	material
PKA 35-246 x 296 x h /	(a1/b1/h1/r1)
17	1730
22	2083
27	2085
36	2162
46	2311
56	2312
66	2738
76	Toolox33
86	Toolox44
96	2738HH
116	2714HH
136	

Material info



Corner undercuts upon request.  
Podcięcia do demontażu na życzenie.  
Abhebeecken erhältlich.  
Доступно высвобождение на углах плит.

**PK 31**  
**PKA 31**

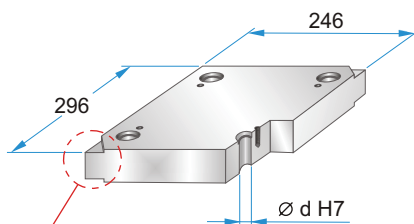
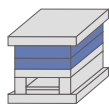

Corner undercuts upon request.  
Podcięcia do demontażu na życzenie.  
Abhebeecken erhältlich.  
Доступно высвобождение на углах плит.



	d
PK 31	29,4
PKA 31	29,5

PK 31 - 246 x 296 x h /  
PKA 31-246 x 296 x h / material

17	1730
22	2083
27	2085
36	2162
46	2311
56	2312
66	2343
76	2738
86	2767
96	Toolox33
116	Toolox44
	2738HH
	2714HH

Material info

**PK 04**  
**PKA 04**

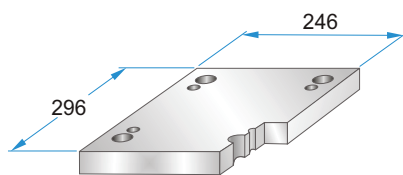
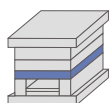

PK 04 - 246 x 296 x h /  
PKA 04-246 x 296 x h / material

22	1730
27	2312
36	2085
46	
56	
66	

**PK 05**  
**PKA 05**

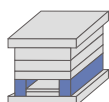

	A	B	M
PK 05	43	160	----
PKA 05	44	158	M10

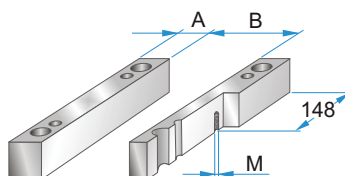

PK 05 - 246 x 296 x h /  
PKA 05-246 x 296 x h / material

56	1730
66	2085
76	
86	
96	
116	

**PK 55**  
**PKA 55**

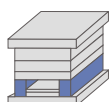

	A	B	M
PK 55	58	130	----
PKA 55	60	126	M10

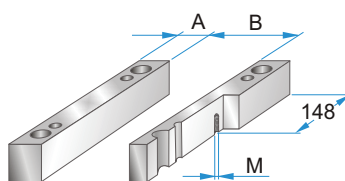

PK 55 - 246 x 296 x h /  
PKA 55-246 x 296 x h / material

56	1730
66	2085
76	
86	
96	
116	

**PK 06**  
**PKA 06**

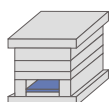

	A	B	C
PK 06	230	130	158
PKA 06	200	130	156

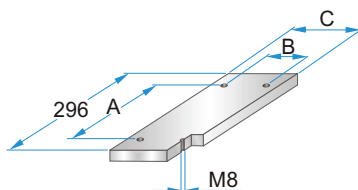

PK 06 - 246 x 296 x h /  
PKA 06-246 x 296 x h / material

12	1730
	2085

**PK 65**  
**PKA 65**

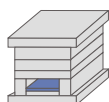

	A	B	C
PK 65	230	98	126
PKA 65	200	96	122

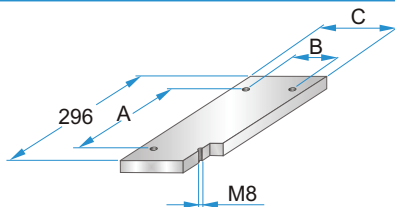

PK 65 - 246 x 296 x h /  
PKA 65-246 x 296 x h / material

12	1730
	2085

**PK 07**  
**PKA 07**

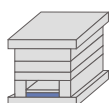

	A	B	C	D	M
PK 07	230	130	158	264	M4
PKA 07	200	130	156	270	M5

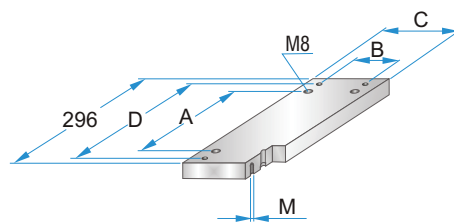

PK 07 - 246 x 296 x h /  
PKA 07-246 x 296 x h / material

17	1730
22	2312
	2085

**PK 75**  
**PKA 75**

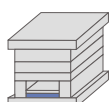

	A	B	C	D	M
PK 75	230	98	126	264	M4
PKA 75	200	96	122	270	M5

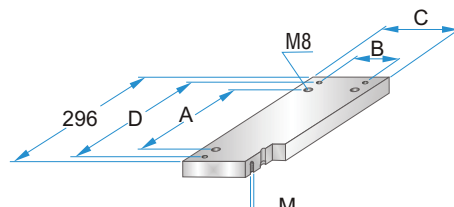

PK 75 - 246 x 296 x h /  
PKA 75-246 x 296 x h / material

17	1730
22	2312
	2085