

Dimensions and tolerances  
Wymiary i tolerancje  
Abmessungen und Toleranzen  
Размеры и допуски

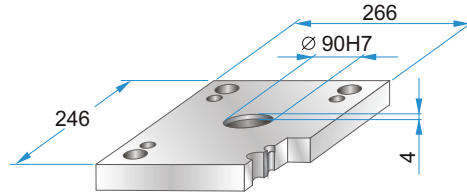

	A	B	C
<b>PKA</b>	206	136	176

## PKA 01



PKA 01-216 x 246 x h / material

22	1730
27	2312
36	2085

## PKA 11

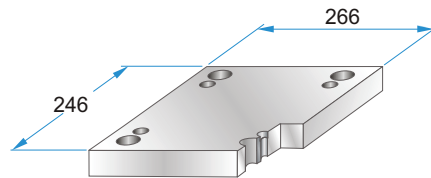

PKA 11-216 x 246 x h / material

22	1730
27	2312
36	2085

## PKA 02

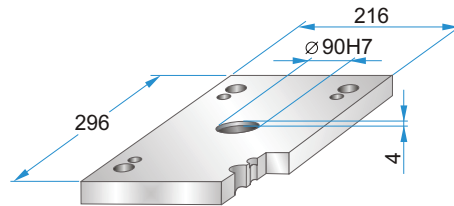
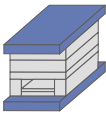

PKA 02-216 x 246 x h / material

22	1730
27	2312
36	2085

## PKA 12

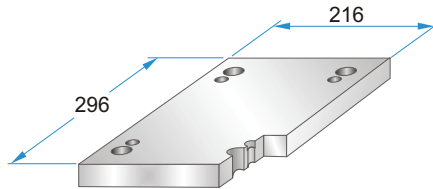
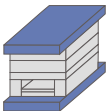

PKA 12-216 x 246 x h / material

22	1730
27	2312
36	2085

## PKA 21

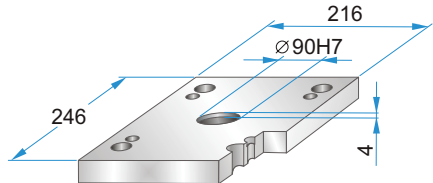

PKA 21-216 x 246 x h / material

22	1730
27	2312
	2085

## PKA 22

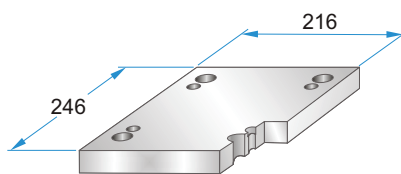
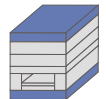

PKA 22-216 x 246 x h / material

22	1730
27	2312
	2085

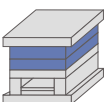

## PKA 03

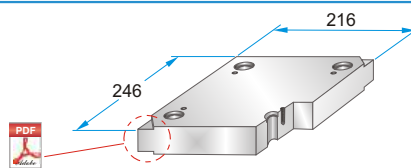

## PKA 35

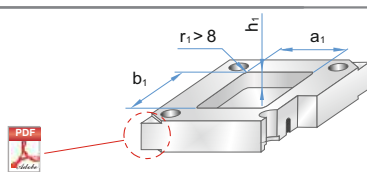

PKA 03-216 x 246 x h / material

PKA 35-216 x 246 x h / material  
(a1/b1/h1/r1)

17	1730
22	2083
27	2085
36	2162
46	2311
56	2312
66	2738
76	Toolox33
86	Toolox44
96	2738HH
116	2714HH

Material info



Corner undercuts upon request.  
Podcięcia do demontażu na życzenie.  
Abhebecken erhältlich.  
Доступно высвобождение на углах плит.

## PKA 31

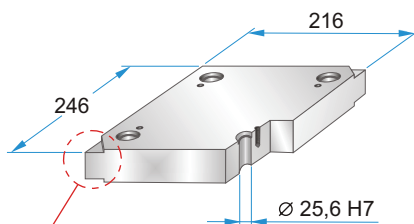
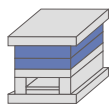

Corner undercuts upon request.  
Podcięcia do demontażu na życzenie.  
Abhebecken erhältlich.  
Доступно высвобождение на углах плит.



### PKA 31-216 x 246 x h / material

17	1730
22	2083
27	2085
36	2162
46	2311
56	2312
66	2343
76	2738
86	2767
96	Toolox33
	Toolox44
	2738HH
	2714HH

Material info

## PKA 04

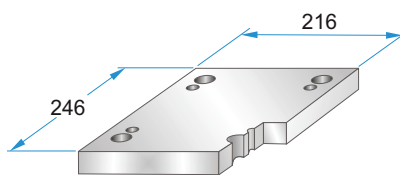
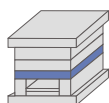

### PKA 04-216 x 246 x h / material

22	1730
27	2312
36	2085
46	
56	
66	

## PKA 05

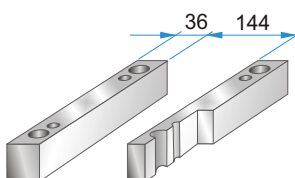
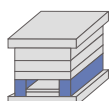

### PKA 05-216 x 246 x h / material

46	1730
56	2085
66	
76	
86	
96	

## PKA 55

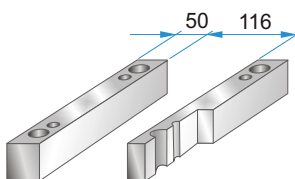
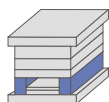

### PKA 55-216 x 246 x h / material

46	1730
56	2085
66	
76	
86	
96	

## PKA 06

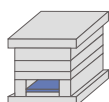

	A	B
PKA 06	170	116

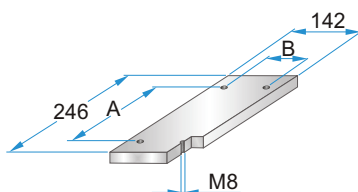

### PKA 06-216 x 246 x h / material

12	1730
	2085

## PKA 65

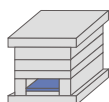

	A	B
PKA 65	170	88

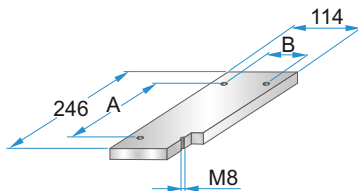

### PKA 65-216 x 246 x h / material

12	1730
	2085

## PKA 07

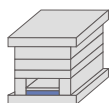

	A	B	D
PKA 07	170	116	220

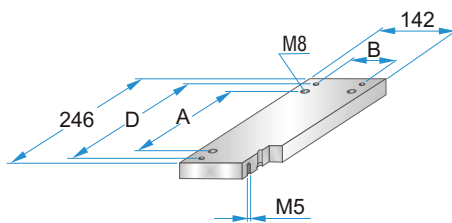

### PKA 07-216 x 246 x h / material

17	1730
	2312
	2085

## PKA 75

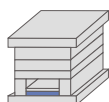

	A	B	D
PKA 75	170	88	220

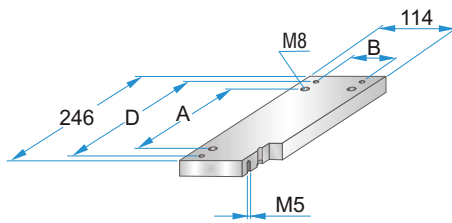

### PKA 75-216 x 246 x h / material

17	1730
	2312
	2085