

Dimensions and tolerances  
Wymiary i tolerancje  
Abmessungen und Toleranzen  
Размеры и допуски

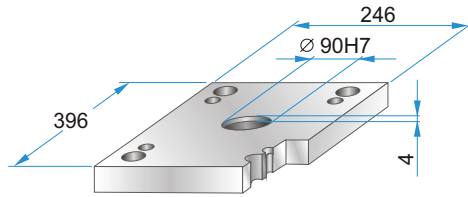

	A	B	C
<b>PK</b>	344	274	144
<b>PKA</b>	348	270	148

**PK 01**  
**PKA 01**



PK 01 - 196 x 396 x h /	material
PKA 01-196 x 396 x h /	
27	1730
36	2312
	2085

**PK 11**  
**PKA 11**

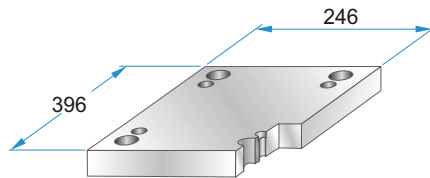

PK 11 - 196 x 396 x h /	material
PKA 11-196 x 396 x h /	
27	1730
36	2312
	2085

**PK 02**  
**PKA 02**

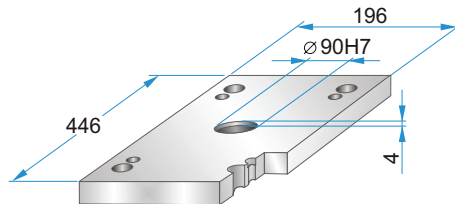
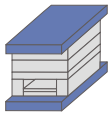

PK 02 - 196 x 396 x h /	material
PKA 02-196 x 396 x h /	
27	1730
36	2312
	2085

**PK 12**  
**PKA 12**

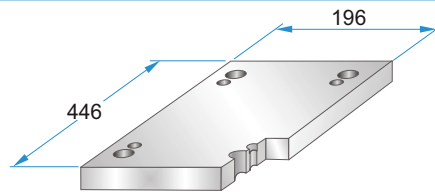
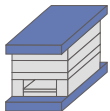

PK 12 - 196 x 396 x h /	material
PKA 12-196 x 396 x h /	
27	1730
36	2312
	2085

**PK 21**  
**PKA 21**

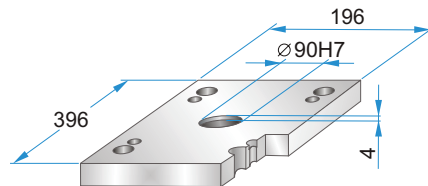

PK 21 - 196 x 396 x h /	material
PKA 21-196 x 396 x h /	
27	1730
	2312
	2085

**PK 22**  
**PKA 22**

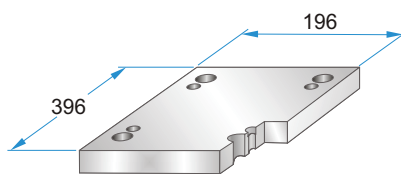
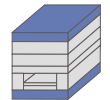

PK 22 - 196 x 396 x h /	material
PKA 22-196 x 396 x h /	
27	1730
	2312
	2085

**PK 03**  
**PKA 03**

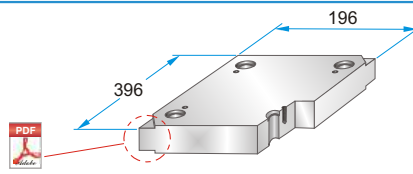
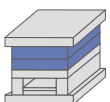

**PK 35**  
**PKA 35**

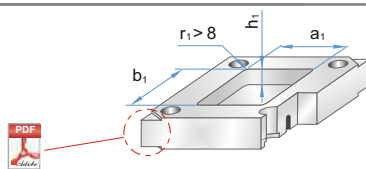

PK 03 - 196 x 396 x h /	material
PKA 03-196 x 396 x h /	
PK 35 - 196 x 396 x h /	material
PKA 35-196 x 396 x h /	(a1/b1/h1/r1)
22	1730
27	2083
36	2085
46	2162
56	2311
66	2312
76	2738
86	Toolox33
96	Toolox44
116	2738HH
	2714HH

Corner undercuts upon request.  
Podcięcia do demontażu na życzenie.  
Abhebecken erhältlich.  
Доступно высвобождение на углах плит.

Material info



**PK 31**  
**PKA 31**

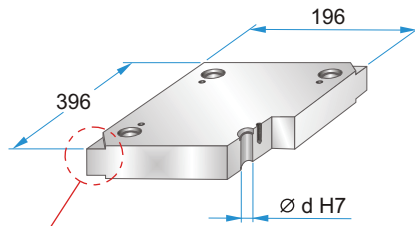
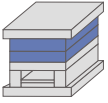

Corner undercuts upon request.  
Podcięcia do demontażu na życzenie.  
Abhebeecken erhältlich.  
Доступно высвобождение на углах плит.



	d
PK 31	29,4
PKA 31	29,5

PK 31 - 196 x 396 x h /  
PKA 31-196 x 396 x h / material

22	1730
27	2083
36	2085
46	2162
56	2311
66	2312
76	2343
86	2738
96	2767
	Toolox33
	Toolox44
	2738HH
	2714HH

Material info

**PK 04**  
**PKA 04**

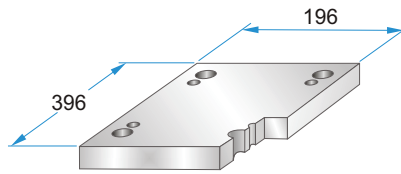
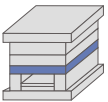

PK 04 - 196 x 396 x h /  
PKA 04-196 x 396 x h / material

27	1730
36	2312
46	2085
56	

**PK 05**  
**PKA 05**



	A	B	M
PK 05	43	110	----
PKA 05	44	108	M10

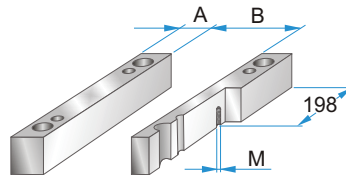

PK 05 - 196 x 396 x h /  
PKA 05-196 x 396 x h / material

56	1730
66	2085
76	
86	
96	
116	

**PK 55**  
**PKA 55**



	A	B	M
PK 55	58	80	----
PKA 55	60	76	M10

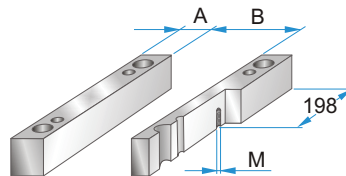

PK 55 - 196 x 396 x h /  
PKA 55-196 x 396 x h / material

56	1730
66	2085
76	
86	
96	
116	

**PK 06**  
**PKA 06**



	A	B	C
PK 06	330	90	108
PKA 06	300	80	106

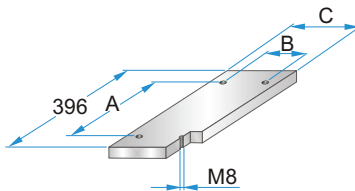

PK 06 - 196 x 396 x h /  
PKA 06-196 x 396 x h / material

17	1730
	2085

**PK 65**  
**PKA 65**



	A	B	C
PK 65	330	58	76
PKA 65	300	48	74

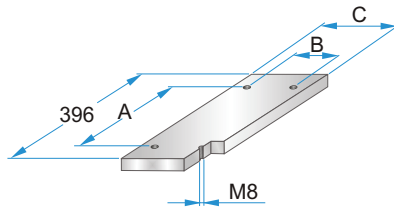

PK 65 - 196 x 396 x h /  
PKA 65-196 x 396 x h / material

17	1730
	2085

**PK 07**  
**PKA 07**

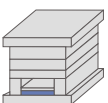

	A	B	C	D	M
PK 07	330	90	108	364	M4
PKA 07	300	80	106	370	M5

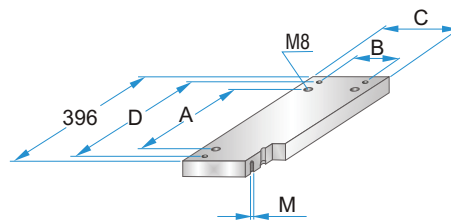

PK 07 - 196 x 396 x h /  
PKA 07-196 x 396 x h / material

22	1730
	2312
	2085

**PK 75**  
**PKA 75**

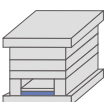

	A	B	C	D	M
PK 75	330	58	76	364	M4
PKA 75	300	48	74	370	M5

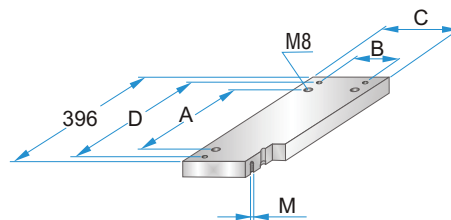

PK 75 - 196 x 396 x h /  
PKA 75-196 x 396 x h / material

22	1730
	2312
	2085