

Dimensions and tolerances  
Wymiary i tolerancje  
Abmessungen und Toleranzen  
Размеры и допуски

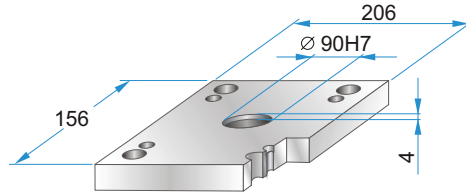

	A	B	C
<b>PK</b>	122	72	122
<b>PKA</b>	124	60	124

**PK 01**  
**PKA 01**



PK 01 - 156 x 156 x h /	material
PKA 01-156 x 156 x h /	
17	1730
22	2312
27	2085

**PK 11**  
**PKA 11**

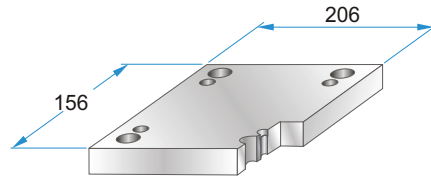
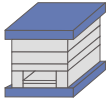

PK 11 - 156 x 156 x h /	material
PKA 11-156 x 156 x h /	
17	1730
22	2312
27	2085

**PK 02**  
**PKA 02**

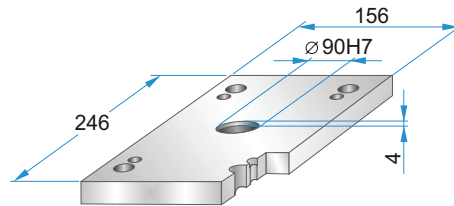
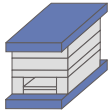

PK 02 - 156 x 156 x h /	material
PKA 02-156 x 156 x h /	
22	1730
27	2312
	2085

**PK 12**  
**PKA 12**

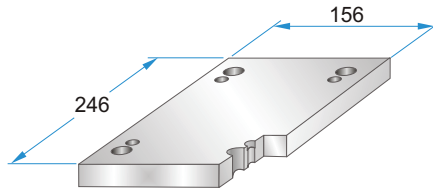
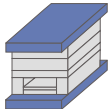

PK 12 - 156 x 156 x h /	material
PKA 12-156 x 156 x h /	
22	1730
27	2312
	2085

**PK 21**  
**PKA 21**

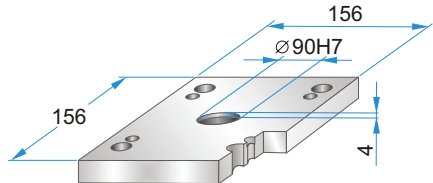

PK 21 - 156 x 156 x h /	material
PKA 21-156 x 156 x h /	
17	1730
22	2312
27	2085

**PK 22**  
**PKA 22**

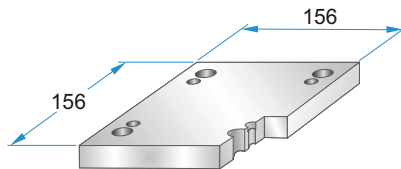
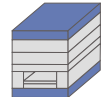

PK 22 - 156 x 156 x h /	material
PKA 22-156 x 156 x h /	
17	1730
22	2312
27	2085

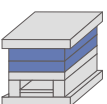

**PK 03**  
**PKA 03**

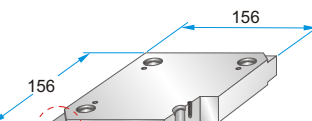

**PK 35**  
**PKA 35**

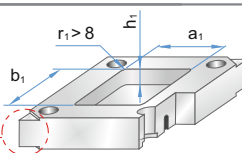

PK 03 - 156 x 156 x h /	material
PKA 03-156 x 156 x h /	
PK 35 - 156 x 156 x h /	material
PKA 35-156 x 156 x h /	( $a_1/b_1/h_1/r_1$ )
17	1730
22	2083
27	2085
36	2162
46	2311
56	2312
66	2738
76	Toolox33
86	Toolox44
96	2738HH
	2714HH

Corner undercuts upon request.  
Podcięcia do demontażu na życzenie.  
Abhebeecken erhältlich.  
Доступно высвобождение на углах плит.

Material info



**PK 31**  
**PKA 31**

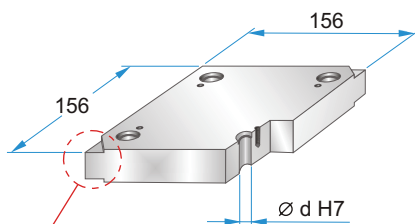
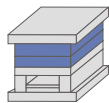

Corner undercuts upon request.  
Podcięcia do demontażu na życzenie.  
Abhebeecken erhältlich.  
Доступно высвобождение на углах плит.



	d
PK 31	19,6
PKA 31	19,7

PK 31 - 156 x 156 x h / material  
PKA 31-156 x 156 x h / material

17	1730
22	2083
27	2085
36	2162
46	2311
56	2312
66	2343
76	2738
86	2767
	Toolox33
	Toolox44
	2738HH
	2714HH

Material info

**PK 04**  
**PKA 04**

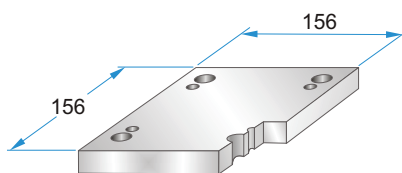
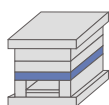

PK 04 - 156 x 156 x h / material  
PKA 04-156 x 156 x h / material

17	1730
22	2312
27	2085
36	
46	
56	
66	

**PK 05**  
**PKA 05**

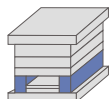

	A	B
PK 05	32	92
PKA 05	29	98

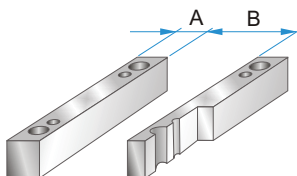

PK 05 - 156 x 156 x h / material  
PKA 05-156 x 156 x h / material

36	1730
46	2085
56	
66	
76	
86	
96	

**PK 55**  
**PKA 55**

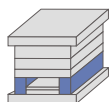

**PK 06**  
**PKA 06**

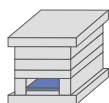

	A	B	C
PK 06	100	68	90
PKA 06	80	70	96

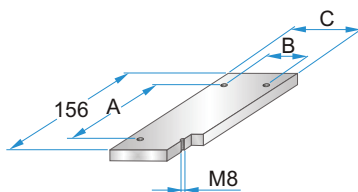

PK 06 - 156 x 156 x h / material  
PKA 06-156 x 156 x h / material

9	1730
	2085

**PK 65**  
**PKA 65**

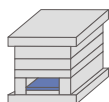

**PK 07**  
**PKA 07**

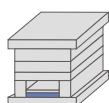

	A	B	C	D	M
PK 07	100	68	90	136	M4
PKA 07	80	70	96	130	M5

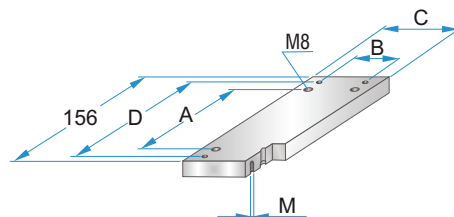

PK 07 - 156 x 156 x h / material  
PKA 07-156 x 156 x h / material

17	1730
	2312
	2085

**PK 75**  
**PKA 75**

