

Dimensions and tolerances  
Wymiary i tolerancje  
Abmessungen und Toleranzen  
Размеры и допуски

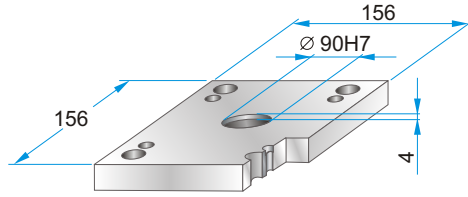

	A	B	C
<b>PKA</b>	124	60	94

## PKA 01



PKA 01-126 x 156 x h / material

22	1730
27	2312
	2085

## PKA 11

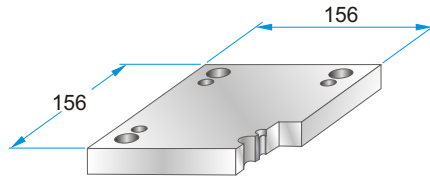

PKA 11-126 x 156 x h / material

22	1730
27	2312
	2085

## PKA 02

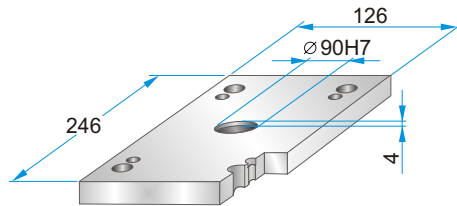
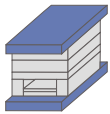

PKA 02-126 x 156 x h / material

22	1730
27	2312
	2085

## PKA 12

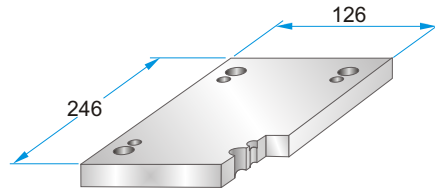
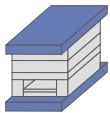

PKA 12-126 x 156 x h / material

22	1730
27	2312
	2085

## PKA 21

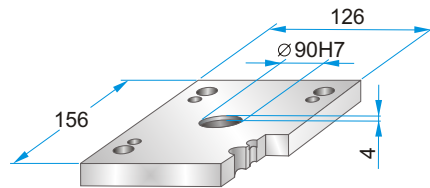

PKA 21-126 x 156 x h / material

22	1730
27	2312
	2085

## PKA 22

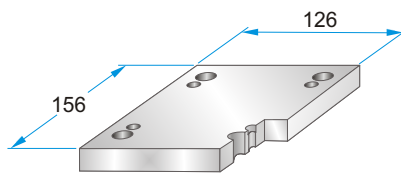

PKA 22-126 x 156 x h / material

22	1730
27	2312
	2085

## PKA 03

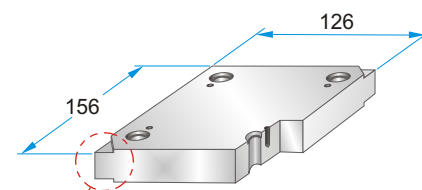
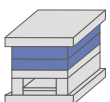

PKA 03-126 x 156 x h / material

17	1730
22	2083
27	2085
36	2162
46	2311
56	2312
66	2738

Corner undercuts upon request.  
Podcięcia do demontażu na życzenie.  
Abhebeecken erhältlich.  
Доступно высвобождение на углах плит.



Material info



Toolox33  
Toolox44  
2738HH  
2714HH

## PKA 31

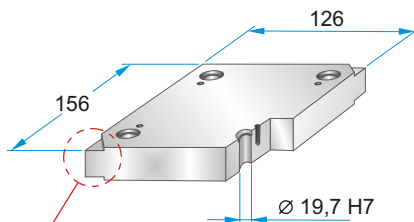
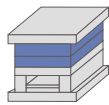

Corner undercuts upon request.  
Podcięcia do demontażu na życzenie.  
Abhebeecken erhältlich.  
Доступно высвобождение на углах плит.



### PKA 31-126 x 156 x h / material

17	1730
22	2083
27	2085
36	2162
46	2311
56	2312
66	2343
	2738
	2767
	Toolox33
	Toolox44
	2738HH
	2714HH

Material info

## PKA 04

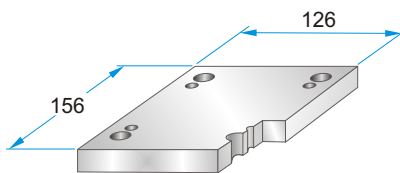
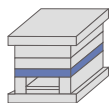

### PKA 04-126 x 156 x h / material

17	1730
22	2312
27	2085
36	

## PKA 05

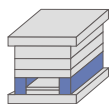

	A	B
PKA 05	29	68

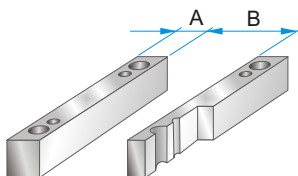

### PKA 05-126 x 156 x h / material

36	1730
46	2085
56	
66	
76	
86	
96	

## PKA 55

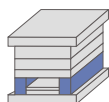

## PKA 06

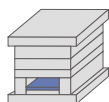

	A	B	C
PKA 06	80	40	66

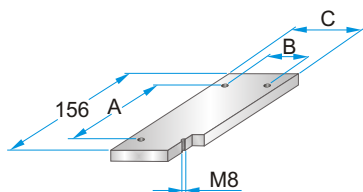

### PKA 06-126 x 156 x h / material

9	1730
	2085

## PKA 65

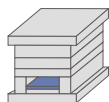

## PKA 07

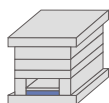

	A	B	C	D
PKA 07	80	40	66	130

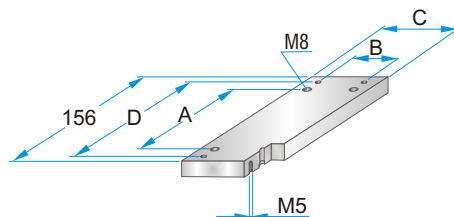

### PKA 07-126 x 156 x h / material

17	1730
	2312
	2085

## PKA 75

